



SUFIRE

# KINGPIN M2

Mechanical Multimedia RGB Gaming Keyboard

QWERTZ German

QWERTY US English

QWERTY Nordic

QWERTY Spanish

QWERTY Italian

AZERTY French

QUICK START GUIDE

## Safety Warnings

---

- Read all the instructions carefully before using the unit and keep them for future reference.
- Retain the manual. If you pass the unit onto a third party, make sure to include this manual.
- Do not disassemble the keyboard or remove any parts.
- Do not immerse the keyboard in water or any liquid.
- Do not use the keyboard close to heat sources or expose to high temperatures.
- Do not use the keyboard where strong electromagnetic waves are present.  
Strong electromagnetic waves will cause damage to the keyboard.
- Keep the keyboard away from direct sunlight, moisture, dirt or abrasive chemical products (cleaning products etc).

## How it works

---

### 105 Keys (DE/NOR/ES/IT/FR)



### 104 Keys (US)















### How to connect:

Connect the USB Cable to the USB Port of your device.

### Backlight Effect:

To access these functions, press the Fn Key and the required key together:

- |  |    |   |  |
|--|----|---|--|
|  +      | or |    | ⇒ Adjust the backlight flashing level (5 levels, default level 3)  |
|  +      |    |   | ⇒ Select different backlight effects: 6 modes (5 RGB modes + 1 customisable mode)<br>Flowing (default); Colourful breathing; One click; Ripple; Single colour breathing (press Fn + Space to adjust the colour, 8 colours + light off); Customised |
|  +  |    |   | ⇒ Switch backlight on/off  |
|  +  | or |  | ⇒ Adjust brightness level (5 levels, default level 5)  |
|  +  |    |   | ⇒ Lock the Win Key, press again to cancel lock   |

## Customising Backlight Effect:













You may customise the backlight for each key.

- Press **Fn + End** repeatedly to select the customised backlight mode. Keys **WASD** will light up for the first time.
- Press and hold **Fn + End** to enter backlight setting mode. **LED indicator** will start flashing.
- Press the key(s) repeatedly to choose the colour you prefer (8 colours + light off).
- Press and hold **Fn + End** when done. **LED indicator** will stop flashing.

To reset customised backlight effect to default setting, press and hold **Fn + End** until all backlights start lighting in succession.

## Shortcut Keys:

To access these functions, press the Fn Key and the desired key together.

Fn+F1	 Open Standard Media Application	Fn+F9	 Open Standard Web Application
Fn+F2	 Volume -	Fn+F10	 Open Standard Mail Application
Fn+F3	 Volume +	Fn+F11	 Lock Keyboard, 3rd LED indicator will turn on which indicates all keys are locked, press it once again to cancel lock, then indicator will turn off.
Fn+F4	 Mute	Fn+F12	 Open Standard Calculator Application
Fn+F5	 Stop Media		
Fn+F6	 Previous Track		
Fn+F7	 Play/Pause		
Fn+F8	 Next Track		

## Software (Only for Windows as Download):

1. Please download the software from [www.sure-re-gaming.com/support](http://www.sure-re-gaming.com/support).
2. Start the installation by executing the downloaded file from your download place.
3. Follow the installation process.
4. Plug the keyboard into the USB Port of your computer.
5. Start the Software via the shortcut on your desktop and configure your keyboard with your preferred setup.
6. For further details please see below and opposite.

## Light Setting:

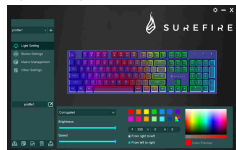

You can select different lighting modes or turn off the lighting on your keyboard. Please transfer your selection to the keyboard by pressing "Save".

## Key Setup:

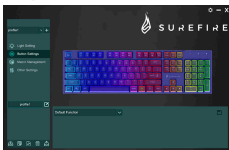

By selecting the desired key, you can now select a function for every key, always confirm a selection by pressing "Save" to transfer your selection to the keyboard. You can save or load configurations by pressing the buttons "Export" and "Import". To reset your keyboard to factory default press "Reset".

## Macro Management:

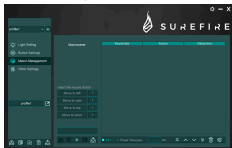

Setting up a Macro of different Keys or functions, please create a New Macro. You can set the Macro to any of the keys on your keyboard as described in the "Key Setup" of this manual.

## Other Settings:

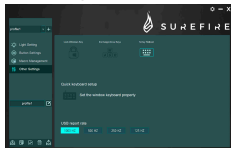

Please use the other settings to adjust the desired setting to your preferences.

- Lock Windows Keys
- Exchange Arrow Keys (WASD will switch to Arrow Keys)
- N-Key Rollover (Switch between N-Key and 6-Key Rollover)
- Go to Windows Keyboard configuration
- Set USB report rate

Please transfer your changed settings to the keyboard by pressing "Save".

## Specifications

Type: mechanical, wired  
Switch type: Red Mechanical Switches  
Keystroke life: 50 million hits  
Key operating force: 50±10g  
Key travel: 4±0.4mm  
Anti-ghosting: all keys (100% anti-ghosting)  
Backlight: RGB LED backlight, 6 modes  
Multimedia keys: 12 multimedia shortcut keys  
Cable length: 1.80m  
Rating: 5V/400mA (max)  
Product dimensions: 436mm×125.7mm×32.5mm (height incl. feet)  
Product weight: 1025g  
Panel material: galvanised iron  
Bottom cover: ABS plastic

Layout: QWERTZ (German 48718)  
Key-Cap: 105 Keys  
All keys are anti-ghosting keys  
Layout: QWERTY (US-English 48719)  
Key-Cap : 104 Keys  
All keys are anti-ghosting keys  
Layout: QWERTY (Nordic 48720), (Spanish 48721), (Italian 48722)  
Key-Cap : 105 Keys  
All keys are anti-ghosting keys  
Layout: AZERTY (French 48723)  
Key-Cap : 105 Keys  
All keys are anti-ghosting keys

## Limited Warranty Terms

Verbatim GmbH warrants this product to be free from defects in material and workmanship for a period of 2 years from date of purchase. This warranty excludes batteries. If this product is found to be defective within the warranty period, it will be replaced at no cost to you. You may return it with your original cash register receipt to the place of purchase or contact Verbatim. Product replacement is your sole remedy under this warranty, and this warranty does not apply to normal wear or to damage resulting from abnormal use, misuse, abuse, neglect or accident, or to any incompatibility or poor performance due to the specific computer software or hardware used. VERBATIM WILL NOT BE LIABLE FOR DATA LOSS OR ANY INCIDENTAL, CONSEQUENTIAL OR SPECIAL DAMAGES, HOWEVER CAUSED, FOR BREACH OF WARRANTIES OR OTHERWISE. This warranty gives you specific legal rights and you may also have other rights which vary from state to state or country to country.

## Note

---

Verbatim GmbH may at any time revise the content of this user guide without further notice.

## Rights

---

Copyright © 2021 Verbatim GmbH. No part of this document may be reproduced in any form or by any means, for any purpose, without the express written permission of Verbatim GmbH. All rights reserved. All other brands and product names referenced herein are property of their respective owners.

## CE Declaration

---

Complied the requirements set out in the Council Directive on the Approximation of the Laws of the Member States relating to Electromagnetic Compatibility (2014/30/EC) and General Product Safety Directive (2001/95/EC).

This declaration applies to all specimens manufactured identical to the model submitted for testing/evaluation.

EN 55032:2015

EN 61000-3-2:2014

EN 61000-3-3:2013

EN 55035:2017

EN 62368-1:2014+A11:2017

EN 60950-1:2006+A11:2009+A1:2010+A12:2011+A2:2013

EN 62471:2008

## RoHS Compliance

---

This product is in compliance with Directives 2011/65/EU and 2015/683 of the European Parliament and of the Council of 18th December 2006, on the restriction of the use of hazardous substances in electrical and electronic equipment (RoHS) and its amendments.

Substances of Very High Concern (SVHC) including 223 substances contained in Candidate List of January 17th 2022 are not present in this product range above permitted levels.

## WEEE Notice

---

The Directive on Waste Electrical and Electronic Equipment (WEEE), which entered into force as European law on 13th February 2003, resulted in a major change in the treatment of electrical equipment at end-of-life.



The WEEE logo (shown at the left) on the product or on its box indicates that this product must not be disposed of or dumped with your other household waste. For more information about electronic and electrical waste equipment disposal, recovery, and collection points, please contact your local municipal household waste disposal service or shop from where you purchased the equipment.

## Technical Support

---

- a To download the user manual, access frequently asked questions or contact the SureFire support team, please go to – [www.surefire-gaming.com/support](http://www.surefire-gaming.com/support).
- b Pour télécharger le manuel d'utilisation, accéder aux questions fréquemment posées ou contacter l'équipe d'assistance SureFire, veuillez vous rendre sur - [www.surefire-gaming.com/support](http://www.surefire-gaming.com/support).
- c Um die Betriebsanleitung herunterzuladen, auf häufig gestellte Fragen zuzugreifen oder das SureFire-Supportteam zu kontaktieren, gehen Sie bitte auf - [www.surefire-gaming.com/support](http://www.surefire-gaming.com/support).
- d Per scaricare il manuale utente, vedere le risposte alle domande più frequenti o contattare il team di Assistenza SureFire, visita la pagina: [www.surefire-gaming.com/support](http://www.surefire-gaming.com/support).
- e Para descargar el manual de usuario, acceder a las preguntas más frecuentes o ponerse en contacto con el equipo de asistencia de SureFire, visite - [www.surefire-gaming.com/support](http://www.surefire-gaming.com/support).
- √ For at downloade brugervejledningen, få adgang til Ofte stillede spørgsmål, eller tage kontakt til SureFire supportteam, skal du gå til – [www.surefire-gaming.com/support](http://www.surefire-gaming.com/support).
- ⊞ For å laste ned bruksanvisningen, se vanlige spørsmål eller ta kontakt med støttetteamet til SureFire, kan du besøke - [www.surefire-gaming.com/support](http://www.surefire-gaming.com/support).
- Ⓢ För att ladda ner bruksanvisningen, få tillgång till vanliga frågor eller kontakta SureFires supportteam, gå du till – [www.surefire-gaming.com/support](http://www.surefire-gaming.com/support).
- ⊔ Voit ladata käyttäjän käsikirjan, katsoa usein esitettyjä kysymyksiä tai ottaa yhteyttä SureFire-tukitiimiin siirtymällä osoitteeseen – [www.surefire-gaming.com/support](http://www.surefire-gaming.com/support).
- √√ Pentru a descărca manualul de utilizare, pentru a accesa întrebările frecvente sau pentru a contacta echipa de asistență SureFire, vă rugăm să accesați - [www.surefire-gaming.com/support](http://www.surefire-gaming.com/support).

EUROPE/ MIDDLE EAST/ AFRICA:

Verbatim GmbH, Düsseldorf StraÙe 13, 65760 Eschborn, Germany

SureFire is a brand owned by Verbatim GmbH.  **Verbatim.**