

1

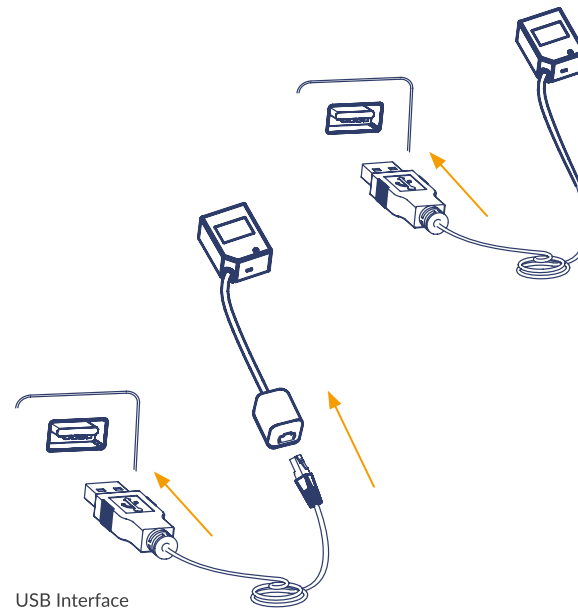

USB Interface

2

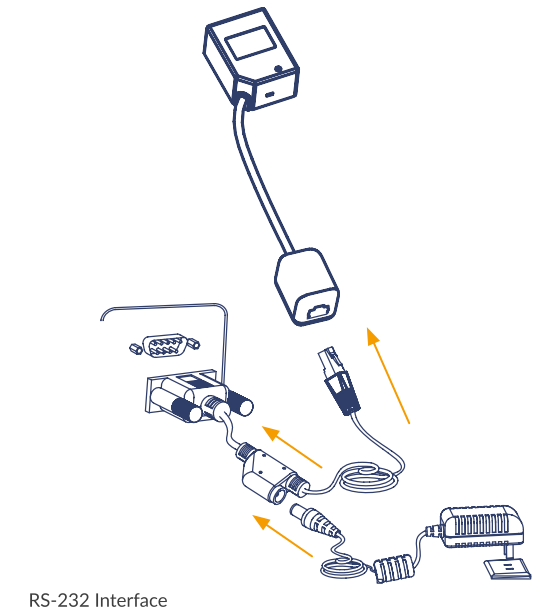

RS-232 Interface

3

Note: The host refers to a PC, POS, or other terminal equipped with USB or RS-232 interface.

## Scanning instructions

### Sense scan mode (default):

- Step 1:** Connect the scanner to a host with the cable.  
Then the scanner will be powered on.
- Step 2:** Position the barcode on the mobile phone screen or paper in the center of the scan window.
- Step 3:** For a good read, the LED on the scanner will flash.

## Troubleshooting

### When the scanner is not working, please:

- 1 Ensure that all cable connections are secure.
- 2 Ensure that the screen backlight is on when reading digital barcodes off a mobile phone and that the barcode is not defaced when reading it on paper. Wrinkled, soiled, or torn barcodes might be unreadable.
- 3 Ensure that the barcode type is enabled.



Visit our website  
[newland-id.com](http://newland-id.com)

4