

# Conference Table Box for AV Connectivity - VGA, DisplayPort, HDMI - 4K

BOX4HDECP2

## Package Contents

- 1 x Conference Table Box
- 1 x Universal Power Adapter (NA/JP, EU, UK, ANZ)
- 1 x Die Cut Outline
- 2 x Mounting Brackets
- 1 x Cable Tie Bracket
- 2 X Cable Tie Bracket Screws
- 1 x Quick-Start Guide

## Requirements

### For Installation

- Table Surface
- HDMI Enabled Display Device w/ HDMI Cable (e.g. television, projector)
- Network Host Device w/ Ethernet Cable (e.g. router, switch)
- (Optional) Phillips® Head Screwdriver
- (Optional) 2 x Cable Ties

### For Operation

- Video Input Device (HDMI/DP/VGA) and/or Network Interface Device
- (Optional) 3 x Battery-Powered Mobile Devices (for Charge Ports)

## Product Diagram

### Top View

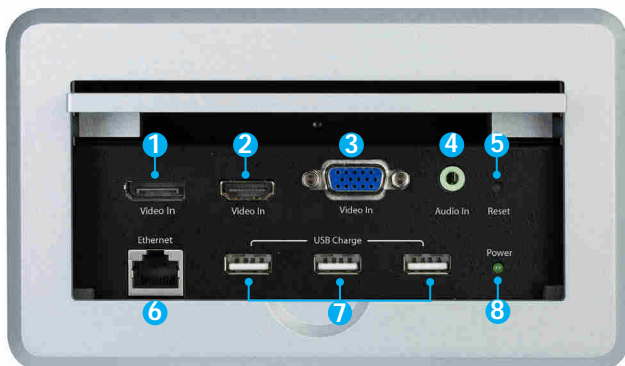

\*actual product may vary from photos

1. DisplayPort Video In Port
2. HDMI Video In Port
3. VGA Video In Port
4. 3.5 mm Audio In Port
5. Reset Button
6. Ethernet Port
7. USB Charge Port (USB Type-A) x 3
8. Power LED Indicator

### Bottom View



\*actual product may vary from photos

1. HDMI Video Out Port
2. Power Adapter Port
3. Ethernet Port

## Installation

**Warning:** test the functionality of BOX4HDECP2 with your equipment to ensure compatibility before installation.

**Note:** StarTech.com is not responsible for damage to your Table Surface. Be sure to exercise caution, when cutting or altering your Table Surface in any way.

1. Using the included Die Cut Outline, trace the inner rectangle on the Table Surface in your desired location.

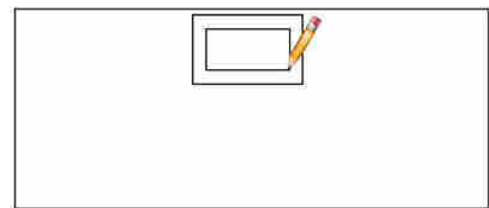

2. Carefully cut the rectangle out of the Table Surface.

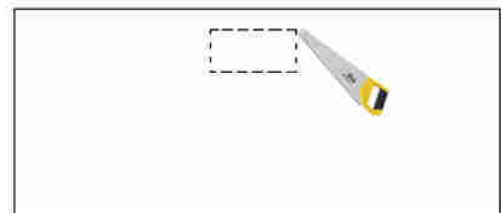

3. Slide the Conference Table Box into the rectangular hole in your Table Surface.

- Under the Table Surface, slide each of the Mounting Brackets into a mounting bracket slot on either side of the Conference Table Box.



- Twist the Mounting Bracket wing screws in a counterclockwise direction until the heads of the screws are seated firmly against the underside of your table.  
**Note:** do not overtighten the screws on the Mounting Brackets.
- Using an HDMI Cable (sold separately), connect your HDMI Enabled Display Device to the HDMI Video Out Port.
- (Optional) Using a Phillips Head Screwdriver and the two Cable Tie Bracket Screws, attach the Cable Tie Bracket to the bottom of the Conference Table Box.
- (Optional) Using two Cable Ties (sold separately), secure your HDMI Cable to the Cable Tie Bracket.
- (Optional) Using an Ethernet Cable (sold separately), connect your Network Host Device to the Ethernet Port located on the bottom of the unit.
- Connect the Universal Power Adapter to the Power Adapter Port on the Conference Table Box and to a power outlet.

#### Safety Measures

- If product has an exposed circuit board, do not touch the product under power.
- If Class 1 Laser Product. Laser radiation is present when the system is open.
- Wiring terminations should not be made with the product and/or electric lines under power.
- Product installation and/or mounting should be completed by a certified professional as per the local safety and building code guidelines.
- Cables (including power and charging cables) should be placed and routed to avoid creating electric, tripping or safety hazards.

#### Mesures de sécurité

- Si l'un des circuits imprimés du produit est visible, ne pas touchez le produit lorsqu'il est sous tension.
- Si le produit est Laser de Classe 1, le rayonnement laser est présent lorsque le système est ouvert.
- Les terminaisons de câblage ne doivent pas être effectuées lorsque le produit et/ou les câbles électriques sont sous tension.
- L'installation et/ou le montage du produit doit être réalisé par un professionnel certifié et dans le respect des normes locales et du code de construction local.
- Les câbles (y compris les câbles d'alimentation et de chargement) doivent être placés et acheminés de façon à éviter tout risque électrique, de chute ou de sécurité.

Pour consulter les manuels, les vidéos, les FAQ, les contrôleurs, les téléchargements, et plus encore, visitez: [www.StarTech.com/fr/support-produit](http://www.StarTech.com/fr/support-produit).

#### 安全対策

- 製品に露出した状態の回路基盤が含まれる場合、電源が入っている状態で製品に触らないでください。
- クラス1レーザー製品では、システムが開放状態の場合、レーザー光が照射されています。
- 電源が入っている状態の製品または電線の終端処理を行わないでください。
- 製品の設置やマウントは、使用地域の安全ガイドラインおよび建築基準に従い、有資格の専門業者が行うようにしてください。
- ケーブル(電源ケーブルと充電ケーブルを含む)は、適切な配置と引き回しを行い、電気障害やつまづきの危険性など、安全上のリスクを回避するようにしてください。

マニュアル、動画、FAQ、ドライバ、ダウンロード情報などを、[www.StarTech.com/jp/Support](http://www.StarTech.com/jp/Support)にてご覧いただけます。

#### Misure di sicurezza

- Se il prodotto ha un circuito stampato visibile, non toccare il prodotto quando è acceso.
- Prodotto laser di Classe 1. Quando il sistema è aperto sono presenti radiazioni laser.
- I terminali dei cavi elettrici non devono essere realizzate con il prodotto e/o le linee elettriche sotto tensione.
- L'installazione e/o il montaggio dei prodotti devono essere eseguiti da un tecnico professionale certificato che conosca le linee guida locali sulle norme edilizie e sulla sicurezza.
- I cavi (inclusi i cavi di alimentazione e di ricarica) devono essere posizionati e stesi in modo da evitare pericoli di inciampo, rischi di scosse elettriche o pericoli per la sicurezza.

Per visualizzare manuali, video, domande frequenti, download e altro ancora, visita [www.StarTech.com/it/assistenza-e-vendite](http://www.StarTech.com/it/assistenza-e-vendite).

#### Säkerhetsåtgärder

- Rör aldrig vid enheter med oskyddade kretskort när strömmen är påslagen.
- Om laserproduktet är Klasse 1, laserstrålning avges när systemet är öppet.
- Montering av kabelavslutningar får inte göras när produkten och/eller elledningarna är strömförda.
- Installation och/eller montering får endast göras av behöriga yrkespersoner och enligt gällande lokala föreskrifter för säkerhet och byggnormer.
- Kablar (inklusive elkablar och laddningskablar) ska dras och placeras på så sätt att risk för snubblingsolyckor och andra olyckor kan undvikas.

För nedladdningar, handböcker, videor och vanliga frågor, drivrutiner, besök [www.StarTech.com/se/support](http://www.StarTech.com/se/support).

#### FCC Compliance Statement

This equipment has been tested and found to comply with the limits for a Class B digital device, pursuant to part 15 of the FCC Rules. These limits are designed to provide reasonable protection against harmful interference in a residential installation. This equipment generates, uses and can radiate radio frequency energy and, if not installed and used in accordance with the instructions, may cause harmful interference to radio communications. However, there is no guarantee that interference will not occur in a particular installation. If this equipment does cause harmful interference to radio or television reception, which can be determined by turning the equipment off and on, the user is encouraged to try to correct the interference by one or more of the following measures:

## Operation

- Connect your Video Input Device(s) to any available audio/video input port (HDMI Video In / DisplayPort Video In / VGA Video In+3.5 mm Audio In) using the required cabling (sold separately).
- (Optional) Connect your Network Interface Device to the Ethernet Port located on the top of the Conference Table Box, using an Ethernet Cable (sold separately).  
**Note:** Ethernet cabling should not run parallel to the main power cable.
- The signal from your Video Input Device will now display on your HDMI Enabled Display Device.

## Automatic Video Switching

This connectivity box features a switch that can automatically select the most recently activated or connected Video Input Device. To automatically switch between inputs, connect a new Video Input Device or turn on a Video Input Device that's already connected.

## USB Charge Port Operation

The USB Charge Port is a battery charging port capable of charging mobile devices faster than through a standard USB port.

**Note:** these ports feature USB Battery Charging, Revision 1.2.

- Connect your Battery-Powered Mobile Devices to the USB Charge Port using a USB cable (sold separately).
- Disconnect your Battery-Powered Mobile Devices when charging is complete.

## Reset Button

If you connect a Video Input Device but a connection is not established, press and release the Reset Button on the Conference Table Box, then reconnect or power cycle your Video Input Device.

- Reorient or relocate the receiving antenna.
- Increase the separation between the equipment and receiver.
- Connect the equipment into an outlet on a circuit different from that to which the receiver is connected.
- Consult the dealer or an experienced radio/TV technician for help.

This device complies with part 15 of the FCC Rules. Operation is subject to the following two conditions: (1) This device may not cause harmful interference, and (2) this device must accept any interference received, including interference that may cause undesired operation. Changes or modifications not expressly approved by StarTech.com could void the user's authority to operate the equipment.

#### Industry Canada Statement

This Class B digital apparatus complies with Canadian ICES-003. Cet appareil numérique de la classe [B] est conforme à la norme NMB-003 du Canada. CAN ICES-3 (B)/NMB-3(B)

This device complies with Industry Canada licence-exempt RSS standard(s). Operation is subject to the following two conditions: (1) This device may not cause interference, and (2) This device must accept any interference, including interference that may cause undesired operation of the device.

Le présent appareil est conforme aux CNR d'Industrie Canada applicables aux appareils radio exempts de licence. L'exploitation est autorisée aux deux conditions suivantes:

(1) L'appareil ne doit pas produire de brouillage, et (2) l'utilisateur de l'appareil doit accepter tout brouillage radioélectrique subi, même si le brouillage est susceptible d'en compromettre le fonctionnement.

#### Use of Trademarks, Registered Trademarks, and other Protected Names and Symbols

This manual may make reference to trademarks, registered trademarks, and other protected names and/or symbols of third-party companies not related in any way to StarTech.com. Where they occur these references are for illustrative purposes only and do not represent an endorsement of a product or service by StarTech.com, or an endorsement of the product(s) to which this manual applies by the third-party company in question. Regardless of any direct acknowledgement elsewhere in the body of this document, StarTech.com hereby acknowledges that all trademarks, registered trademarks, service marks, and other protected names and/or symbols contained in this manual and related documents are the property of their respective holders. PHILLIPS® is a registered trademark of Phillips Screw Company in the United States or other countries.

#### Technical Support

StarTech.com's lifetime technical support is an integral part of our commitment to provide industry-leading solutions. If you ever need help with your product, visit [www.startech.com/support](http://www.startech.com/support) and access our comprehensive selection of online tools, documentation, and downloads. For the latest drivers/software, please visit [www.startech.com/downloads](http://www.startech.com/downloads)

#### Warranty Information

This product is backed by a one-year warranty. StarTech.com warrants its products against defects in materials and workmanship for the periods noted, following the initial date of purchase. During this period, the products may be returned for repair, or replacement with equivalent products at our discretion. The warranty covers parts and labor costs only. StarTech.com does not warrant its products from defects or damages arising from misuse, abuse, alteration, or normal wear and tear.

#### Limitation of Liability

In no event shall the liability of StarTech.com Ltd. and StarTech.com USA LLP (or their officers, directors, employees or agents) for any damages (whether direct or indirect, special, punitive, incidental, consequential, or otherwise), loss of profits, loss of business, or any pecuniary loss, arising out of or related to the use of the product exceed the actual price paid for the product. Some states do not allow the exclusion or limitation of incidental or consequential damages. If such laws apply, the limitations or exclusions contained in this statement may not apply to you.

FR: Guide de l'utilisateur - [fr.startech.com](http://fr.startech.com)  
DE: Bedienungsanleitung - [de.startech.com](http://de.startech.com)  
ES: Guía del usuario - [es.startech.com](http://es.startech.com)  
NL: Gebruiksaanwijzing - [nl.startech.com](http://nl.startech.com)

PT: Guia do usuário - [pt.startech.com](http://pt.startech.com)  
IT: Guida per l'uso - [it.startech.com](http://it.startech.com)  
JP: 取扱説明書 - [jp.startech.com](http://jp.startech.com)

#### Reviews

Share your experiences using StarTech.com products, including product applications and setup, what you love about the products, and areas for improvement.

To view manuals, videos, drivers, downloads, and more, visit [www.startech.com/support](http://www.startech.com/support).