

**PHILIPS**

Portable speaker

BT55

# User manual



Register your product and get support at

[www.philips.com/support](http://www.philips.com/support)

# Contents

---

1	Important	2
---	-----------	---

---

2	Notice	2
	Compliance	2
	Care of the environment	2
	Trademark notice	3

---

3	Your Bluetooth speaker	3
	Introduction	3
	What's in the box	3
	Overview of the speaker	4

---

4	Get started	4
	Turn on/o	4
	Charge the built-in battery	4

---

5	Play from Bluetooth devices	5
	Connect a Bluetooth device	5
	Play from a connected Bluetooth device	6
	Disconnect a device	6
	Reconnect a device	6

---

6	Specifications	7
---	----------------	---

---

7	Troubleshooting	7
	General	7
	About Bluetooth device	7

# 1 Important

- Only use attachments/accessories specified by the manufacturer.
- The battery shall not be exposed to excessive heat such as sunshine, fire or the like.
- Do not place any sources of danger on the apparatus (e.g. lighted candles).
- The operation temperature of the product is from -10 °C to 40 °C.



## Note

- The type plate is located on the bottom of the apparatus.

# 2 Notice

Any changes or modifications made to this device that are not expressly approved by Gibson Innovations may void the user's authority to operate the equipment.

---

## Compliance

Hereby, Gibson Innovations declares that this product is in compliance with the essential requirements and other relevant provisions of Directive 2014/53/EU. You can find the Declaration of Conformity on [www.philips.com/support](http://www.philips.com/support).

---

## Care of the environment

Disposal of your old product and battery



Your product is designed and manufactured with high quality materials and components, which can be recycled and reused.



This symbol on a product means that the product is covered by European Directive 2012/19/EU.



This symbol means that the product contains a built-in rechargeable battery covered by European Directive

2013/56/EU which cannot be disposed of with normal household waste. We strongly advise you to take your product to an official collection point or a Philips service centre to have a professional remove the rechargeable battery. Inform yourself about the local separate collection system for electrical and electronic products and rechargeable batteries. Follow local rules and never dispose of the product and rechargeable batteries with normal household waste. Correct disposal of old products and rechargeable batteries helps prevent negative consequences for the environment and human health.

 **Caution**

- Removal of the built-in battery invalidates the warranty and may destroy the product.

Always bring your product to a professional to remove the built-in battery.

---

## Trademark notice



The Bluetooth® word mark and logos are registered trademarks owned by Bluetooth SIG, Inc. and any use of such marks by Gibson Innovations Limited is under license. Other trademarks and trade names are those of their respective owners.

# 3 Your Bluetooth speaker

Congratulations on your purchase, and welcome to Philips! To fully benefit from the support that Philips offers, register your product at [www.philips.com/welcome](http://www.philips.com/welcome).

---

## Introduction

With this speaker, you can enjoy audio from Bluetooth-enabled devices.

---

## What's in the box

Check and identify the contents of your package:

- Speaker
- USB cable for charging
- Printed materials

## Overview of the speaker

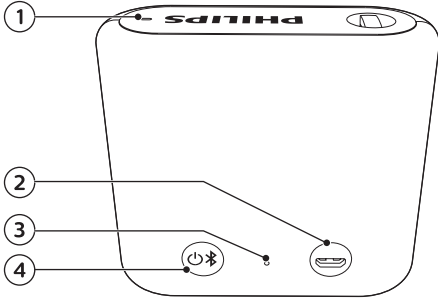

- a LED indicator
  - Indicate the battery or Bluetooth connection status.
- b Micro USB socket
  - Charge the speaker.
- c Reset hole
  - Reset the speaker.
- d 
  - Turn the speaker on or off.
  - Enter Bluetooth pairing mode.
  - Disconnect Bluetooth connection.

## 4 Get started

Always follow the instructions in this chapter in sequence.

### Turn on/off

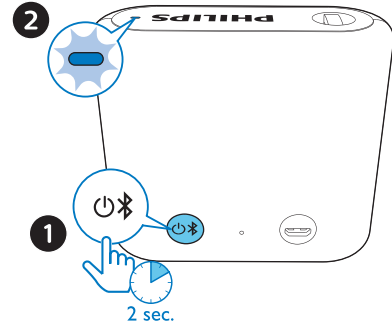

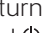
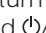
- To turn the speaker on, press and hold  for two seconds.
  - » The LED indicator starts flashing.
  - » The speaker beeps.
- To turn the speaker off, press and hold  for two seconds again.

#### Note

- When there is no Bluetooth connection for 15 minutes or the battery is at low level, the speaker turns off automatically to save power.

### Charge the built-in battery

#### Note

- It takes you approximately two hours to fully charge the battery.
- The micro USB socket is for charging only.
- Rechargeable battery has a limited number of charge cycles. Battery life and number of charge cycles vary by use and settings.

When the battery level is low, the LED indicator flashes red.

**To charge the built-in battery:**

- Connect the speaker to AC power by using a power adaptor (not supplied; 5V 2.1A adaptor recommended).

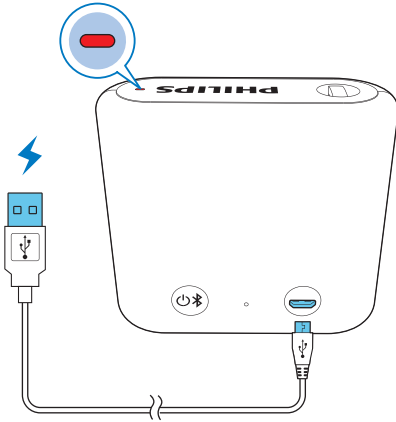

System status	Battery status	LED behavior
On	During charging	No charging indication
O	During charging	Solid red
O	Fully charged	O

## 5 Play from Bluetooth devices

### Connect a Bluetooth device

**Note**

- Make sure that Bluetooth function is enabled on your device, and your device is set as visible to all other Bluetooth devices.
- Any obstacle between this speaker and a Bluetooth device can reduce the operational range.
- Keep away from any other electronic device that may cause interference.
- The operational range between this speaker and a Bluetooth device is approximately 10 meters.

- 1 Make sure that the speaker is in Bluetooth pairing mode.
  - » The LED indicator flashes blue quickly.
  - » If the LED flashes blue slowly, turn off the speaker, then press and hold  $\text{⏻}/\text{⌂}$  until the speaker beeps twice to enter pairing mode.
- 2 On your Bluetooth device, enable Bluetooth and search for Bluetooth devices that can be paired (see the user manual of the device).
- 3 Select [Philips BT55] displayed on your device for pairing. If necessary, input "0000" as the pairing password.
  - » After successful connection, the speaker beeps, and the LED turns solid blue.

LED behavior	Description
Flashing blue quickly	Ready for pairing
Flashing blue slowly	Reconnecting the last connected device; Waiting for connection from the paired device
Solid blue	Connected

---

## Reconnect a device

- When you turn on the speaker, it tries to reconnect the last connected device automatically;
- If not successful, select [Philips BT55] on your Bluetooth menu to start reconnection.

---

## Play from a connected Bluetooth device



### Note

- Music play pauses when there is an incoming call, and resumes when your phone call ends.

After successful Bluetooth connection, play audio on the connected device.

- » Audio streams from your Bluetooth device to the speaker.



### Tip

- You can only use your Bluetooth device to control play.

---

## Disconnect a device

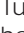
- Turn off the speaker;
- Turn on the speaker, then press and hold  until the speaker beeps twice to enter pairing mode;
- Disable Bluetooth on your device;  
or
- Move the device beyond the communication range.

## 6 Specifications



### Note

- Product information is subject to change without prior notice.
- Rated Output Power (Amplifier): 2W RMS
- Acoustic Frequency Response: 60-20000 Hz
- Speaker Driver: 1 x 1.5" full range, 4  $\Omega$
- Bluetooth Version: V4.2 + EDR
- Bluetooth Supported Profiles: HFP V1.6, A2DP V1.2, AVRCP V1.4
- Bluetooth Frequency Band / Output Power: 2.400GHz - 2.483GHz ISM Band /  $\leq$  4dBm (Class 2)
- Battery: Built-in Li-ion rechargeable battery(3.7V, 365 mAh)
- Play Time in Battery Mode: Approx. 6 hours
- Charging Time: Approx. 2 hours
- USB Charging: 5V, 0.5A / Micro-USB socket
- Product Dimensions (W x H x D): 85 x 75.8 x 34 mm
- Product Weight: 0.12kg

## 7 Troubleshooting



### Warning

- Never remove the casing of this device.

To keep the warranty valid, never try to repair the system yourself.

If you encounter problems when using this device, check the following points before requesting service. If the problem remains unsolved, go to the Philips Web page ([www.philips.com/support](http://www.philips.com/support)). When you contact Philips, make sure that the device is nearby and the model number and serial number are available.

---

### General

No power

- Recharge the speaker.

No sound

- Adjust volume on the connected device.
- Make sure that your Bluetooth device is within the effective operational range.

No response from the speaker when pressing any key.

- Reset the speaker.

---

### About Bluetooth device

The audio quality is poor after connection with a Bluetooth-enabled device.

- The Bluetooth reception is poor. Move the device closer to this product or remove any obstacle between them.



Fail to find [Philips BT55] on your device for pairing.

- Turn off the speaker, then press and hold  until the speaker beeps twice to enter pairing mode and try again.

Cannot connect with the device.

- The Bluetooth function of the device is not enabled. Refer to the user manual of the device for how to enable the function.
- This product is already connected with another Bluetooth-enabled device. Disconnect that device and then try again.

The paired device connects and disconnects constantly.

- The Bluetooth reception is poor. Move the device closer to this product or remove any obstacle between them.
- For some devices, Bluetooth connection may be deactivated automatically as a power-saving feature. This does not indicate any malfunction of this product.



Copyright © 2017 Gibson Innovations Limited.

This product has been manufactured by, and is sold under the responsibility of Gibson Innovations Ltd., and Gibson Innovations Ltd. is the warrantor in relation to this product.

The Philips trademark and the Philips Shield Emblem are registered trademarks of Koninklijke Philips N.V. used under license.

BT55\_00\_UM\_V1.0

