

(A). Wire Pin Assignment and Wire Description.

CN.1	PAIR#	CN.2	COLOR	
1	PAIR1	12	BLUE	red mylar
3		10	WHITE	
2	PAIR2	11	DRAIN	yellow mylar
4		9	BLUE	
6	PAIR3	7	WHITE	orange mylar
5		8	DRAIN	
7	PAIR4	6	BLUE	blue mylar
9		4	WHITE	
8	PAIR5	5	DRAIN	green mylar
10		3	BLUE	
12	SIGNAL	1	WHITE	GREEN
11		2	DRAIN	
13	SIGNAL	13	GREEN	RED
14		14	RED	
15	PAIR6	15	BLUE	green mylar
17		17	WHITE	
16	SIGNAL	16	DRAIN	PURPLE
18		18	PURPLE	
19	SIGNAL	19	BLUE	BLUE
SHELL		SHELL	BRAID	

(B). Electrical Testing :

- a. OPEN/SHORT:100% Testing Line-Process.
- b. HI-POT: 100V AC/0.1sec.
- c. INSULATION RESISTANCE:10MΩ(MIN) 100V DC
- d. CONDUCTION RESISTANCE:5Ω(MAX)

④	MOLDING:PVC BLACK	/
③	DISPLAYPORT TOP/LOWER CASING:PC BLACK	1
②	DISPLAYPORT 20PIN PLUG,TERMINAL Au-PLATED SHELL Au-PLATED	1
①	DP CABLE [(28AWGx2C+MMEAM)x5P+28AWGx4C]+AB OD:7.5 Braid:85% BLACK PVC	/
ITEM	MATERIALS LIST & SPEC. DESCRIPTION	Q'TY

THIRD ANGLE PROJECTION

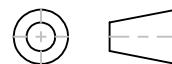

GENERAL NOTES

DIMENSIONS ARE IN MM - DO NOT SCALE
 THIS DOCUMENT CONTAINS CONFIDENTIAL, PROPRIETARY INFORMATION THAT IS PROPERTY OF STARTECH.COM

StarTech.com

PRODUCT ID	DP14MM5M
DESCRIPTION	5M DISPLAYPORT 1.4 CABLE
REV: A	DO NOT SCALE
SHEET : 1	OF: 1
DATE: 03/16/2020	