



JLAB
EPIC
KEYBOARD

We love that you are rocking JLab!
We take pride in our products and fully stand behind them.



YOUR WARRANTY

All warranty claims are subject to JLab authorization and at our sole discretion. Retain your proof of purchase to ensure warranty coverage.



CONTACT US

Reach out to us at support@jlab.com or visit jlab.com/contact

REGISTER TODAY

jlab.com/register

Product updates | How-to tips
FAQs & more

1 CONNECT WITH DONGLE

Install 2.4G USB dongle and switch keyboard on
Epic Keys will auto connect

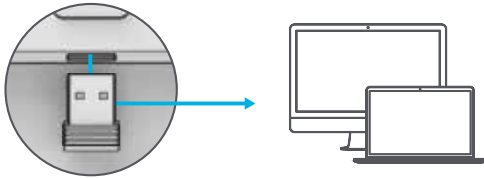

If connection is unsuccessful, press and hold 2.4 until button flashes quickly. Unplug and re-plug dongle into computer.

2 CONNECT WITH BLUETOOTH

Press and hold **⌘1** or **⌘2** for Bluetooth pairing
LED will blink in pairing mode

Press and hold CONNECT

Select "JLab Epic Keys"
in device settings

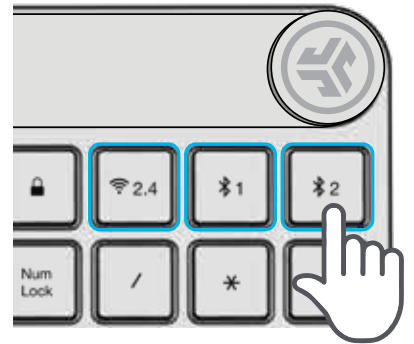

3 KEYS

BATTERY 100%-20% Less than 20%

USB-C Charge Input

Fn + F1-F12: Shortcut keys (see Shortcut Keys list)

Shortcut keys

MEDIA DIAL
Vol +/- : Rotate
Play/Pause: Single press
Track Forward: Double press
Track Back: Press and hold

Fn + Esc: Fn lock On/Off

Fn + Q / W / E: Switch Mac / Windows / Android keys layout

Switch Connection: Quick press
Pairing Mode: Press and hold

SHORTCUT KEYS

Fn +	MAC	PC	Android
Esc	FN Lock	FN Lock	FN Lock
F1	Brightness -	Brightness -	Brightness -
F2	Brightness +	Brightness +	Brightness +
F3	Task Control	Task Control	N/A
F4	Show Applications	Notification Center	N/A
F5	Search	Search	Search
F6	Backlit -	Backlit -	Backlit -
F7	Backlit +	Backlit +	Backlit +
F8	Track Back	Track Back	Track Back
F9	Track Forward	Track Forward	Track Forward
F10	Mute	Mute	Mute
F11	Screenshot	Screenshot	N/A
F12	N/A	Calculator	N/A

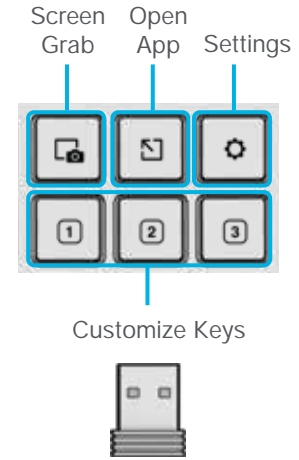

Customize the Epic Keys with
USB dongle + JLab Work App
jlab.com/software



[Shop products](#) | [Product alerts](#) | [Burn-in your headphones](#)

JLab Store + Burn-in Tool

