



The Jabra Engage 65 SE Engineered to be the world's most powerful professional wireless headsets*

The Jabra Engage 65 SE is an entirely new class of DECT wireless professional headsets engineered to boost customer satisfaction.

Industry-leading professional wireless performance. Better customer connections.

Provides superior wireless connectivity to a range of up to 150m/490ft. Enables up to 3x more users to operate in the same office space – with no loss in connection quality.¹

Crystal-clear calls. Enhance the customer experience.

Advanced noise-cancelling microphone and enhanced speakers deliver crystal-clear calls even in noisy offices. Meets Skype for Business Open Office requirements.²

More talk time, less interruption. Increase productivity.

Up to 13 hours talk time³ and a busylight that acts as a do-not-disturb sign for colleagues.

Increase availability for calls.

Connect to up to two devices simultaneously. Can connect to 1 USB device (softphone or desk phone⁴) and 1 analog phone.

Choice of wearing styles. Support different workstyles.

With stereo, mono and lightest-in-category convertible models, there's a Jabra Engage for everyone.

Rich call analytics.¹

Drive customer satisfaction with data driven decisions.

* Relates to Jabra Engage 75 SE/65 SE Stereo and Mono variants. February 19, 2018. See facts on Jabra.com/commercial-claims

¹ Find details on page 2 ² Variant dependent ³ Dependent on usage

⁴ Remote call control accessory needed to answer/end calls away from the desk

At a glance:
Jabra Engage 65 SE wireless headsets

- Up to 150m/490ft range
- Up to 3x wireless density¹
- Advanced noise-cancelling microphone
- Up to 13 hours talk time³
- Integrated busylight
- Connect up to 2 devices
- Rich call data for insights



Works with



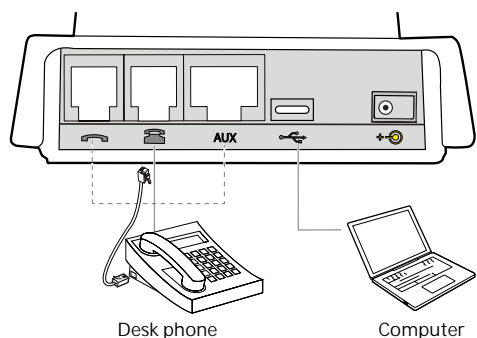

First, connect the desk phone and PC cables to the base.
For information on your specific phone, refer to
<http://www.jabra.com/compatibilityguide>

Connect to power

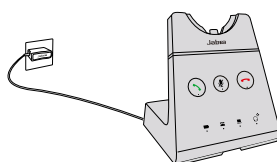

Stereo and Mono

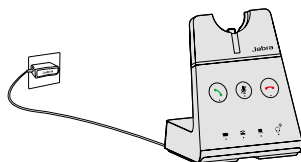

Convertible

Then plug the base into a power supply. Press Vol + and Vol - simultaneously to enter the setup menu to help you connect to your computer or desk phone.

How to use

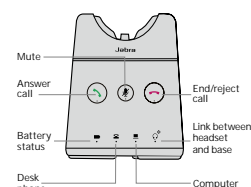

Base Unit

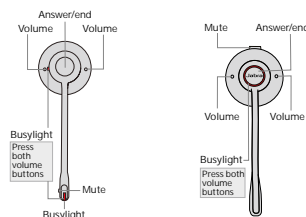

Stereo and Mono

Convertible



| | Features | Jabra Engage 65 SE Stereo | Jabra Engage 65 SE Mono | Jabra Engage 65 SE Convertible |
|----------------------------|--|---------------------------|-------------------------|--|
| Connectivity | Wireless capacity NA/EU – wideband ¹ | 70/145 | 70/145 | 70/145 |
| | Wireless capacity NA/EU – narrowband ² | 95/190 | 95/190 | 95/190 |
| | Wireless range (up to – meters/feet) | 150/490 | 150/490 | 100/330 |
| | Connectivity – how many devices | 2 ³ | 2 ³ | 2 ³ |
| | Wireless technology | DECT | DECT | DECT |
| | Secure DECT (level) | C | C | C |
| Audio | User sound protection ⁴ | | | |
| | SafeTone™ 2.0 (comprises PeakStop™, Intelligent acoustic shock protection, speech level normalization, and IntelliTone™ 2.0) | Yes | Yes | Yes |
| | Directional noise cancelling microphone | Yes | Yes | Yes |
| | Microphone (G-MOS, Tx, CC) | 4.3 | 4.3 | 3.8 |
| | Speaker (P-MOS, Rx, Silent) | 4.4 | 4.4 | 3.9 |
| | Meets Skype for Business Open Office requirements | Yes | Yes | No |
| | Certified for Zoom | Yes | Yes | No |
| | Music streaming via Bluetooth® | No | No | No |
| Ease of use | Talk time (up to – hours) ⁵ | 13 | 13 | 9 |
| | Fast charge – from 0-40% (minutes) | 30 | 30 | 30 |
| | Emergency charging | Yes | Yes | Yes |
| | Boom arm adjustable | 270° | 270° | 360° |
| | Busylight | Yes | Yes | Yes |
| Comfort | Wearing styles | Stereo | Mono ⁶ | Choice of earhook, neckband or headband ⁷ |
| | Headset weight (g) | 83 | 57 | 18 |
| Digital experiences | Background noise levels ⁸ | Yes | Yes | Yes |
| | Speech analytics ⁹ | Yes | Yes | Yes |
| | Audio exposure ⁸ | Yes | Yes | Yes |
| | Busylight customization ⁹ | Yes | Yes | Yes |
| | Headset interaction logging ⁹ | Yes | Yes | Yes |

Compatibility For compatibility information go to Jabra.com



¹ DECT capacity, number of theoretical users in wideband. Actual numbers may vary
² DECT capacity, number of theoretical users in narrowband. Actual numbers may vary

³ Can connect to 1 USB device (soft phone or desk phone) and 1 analog phone
⁴ Refer to <https://www.jabra.com/support1-page/hearing-protection> ⁵ Dependent on usage

⁶ Engage 65 SE Mono: neckband is available as an accessory ⁷ Engage 65 SE Convertible: neckband is available as an accessory

⁸ Via Jabra Xpress ⁹ Via Jabra SDK ¹⁰ Engage 65 SE Stereo and Mono variants only are Zoom certified

¹¹ Softphone certified, desk phone in progress