

4

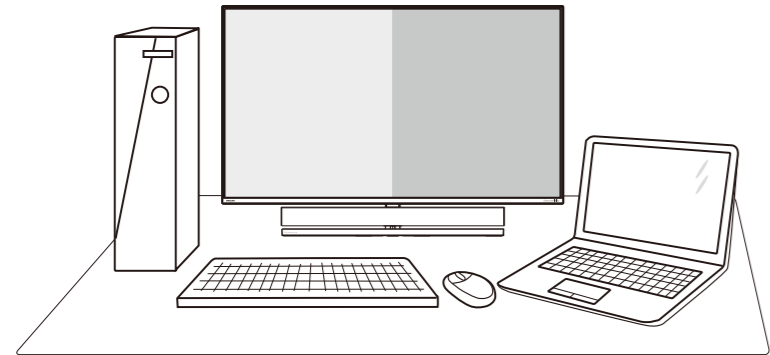

PBP

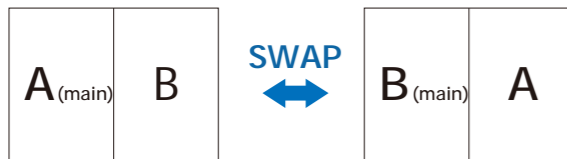

		SUB SOURCE POSSIBILITY (x1)				
MultiView	Inputs	HDMI 1	HDMI 2	HDMI 3	DisplayPort	USB C
MAIN SOURCE (x1)	HDMI 1	●	●	●	●	●
	HDMI 2	●	●	●	●	●
	HDMI 3	●	●	●	●	●
	DisplayPort	●	●	●	●	●
	USB C	●	●	●	●	●



Register your product and get support at [www.philips.com/support](http://www.philips.com/support)

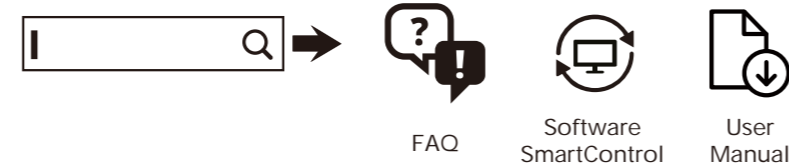

Version: 559MIC0IT  
2021 © TOP Victory Investments Ltd. All rights reserved.

This product has been manufactured by and is sold under the responsibility of Top Victory Investments Ltd., and Top Victory Investments Ltd. is the warrantor in relation to this product. Philips and the Philips Shield Emblem are registered trademarks of Koninklijke Philips N.V. and are used under license.

Specifications are subject to change without notice.

**HDMI**

The terms HDMI, HDMI High-Definition Multimedia Interface, and the HDMI Logo are trademarks or registered trademarks of HDMI Licensing Administrator, Inc.

[www.philips.com](http://www.philips.com)

Energy Labelling

559MIRVV



Printed in China



**PHILIPS**

Momentum

559M1

powered by  
Bowers & Wilkins



# Quick Start

Register your product and get support at [www.philips.com/welcome](http://www.philips.com/welcome)

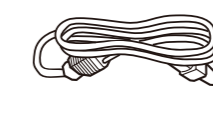
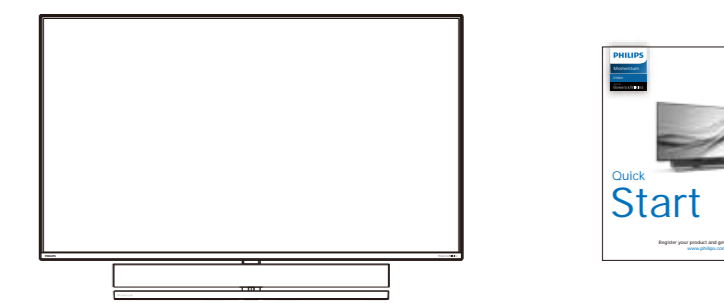

Power

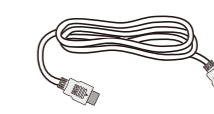

\*HDMI



\*CD

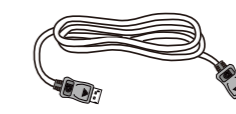

\*DP

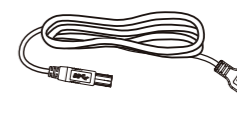

\*USB A-B

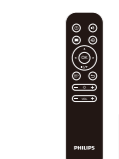

\*Remote Control  
Batteries AAA R03 1.5V

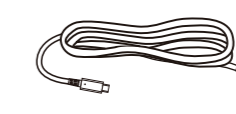

\*USB C-C

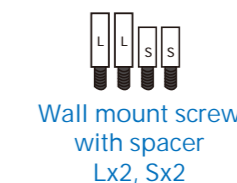

Wall mount screw  
with spacer  
Lx2, Sx2

\*Different according to region  
Display design may differ from that illustrated

1

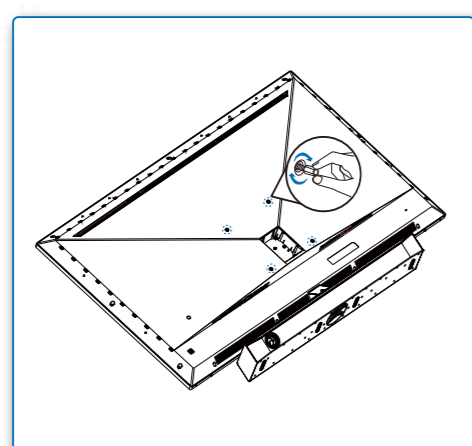
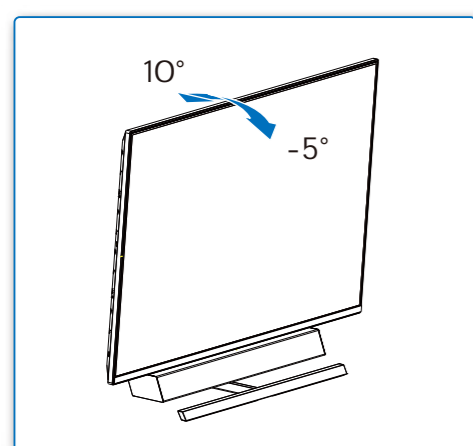

2

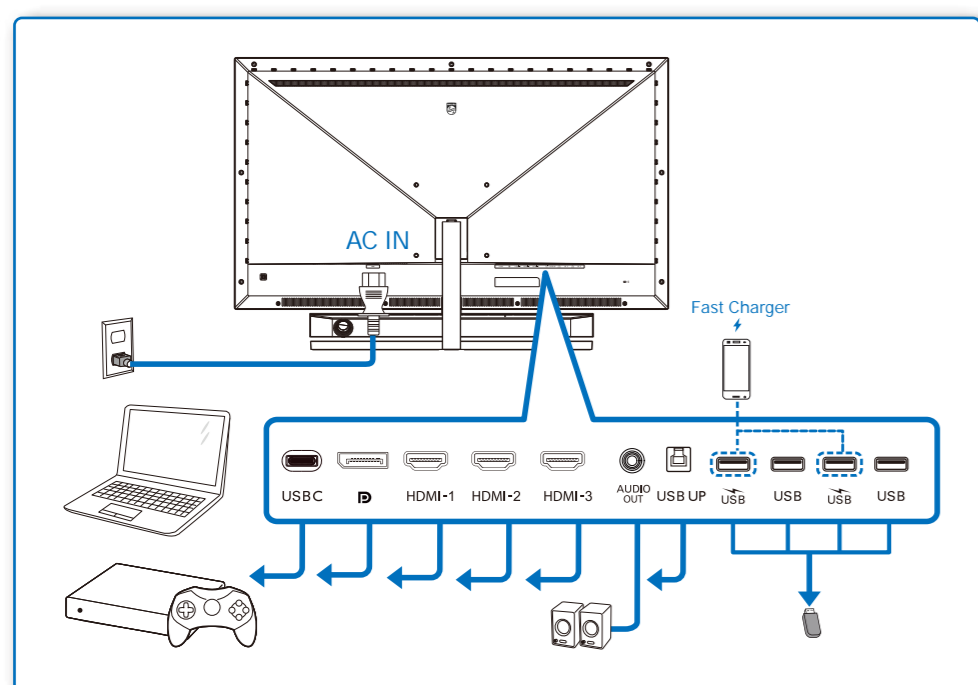

USB hub

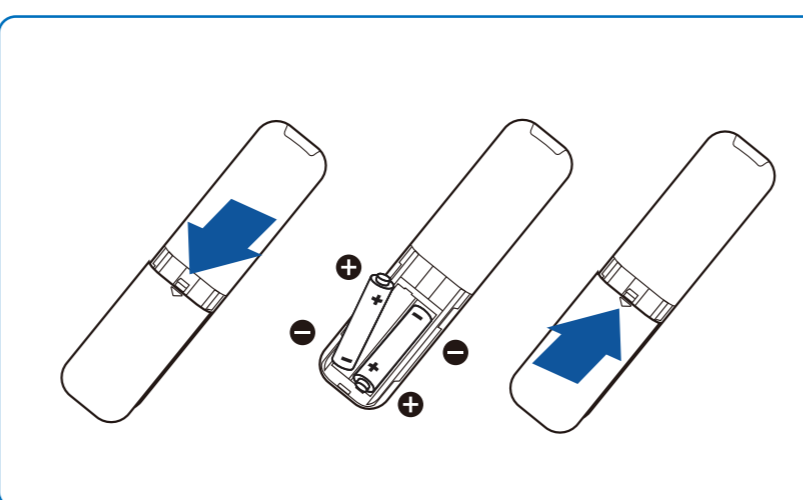
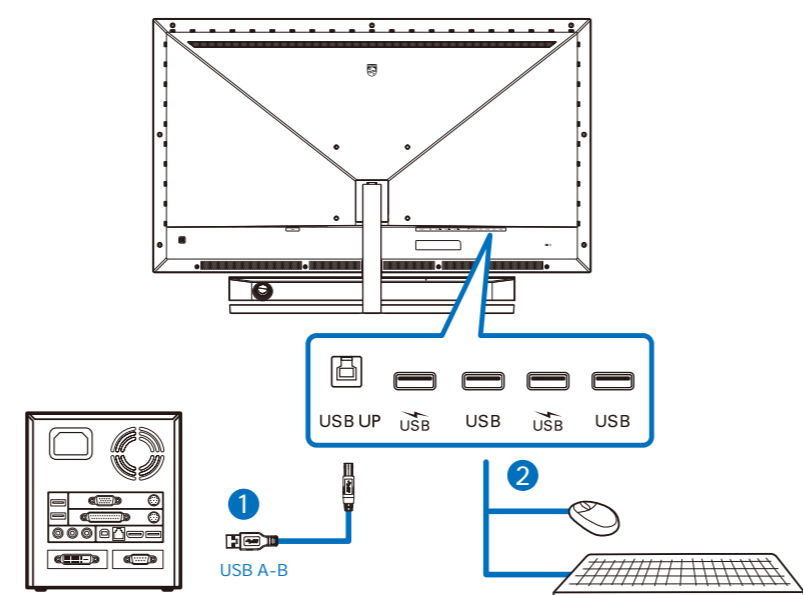

3

