

# QUICK START GUIDE

## GUÍA DE INICIO RÁPIDO



# STEALTH™

# 600

GEN 2

**IMPORTANT**  
READ BEFORE USING

**IMPORTANTE**  
LEA ANTES DE USAR

Any questions? ¿Preguntas?  
[turtlebeach.com/support](http://turtlebeach.com/support)  
Model: Stealth™ 600 Gen 2 para auriculares de juego para Xbox

### IMPORTANT

PLEASE MAKE SURE YOUR HEADSET IS UPDATED WITH THE LATEST FIRMWARE.

**IMPORTANTE**  
ASEGÚRATE DE QUE TUS AURICULARES ESTÁN ACTUALIZADOS CON EL ÚLTIMO FIRMWARE.

Connect to the Turtle Beach Audio Hub for Windows or Mac® to update firmware.

Conéctate a la aplicación Turtle Beach Audio Hub para Windows o Mac® para actualizar el firmware.

[turtlebeach.com/audiohub](http://turtlebeach.com/audiohub)



### CONTENTS

### CONTENIDO

A Stealth™ 600 Gen 2 Headset  
Auriculares Stealth™ 600 Gen 2

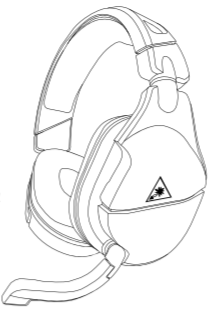

B USB-C Charging Cable  
Cable de carga USB-C



### HEADSET CONTROLS

### CONTROLES DE AURICULARES

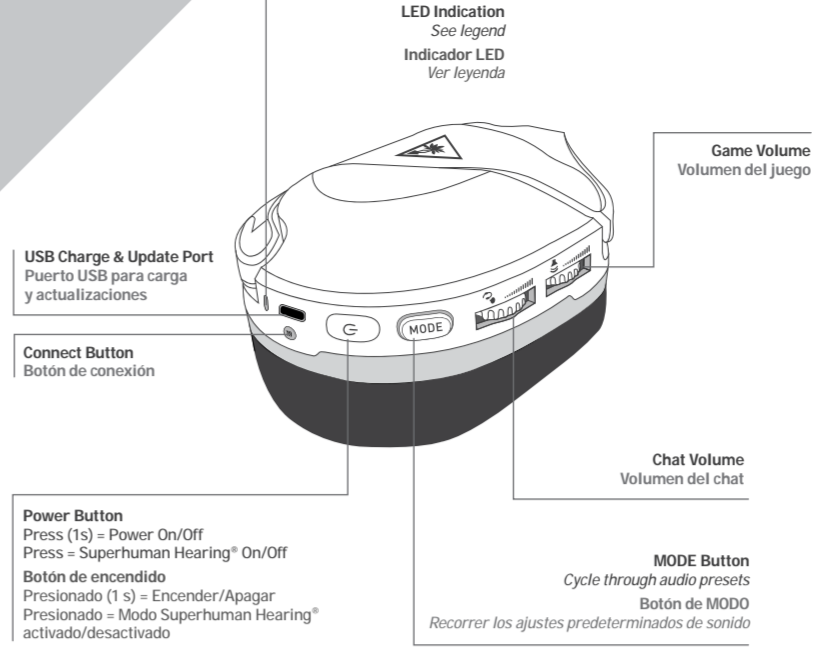

**SUPERHUMAN HEARING®**

Use Superhuman Hearing™ Mode to pinpoint quiet audio cues like enemy footsteps and weapon reloads. During gameplay, you can activate and deactivate Superhuman Hearing™ by pressing the **POWER** button **once**, **quickly**.

Utiliza el modo Superhuman Hearing® para detectar los sonidos más leves, como las pisadas y las recargas de las armas de los enemigos.

Durante el juego, puedes activar y desactivar el modo Superhuman Hearing™ al presionar rápidamente el botón de encendido (POWER) una sola vez.

**Microphone Mute**  
Flip up mic to mute. There is an audible tone when the mic is muted or unmuted.

**Silenciar micrófono**  
Voltea el micrófono hacia arriba para silenciarlo. Cuando el modo de silencio se activa o se desactiva, se escucha un tono en los auriculares.

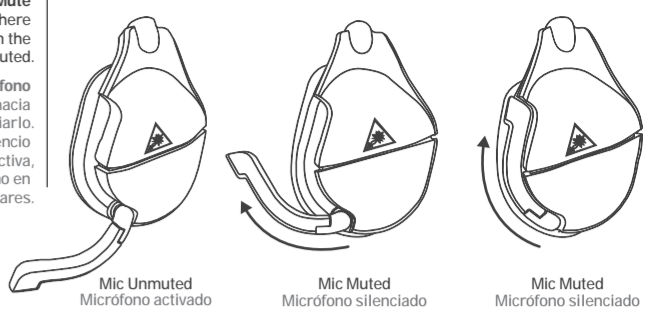

Mic Unmuted | Mic Muted | Mic Muted

Signature Sound | Sonido personalizado

Bass Boost | Potenciador de graves

Bass + Treble Boost | Potenciador de graves y agudos

Vocal Boost | Potenciador de voz

### HEADSET LED INDICATOR LED DE LOS AURICULARES

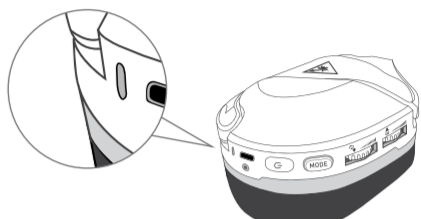

HEADSET LED	MEANING
Solid Green	Headset and Console Paired
Breathing Green	(While Charging) Battery Full
Double-Blink Green	Not Paired
Solid Red	(While Charging) Battery Charging
Breathing Red	Battery Low
ES VOYANT DU CASQUE	SIGNIFICADO
Verde constante	Auriculares y consola emparejados
Verde variable	(Durante la carga) Batería llena
Verde con doble parpadeo	No emparejados
Rojo constante	(Durante la carga) Cargando la batería
Rojo variable	Batería baja

### SETUP FOR XBOX CONFIGURACIÓN PARA XBOX

For new Xbox console setup instructions, go to: Instrucciones sobre la configuración en una Xbox nueva en: [turtlebeach.com/Xboxsetup](http://turtlebeach.com/Xboxsetup)

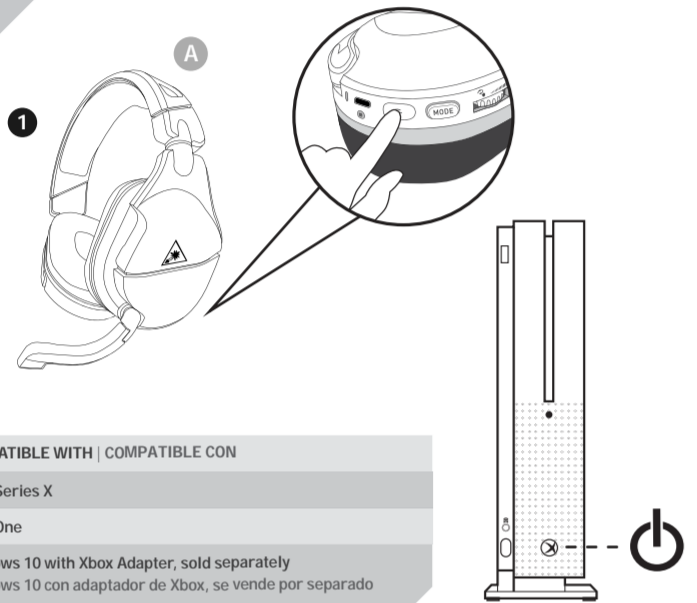

COMPATIBLE WITH | COMPATIBLE CON  
Xbox Series X  
Xbox One  
Windows 10 with Xbox Adapter, sold separately  
Windows 10 con adaptador de Xbox, se vende por separado

### SURROUND SOUND FOR XBOX (ONLY AVAILABLE ON XBOX) SONIDO ENVOLVENTE PARA XBOX (SOLO DISPONIBLE EN XBOX)

- EN 1. Go to Settings - General - Volume & Audio Output. 2. Set Headset Audio to Windows Sonic for Headphones.
- FR 1. Allez dans Paramètres - Général - Volume et sortie audio. 2. Réglez Son du casque sur Windows Sonic pour casque.
- ES 1. Ir a Configuración > General > Salida de volumen y sonido. 2. Selecciona Windows Sonic para auriculares en Sonido de los auriculares.
- DE 1. Gehe zu Einstellungen > Allgemein > Lautstärke & Audioausgabe. 2. Aktiviere Windows Sonic for Headphones für Headset-Audio.
- IT 1. Vai a Impostazioni > Generale > Volume e uscita audio. 2. Imposta audio cuffie su Windows Sonic per cuffie.
- PT 1. Vai a Definições > Geral > Saída de Áudio e Volume. 2. Configura o Áudio dos Auscultadores para Windows Sonic nos Auscultadores.
- SE 1. Gå till Inställningar > Allmänt > Volym och ljuddata. 2. Ställ in Windows Sonic for Headphones under Headsetljud.
- DK 1. Gå til Indstillinger > Generelt > Lydstyrke og lydoutput. 2. Indstil headsetets lyd til Windows Sonic for Headphones.
- NL 1. Ga naar Instellingen > Algemeen > Volume- en audio-uitvoer. 2. Stel Audio voor hoofdtelefoon in op Windows Sonic voor hoofdtelefoon.

For updated setup instructions visit: [turtlebeach.com/sonic](http://turtlebeach.com/sonic)

### SETUP FOR PC USE CONFIGURACIÓN PARA PC

SYNCING YOUR HEADSET (XBOX WIRELESS ADAPTER)\*  
EMPAREJAR TUS AURICULARES (ADAPTADOR INALÁMBRICO PARA XBOX)\*

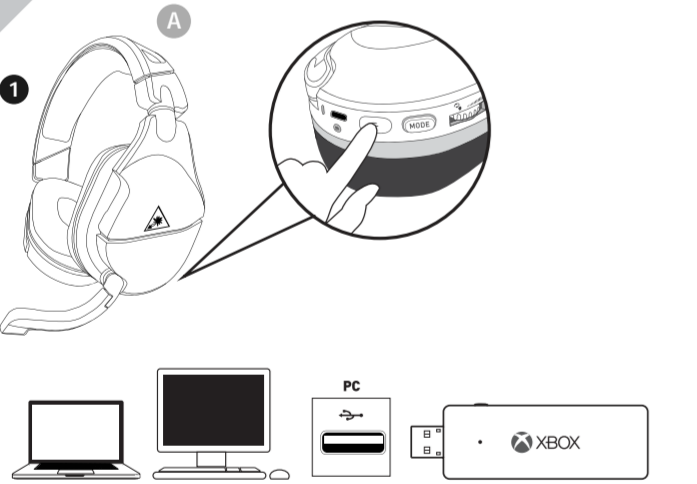

\*Xbox Wireless Adapter not included  
\*No incluye adaptador inalámbrico para Xbox

### SYNCING YOUR HEADSET (BUILT-IN XBOX WIRELESS) EMPAREJAR TUS AURICULARES (CONEXIÓN INALÁMBRICA A XBOX INCORPORADA)

- EN 1. On your PC, go to Settings > Devices > Connected Devices. a. Choose Add a device. Windows searches for the headset. 2. Press the connect button on your headset. Windows finds and adds the headset. 3. When your Stealth™ 600 headset appears in the list under Other devices, it is ready to use. 4. Configuring your settings > On the Windows Taskbar, right-click the Speaker icon, Select Playback Devices. a. Set TURTLE BEACH Stealth 600™ as your default device. b. Select Recording Devices, Set TURTLE BEACH Stealth 600™ as your default device.
- FR 1. Choisissez Ajouter un périphérique. Windows recherche le casque. 2. Appuyez sur le bouton Connexion de votre casque. Windows trouve le casque et l'ajoute. 3. Votre casque Stealth™ 600 est prêt à l'emploi lorsqu'il apparaît dans la liste Autres appareils. 4. Autres paramètres. a. Sélectionnez les paramètres, faites un clic droit sur l'icône de haut-parleur dans la barre des tâches de Windows et sélectionnez Périphériques de lecture a. Sélectionnez le casque TURTLE BEACH Stealth 600™ comme appareil par défaut. b. Sélectionnez Périphériques d'enregistrement, puis sélectionnez le casque TURTLE BEACH Stealth 600™ comme appareil par défaut.
- ES 1. En tu PC, ve a Configuración > Dispositivos > Dispositivos conectados. a. Elige Añadir un dispositivo. Windows buscará los auriculares. 2. Pulsa el botón de conectar en los auriculares. Windows buscará y añadirá los auriculares. 3. Cuando los auriculares Stealth™ 600 aparecen en la lista de Otros dispositivos, estarán listos para usarse. 4. Para configurar > En la barra de tareas de Windows, haz clic derecho en el icono del altavoz, selecciona Dispositivos de reproducción a. Configura Stealth 600™ de TURTLE BEACH como dispositivo predeterminado. b. Selecciona Dispositivos de grabación, configura Stealth 600™ de TURTLE BEACH como dispositivo predeterminado.
- DE 1. Wählen Sie auf Ihrem PC Einstellungen > Geräte > Angeschlossene Geräte. a. Wählen Sie „Gerät hinzufügen“. Windows sucht jetzt nach dem Headset. 2. Drücken Sie den Knopf „Connect“ (Anschließen) auf Ihrem Headset. Windows findet das Headset und fügt es hinzu. 3. Sobald Ihr „Stealth™ 600 Headset in der Liste unter „Andere Geräte“ angezeigt wird, kann es benutzt werden. 4. Einstellungen konfigurieren > Rechtsklicken Sie das Lautsprechersymbol in der Windows Taskleiste und wählen Sie „Wiedergabegeräte“ a. Wählen Sie TURTLE BEACH Stealth 600™ als Ihr Standardgerät. b. Wählen Sie „Aufnahmegeräte“ und legen Sie TURTLE BEACH Stealth 600™ als Ihr Standardgerät fest.
- IT 1. Sul PC, seleziona Impostazioni > Dispositivi > Dispositivi connessi. a. Scegliere Aggiungi un dispositivo. Windows cerca le cuffie. 2. Premere il pulsante di connessione sulle cuffie. Windows trova e aggiunge le cuffie. 3. Quando le cuffie Stealth™ 600 compaiono nella lista sotto Altri dispositivi, vuol dire che sono pronte per l'utilizzo. 4. Configurazione delle impostazioni > Sulla barra delle applicazioni di riproduzione, fare doppio clic sull'icona dell'altoparlante, selezionare Periferiche di riproduzione a. Impostare TURTLE BEACH Stealth 600™ come dispositivo predefinito. b. Selezionare Periferiche di registrazione, impostare TURTLE BEACH Stealth 600™ come dispositivo predefinito.
- SE 1. Gå till Inställningar > Enheter > Ljudenheter på din dator. a. Välj Lägg till enhet. Windows börjar nu söka efter headsetet. 2. Tryck på anslutningsknappen på headsetet. Windows hittar och lägger till headsetet. 3. När Stealth™ 600-headsetet visas under Andra enheter är det redo att användas. 4. Göra inställningar > Högerklicka på högtalarkonken i aktivitetsfältet och välj Uppspelningsenheter a. Välj TURTLE BEACH Stealth 600™ som din standardenhet. b. Gå till fliken Inspelning och välj TURTLE BEACH Stealth 600™ som din standardenhet.

Headset volume is controlled through Windows 10 when used on a PC. El volumen de los auriculares se controla mediante Windows 10 cuando se usan en PC. Los ajustes de volumen en los auriculares no tienen efecto.

### Regulatory Compliance Statements for the Stealth™ 600X Gen 2

**Local Restrictions on 802.11a, 802.11b, 802.11g and 802.11n Radio Usage**  
Caution: Due to the fact that the frequencies used by 802.11a, 802.11b, 802.11g and 802.11n wireless LAN devices may not yet be harmonized in all countries, 802.11a, 802.11b, 802.11g and 802.11n products are designed for use only in specific countries, and are not allowed to be operated in countries other than those of designated use. As a user of these products, you are responsible for ensuring that the products are used only in the countries for which they were intended and for verifying that they are configured with the correct selection of frequency and channel for the country of use. Any deviation from the permissible power and frequency settings for the country of use is an infringement of national law and may be punished as such.

To determine whether you are allowed to use your wireless network device in a specific country, please check to see if the radio type number that is printed on the identification label of your device is listed in the manufacturer's OEM Regulatory Guidance document at the following URL: <http://www.turtlebeach.com/homologation> or contact Turtle Beach directly.

**Federal Communications Commission (FCC) Compliance Notices**  
This section includes the following FCC statements for the Stealth™ 600X Gen 2:  
• Class B Interference Statement  
• RF Radiation Exposure & Hazard Warning  
• Unlicensed National Information Infrastructure Bands Operation Statement

**Class B Interference Statement**  
This equipment has been tested and found to comply with the limits for a Class B digital device, pursuant to Part 15 of the FCC Rules. These limits are designed to provide reasonable protection against harmful interference in a residential installation. This equipment generates, uses, and can radiate radio frequency energy and, if not installed and used in accordance with the instructions, may cause harmful interference to radio communications. However, there is no guarantee that interference will not occur in a particular installation. If this equipment does cause harmful interference to radio or television reception, which can be determined by turning the equipment off and on, the user is encouraged to try to correct the interference by one or more of the following measures:  
• Reorient or relocate the receiving antenna.  
• Increase the separation between the equipment and receiver.  
• Connect the equipment into an outlet on a circuit different from that to which the receiver is connected.  
• Consult the dealer or an experienced radio/TV technician for help.

**FCC Caution:**  
This device complies with Part 15 of the FCC Rules. Operation is subject to the following two conditions: (1) This device may not cause harmful interference, and (2) this device must accept any interference received, including that which may cause undesired operation.

**RF Radiation Exposure & Hazard Statement**  
To ensure compliance with FCC RF exposure requirements, this device must be installed in a location such that the antenna of the device will be greater than 2 cm (0.8 in.) from all persons. Using higher gain antennas and types of antennas not covered under the FCC certification of this product is not allowed. Installers of the radio and end users of the product must adhere to the installation instructions provided in this manual. This transmitter must not be co-located or operated in conjunction with any other antenna or transmitter.

**Non-Modification Statement**  
Use only the supplied internal antenna. Unauthorized antennas, modifications, or attachments could damage the Stealth™ 600X Gen 2 and violate FCC regulations. Any changes or modifications not expressly approved by the party responsible for compliance could void the user's authority to operate this equipment. Please contact Turtle Beach for a list of approved 2.4 GHz and 5.0 GHz antennas.

**Unlicensed National Information Infrastructure (U-NII) Bands Operation Statement**  
Within the 5.25-5.35 GHz band, U-NII devices will be restricted to indoor operations to reduce any potential for harmful interference to co-channel MSS operations.  
The U-NII devices shall accept any interference from legal communications and shall not interfere with the legal communications. If interference is caused, the user must stop operating the device immediately and cannot resume operation until the harmful interference is clear.  
Manufacturers of U-NII devices are responsible for ensuring frequency stability such that an emission is maintained within the band of operation under all conditions of normal operation as specified in this user manual.

**Dynamic Frequency Selection (DFS)**  
U-NII devices operating in the 5.25-5.35 GHz and 5.47-5.725 GHz bands shall employ a DFS radar detection mechanism to detect the presence of radar systems and to avoid co-channel operation with radar systems in order to reduce the likelihood of interference to radar. The modification of wireless broadband and other transmitter devices to operate on unauthorized frequencies or the disabling of DFS capabilities is a violation of FCC rules and may result in unlawful interference to radio communications services critical to public safety. This product is compliant with the Consumer Product Safety Improvement Act of 2008, Public Law 110-314 (CPSIA)

**Canadian ICES Statements IC: 3879A-2315 (Stealth™ 600X Gen 2)**  
This device complies with ICES-003 and RSS-247 of Industry Canada. Operation is subject to the following two conditions:  
1. This device must not cause interference, and  
2. This device must accept any interference, including interference that may cause undesired operation of the device.

**Ce dispositif est conforme aux normes NMB003 et CNR-247 Industriale Canada.**  
1. L'utilisation de ce dispositif est autorisée seulement aux conditions suivantes.  
2. Il ne doit pas produire de brouillage et l'utilisateur du dispositif doit être prêt à accepter tout brouillage radioélectrique reçu, même si ce brouillage est susceptible de compromettre le fonctionnement du dispositif.

To prevent radar interference to the licensed service (i.e. co-channel Mobile Satellite systems) this device is intended to be operated indoors and away from windows to provide maximum shielding. Equipment (or its transmitter antenna) that is installed outdoors is subject to licensing and not supported by Stealth™ 600X Gen 2 Models.  
Pour éviter les interférences radio au service agréé (i.e. à-d. Les systèmes par satellite mobile co-canal), cet appareil est destiné à fonctionner à l'intérieur et à l'éloigner des fenêtres pour assurer un blindage maximal. L'équipement (ou son antenne d'émission) installé à l'extérieur est soumis à l'octroi de licences et n'est pas pris en charge par les modèles Stealth™ 600X Gen 2.

**RF Radiation Exposure & Hazard Statement**  
To ensure compliance with RSS-102 RF exposure requirements, this device must be installed in a location such that the antenna of the device will be greater than 2 cm (0.8 in.) away from all persons. Using higher gain antennas and types of antennas not covered under the IC certification of this product is not allowed. Installers of the radio and end users of the product must adhere to the installation instructions provided in this manual. This transmitter must not be co-located or operated in conjunction with any other antenna or transmitter.

**Exposition aux radiations RF & Mention de danger**  
Pour assurer la conformité avec les exigences RSS-102 d'exposition aux RF (Radio Fréquences), cet appareil doit être installé dans un endroit où l'antenne de l'appareil sera située à une distance de plus de 2 cm (0,8 po) de toutes les personnes. L'utilisation d'antennes à gain plus élevé et les types d'antennes qui ne sont pas couverts en vertu de la certification IC de ce produit n'est pas autorisée. Les installateurs de la radio et les utilisateurs du produit final doivent se conformer aux instructions d'installation fournies dans ce manuel. Cet émetteur ne doit pas être co-implanté ou exploité en conjonction avec toute autre antenne ou transmetteur.

**Declaration of Conformity**  
Marking by this symbol:  
Indicates compliance with the Essential Requirements of the Radio Equipment Directive (RED) of the European Union (2014/53/EU). This equipment meets the following conformity standards:  
**Safety:** EN 60950-1: 2006 + A11: 2009 + A1: 2010 + A12: 2011 + A2: 2013 (T-Mark License), IEC 60950-1: 2005 (2nd Ed.) - Am 1: 2009 - Am 2: 2013 (CB Scheme Certificate), EN 62368-1: 2014 + A11 (T-Mark License), IEC 62368-1: 2014 (CB Scheme Certificate), EN 50332-1: 2013, EN 50332-2: 2013, EN 71-3: 2013  
Additional licenses issued for specific countries available upon request  
**EMC:** EN 55032: 2015, CISPR 32: 2015, EN 301 489-1 V2.1.1 (2017-02), EN 301 489-17 V3.1.1 (2016-11), EN 61000-4-2: 2009, EN 61000-4-3: 2006 + A1: 2008 + A2: 2010, EN 61000-4-8: 2010  
The products are licensed, as required, for additional country specific standards for the International Marketplace. Additional issued licenses available upon request.  
**Radio:** EN 300 328 V2.1.2 (2019-07), EN 301 893 V2.1.1 (2017-05)  
**SAR:** EN 62311: 2008  
**Environment:** RoHS 2015/863 amending Annex II to 2011/65/EU, WEEE 2012/19/EU, REACH 2006/1907/EC, Packaging 94/62/EC, Battery 2006/66/EC, Toys Safety Directive 2009/48/EC  
**Warning!** This is a Class B product. In a domestic environment, this product may cause radio interference, in which case, the user may be required to take appropriate measures.  
**Attention!** Dieses ist ein Gerät der Funkströmungsstärkeklasse B. In Wohnbereichen können bei Betrieb dieses Gerätes Rundfunkstörungen auftreten, in welchen Fällen der Benutzer für entsprechende Gegenmaßnahmen verantwortlich ist.  
**Attention!** Ceci est un produit de Classe B. Dans un environnement domestique, ce produit risque de créer des interférences radioélectriques, il appartient alors à l'utilisateur de prendre les mesures spécifiques appropriées.

**Déclaration de conformité**  
Ce produit est certifié pour le déploiement à l'intérieur tout en respectant les limites de cette bande de fréquences: 5150-5250 MHz. Ne pas installer ou utiliser ce produit à l'extérieur au Canada, si cette bande de fréquences ne peut être rencontrée.

**Operation in the Frequency Bands 5470-5725 MHz and 5725-5850 MHz**  
Until further notice, devices subject to this section shall not be capable of transmitting in the band from 5600-5650 MHz. This restriction is for the protection of Environment Canada's weather radars operating in the list under Other devices, it is ready to use. 4. Configuring your settings > On the Windows Taskbar, right-click the Speaker icon, Select Playback Devices. a. Set TURTLE BEACH Stealth 600™ as your default device. b. Select Recording Devices, Set TURTLE BEACH Stealth 600™ as your default device.

**Fonctionnement dans les bandes de fréquence 5470-5725 MHz et 5725-5850 MHz**  
Jusqu'à nouvel avis, les appareils soumis à cette section ne doivent pas être transmis dans la bande de 5600-5650 MHz. Cette restriction concerne la protection des radars météorologiques d'Environnement Canada opérant dans cette bande. Les utilisateurs des séries qui les utilisateurs de radars de haute puissance sont désignés utilisateurs principaux (c.-à-d., qu'ils ont la priorité) pour les bandes 5250-5350 MHz et 5650-5850 MHz et que ces radars pourraient causer du brouillage et/ou des dommages aux dispositifs LAN-EL.

**European Union and European Fair Trade Association Regulatory Compliance**  
This equipment may be operated in the countries that comprise the member countries of the European Union and the European Fair Trade Association. These countries, listed below, are referred to as The European Community throughout this document.  
AUSTRIA, BELGIUM, BULGARIA, CYPRUS, CZECH REPUBLIC, DENMARK, ESTONIA, FINLAND, FRANCE, GERMANY, GREECE, HUNGARY, IRELAND, ITALY, LITHUANIA, LUXEMBOURG, MALTA, NETHERLANDS, POLAND, PORTUGAL, ROMANIA, SLOVAKIA, SLOVENIA, SWEDEN, SWITZERLAND, UNITED KINGDOM, ICELAND, LICHTENSTEIN, NORWAY, SWITZERLAND

**Declaration of Conformity**  
Marking by this symbol:  
Indicates compliance with the Essential Requirements of the Radio Equipment Directive (RED) of the European Union (2014/53/EU). This equipment meets the following conformity standards:  
**Safety:** EN 60950-1: 2006 + A11: 2009 + A1: 2010 + A12: 2011 + A2: 2013 (T-Mark License), IEC 60950-1: 2005 (2nd Ed.) - Am 1: 2009 - Am 2: 2013 (CB Scheme Certificate), EN 62368-1: 2014 + A11 (T-Mark License), IEC 62368-1: 2014 (CB Scheme Certificate), EN 50332-1: 2013, EN 50332-2: 2013, EN 71-3: 2013  
Additional licenses issued for specific countries available upon request  
**EMC:** EN 55032: 2015, CISPR 32: 2015, EN 301 489-1 V2.1.1 (2017-02), EN 301 489-17 V3.1.1 (2016-11), EN 61000-4-2: 2009, EN 61000-4-3: 2006 + A1: 2008 + A2: 2010, EN 61000-4-8: 2010  
The products are licensed, as required, for additional country specific standards for the International Marketplace. Additional issued licenses available upon request.  
**Radio:** EN 300 328 V2.1.2 (2019-07), EN 301 893 V2.1.1 (2017-05)  
**SAR:** EN 62311: 2008  
**Environment:** RoHS 2015/863 amending Annex II to 2011/65/EU, WEEE 2012/19/EU, REACH 2006/1907/EC, Packaging 94/62/EC, Battery 2006/66/EC, Toys Safety Directive 2009/48/EC  
**Warning!** This is a Class B product. In a domestic environment, this product may cause radio interference, in which case, the user may be required to take appropriate measures.  
**Attention!** Dieses ist ein Gerät der Funkströmungsstärkeklasse B. In Wohnbereichen können bei Betrieb dieses Gerätes Rundfunkstörungen auftreten, in welchen Fällen der Benutzer für entsprechende Gegenmaßnahmen verantwortlich ist.  
**Attention!** Ceci est un produit de Classe B. Dans un environnement domestique, ce produit risque de créer des interférences radioélectriques, il appartient alors à l'utilisateur de prendre les mesures spécifiques appropriées.

**National Restrictions**  
Indoor Operation The Stealth™ 600X Gen 2 operates in the 5150 to 5350 MHz frequency band and is restricted to indoor use only!  
**Antenna** The Stealth™ 600X Gen 2 has integrated antennas which cannot be replaced.  
**Power Level Control** The Stealth™ 600X Gen 2 does not allow for customized power level control.  
**Operating Frequency** The operating frequency of the Stealth™ 600X Gen 2 is determined by the host console system. As such, it is important that the host console system is correctly configured to meet the local regulations.  
**Recycling** This symbol on the product or its packaging indicates that this product must not be disposed of with your other household waste. It is your responsibility to dispose of your waste equipment by handing it over to a designated collection point for the recycling of waste electrical and electronic equipment. The separate collection and recycling of your waste equipment at the end of its useful life will help conserve natural resources and ensure that it is recycled in a manner that protects human health and the environment. For more information about where you can drop off your waste for recycling, please contact your local authority, or where you purchased your product.  
**Turtle Beach Europe, Ltd is obligated as a producer with a main activity of selling under the Producer Responsibility Obligations (Packaging Waste) Regulations 2007. To fulfil our obligation we are registered with Comply Direct and their Recycling Home. Here you will find advice and information on packaging waste management, recycling symbols and the waste hierarchy principles of reduce, reuse and recycle. <https://www.complydirect.com/the-recycling-room/>**  
Please visit the following URL, for a complete copy of the Declaration of Conformity: <http://www.turtlebeach.com/homologation>

**Mexican IFT-008 Compliance Statement**  
\*La operación de este equipo está sujeta a las siguientes dos condiciones: (1) es posible que este equipo o dispositivo no cause interferencia perjudicial y (2) este equipo o dispositivo debe aceptar cualquier interferencia, incluyendo la que pueda causar su operación no deseada.\*

### To access the rating label: Para acceder a la etiqueta de evaluación:

1. Remove the left ear pad by pulling the ear pad straight up using your thumb.  
1. Quitar la almohadilla izquierda al jalarla directamente hacia arriba con el pulgar.
2. Once you've released the cloth from the top on top, pull the ear pad straight back and it should slip right off.  
2. Cuando hayas separado la tela de la orilla en la parte superior, jala la almohadilla directamente hacia abajo, y entonces se debe salir fácilmente de su lugar.

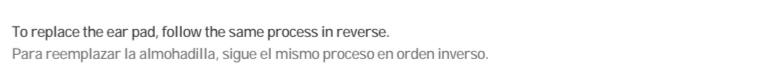

To replace the ear pad, follow the same process in reverse. Para reemplazar la almohadilla, sigue el mismo proceso en orden inverso.

### Not seeing what you're looking for here? Visit [turtlebeach.com/support](http://turtlebeach.com/support) for the latest Tech Support information.

¿Tienes alguna duda?  
Visita [turtlebeach.com/pages/servicio-asistencia](http://turtlebeach.com/pages/servicio-asistencia) para obtener la información más reciente de soporte técnico.