

Length table:

Part NO.(F)	Length:mm	COLOR(C)
RUSBCLTMM1MB	1000±30	BLACK
RUSBCLTMM2MB	2000±30	BLACK
RUSBCLTMM1MW	1000±30	WHITE
RUSBCLTMM2MW	2000±30	WHITE

(A). Wire Pin Assignment and Wire Description:

	CN.1	Signal Name	CN.2	COLOR
	A4,B4,A9,B9	PWR_Vbus1	1	RED
	A5	USB_CC	4	BLUE
	A7	UTP_Dn	2	WHITE
	A6	UTP_Dp	3	GREEN
SHORT	A1,B1,A12,B12	GND_PWRrt1	5	GND
	SHELL	SHELL	SHELL	BRAID

(B). Electrical Testing :

- HI-POT: 5V DC
- Electric current: 2.4A

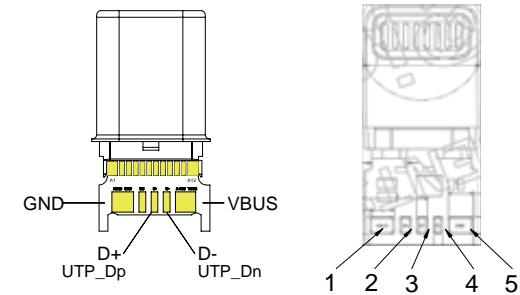

soldering view

ITEM	MATERIALS LIST & SPEC. DESCRIPTION	Q'TY
④	MOLDED TPE COLOR(C)	/
③	LIGHTNING PLUG C94, (TERMINAL:GOLD PLATED, SHELL:Ni-PLATED)	1PCS
②	USB 2.0 TYPE C MALE, (TERMINAL:GOLD PLATED, SHELL:Ni-PLATED)	1PCS
①	USB 2.0 [32AWGx2C+22AWGx1C+32AWGx1C+2E]+AB OD:3.1mm JACKET TPE COLOR(C)	/

THIRD ANGLE PROJECTION

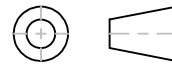

GENERAL NOTES

DIMENSIONS ARE IN MM - DO NOT SCALE
THIS DOCUMENT CONTAINS CONFIDENTIAL, PROPRIETARY INFORMATION THAT IS PROPERTY OF STARTECH.COM

StarTech.com

PRODUCT ID	RUSBCLTMMxMy		
DESCRIPTION	Durable USB Type-C to Lightning Cable, Aramid Fiber, EMI Protection		
REV: A	DO NOT SCALE	SHEET : 1 OF: 1	DATE: 05/01/2020