

# CONTENTS

- 1 / English
- 3 / Español
- 5 / Français
- 7 / Português

English

**PoE Injector Only** The PoE Injector supplies steady power and data connectivity to a powered device through an Ethernet cable.

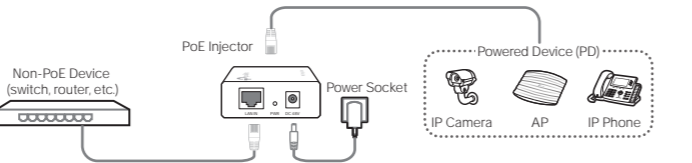

**PoE Splitter Only** The PoE Splitter can be used with a PoE/PoE+ switch to deliver direct current (DC) power and data to a Non-PoE device.

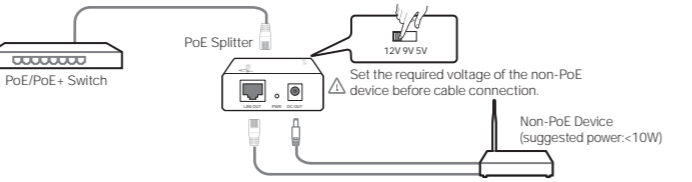

1

English

**PoE Injector & Splitter** The PoE injector and PoE splitter can be used as a kit to supply power and transmit data to a Non-PoE device.

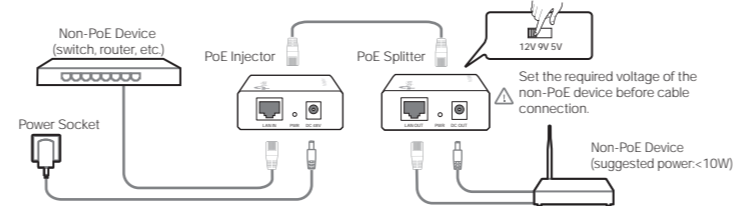

**PoE Extender** PoE Extender is used to extend the network connection from the PoE power source equipment.

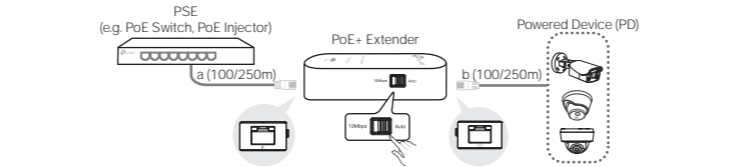

2

Español

**Únicamente Inyector PoE** El inyector PoE suministra corriente eléctrica estable y conectividad de datos a un dispositivo alimentado mediante un cable Ethernet.

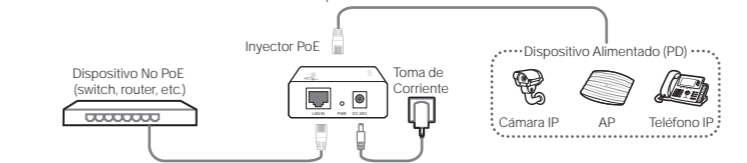

**Únicamente Splitter PoE** El Splitter PoE puede ser usado con un switch PoE/PoE+ para entregar corriente directa (DC) y datos a un Dispositivo No PoE.

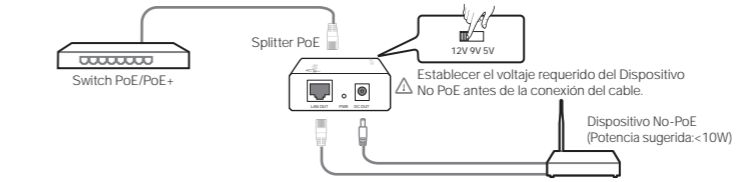

3

Español

**Inyector y Splitter PoE** El inyector PoE y el Splitter PoE pueden ser usados como un kit para suministrar energía y transmitir datos a un Dispositivo No PoE.

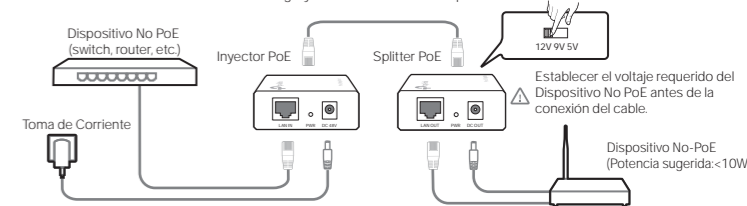

**Extensor PoE** El Extensor PoE se utiliza para ampliar la conexión de red desde el equipo de fuente de alimentación PoE.

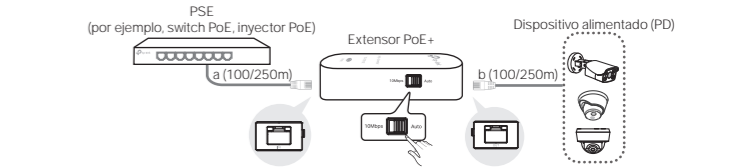

4

**Injecteur PoE** L'injecteur PoE fournit une alimentation stable et la connectivité réseau à un appareil alimentable par un cordon Ethernet.

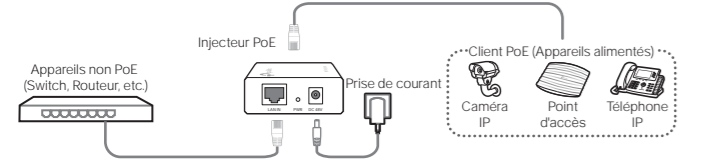

**Splitter PoE** Le splitter PoE (...) peut être utilisé avec un switch PoE/PoE+ pour alimenter un appareil réseau non PoE en données et en courant continu (CC).

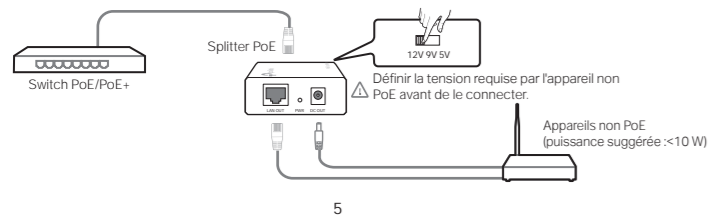

5

**Injecteur et Splitter PoE** L'injecteur et le splitter PoE peuvent être utilisés tel un kit pour alimenter et relier un appareil réseau non PoE.

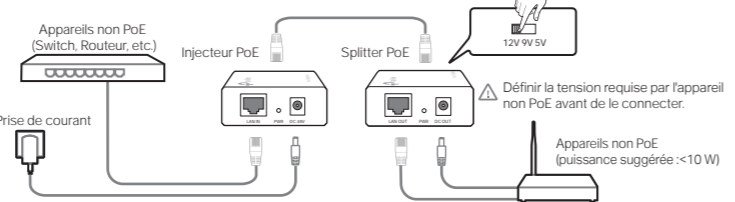

**Extenseur PoE** L'extenseur PoE est utilisé pour étendre la connexion réseau à partir de l'équipement de source d'alimentation PoE.

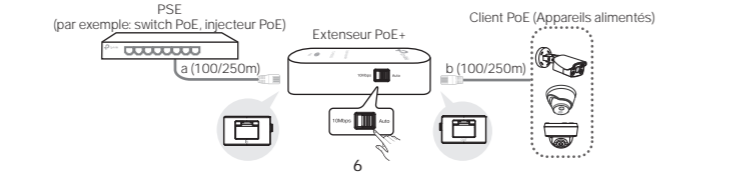

6

**Somente Injetor PoE** O Injetor PoE oferece energia estável e conectividade de dados à um dispositivo alimentado por um cabo Ethernet.

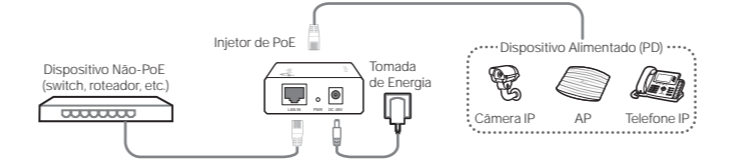

**Somente Splitter PoE** O Splitter PoE pode ser utilizado com um switch para oferecer corrente direta (DC) e dados para um dispositivo não-PoE.

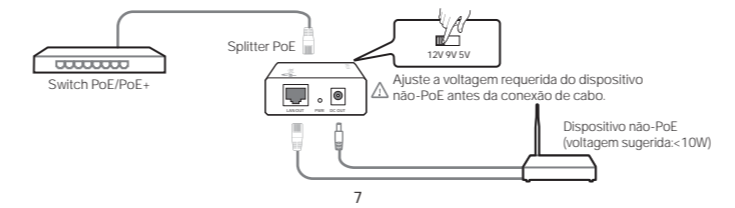

7

**Splitter e Injetor PoE** O injetor e o splitter PoE podem ser utilizados como um kit para suprir energia e transmitir dados para um dispositivo não-PoE.

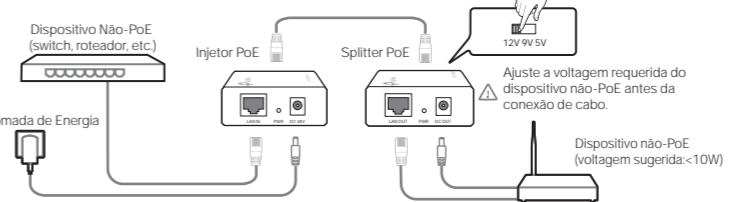

**Extensor PoE** Extensor PoE é usado para estender a conexão de rede a partir de um dispositivo com fonte PoE.

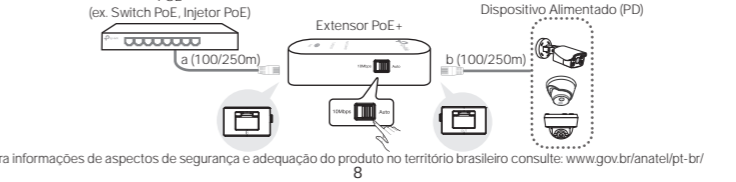

8

Para informações de aspectos de segurança e adequação do produto no território brasileiro consulte: [www.gov.br/anatel/pt-br/](http://www.gov.br/anatel/pt-br/)



# Installation Guide Guía de Instalación Guide d'installation Guia de Instalação

PoE Injector  
PoE Splitter  
PoE Extender

\*Images may differ from actual products.