

# Installation Guide

RJ45 SFP / RJ45 SFP+ Module

-  To ask questions, find answers, and communicate with TP-Link users or engineers, please visit <https://community.tp-link.com> to join TP-Link Community.
-  For technical support and other information, please visit <https://www.tp-link.com/support>, or simply scan the QR code.
-  If you have any suggestions or needs on the product guides, welcome to email [techwriter@tp-link.com.cn](mailto:techwriter@tp-link.com.cn).



Note: Images may differ from the actual products.

## Installing the RJ45 SFP / RJ45 SFP+ Module

1. Lock the yellow latch into place and insert the module into an SFP / SFP+ slot with label side up.

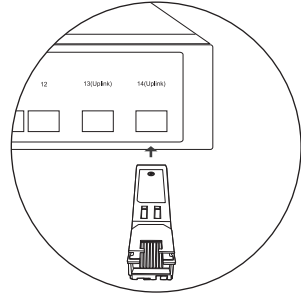
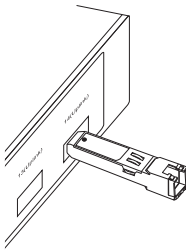

2. Gently push the module into the slot until you hear a click. Then, insert the RJ45 network cable.

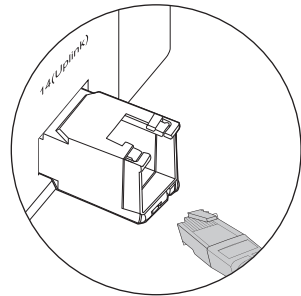
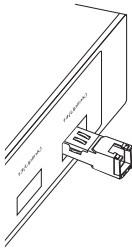

## Removing the RJ45 SFP / RJ45 SFP+ Module

1. Press the RJ45 crystal head and pull out the cable.

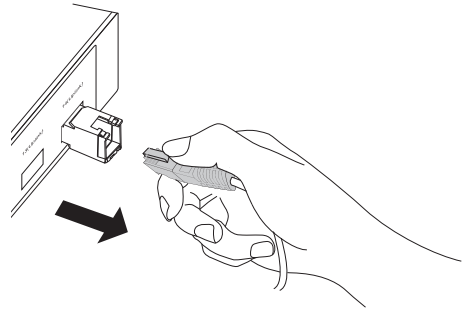
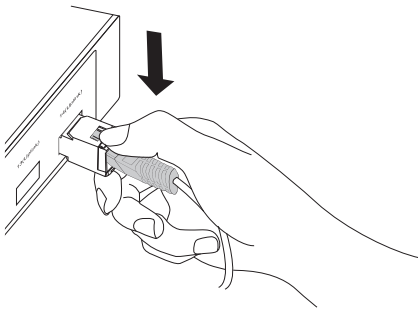

2. Pull down the latch and remove the module.

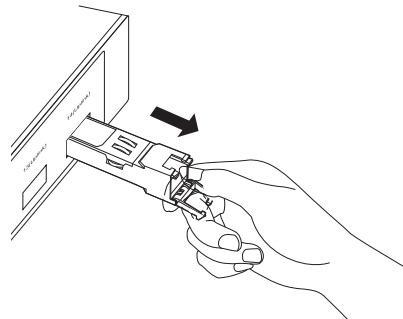
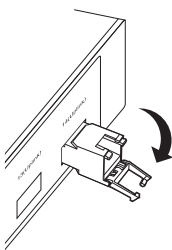

# Positioning the 10G RJ45 SFP+ Modules

The 10G RJ45 SFP+ modules consume more power than optical modules. This may result in higher heat. To avoid overheating, it is recommended to place the modules separated by multiple optical transceivers or empty slots. When used in high temperature environments, additional cooling must be applied.

The figures below only show the recommended positioning. The actual number of modules that can be inserted depends on the switch's heat dissipation and power margin.

## Scenario 1:

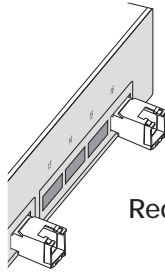

Recommended

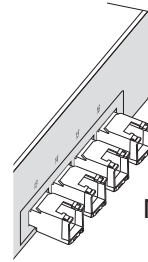

Not Recommended

## Scenario 2:

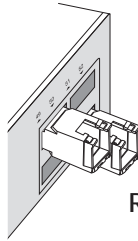

Recommended

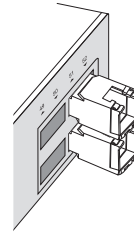

Not Recommended

# Specifications

## General Specifications

Normal	TL-SM331T	TL-SM5310-T
Standards and Protocols	IEEE 802.3 IEEE 802.3ab IEEE 802.3bz SFF-8472	IEEE 802.3 IEEE 802.3u IEEE 802.3ab IEEE 802.3bz IEEE 802.3an SFF-8472 SFF-8431
MAC Interface	1000BASE-X	XFI
Data Rate <sup>1</sup> (max.)	1.25 Gbps	10.3125 Gbps
Power Consumption (max.)	0.8 W	2.5 W
Cable Distance	1000BASE-T: UTP cat.5e or above (max. 100m)	100BASE-TX: UTP cat.5 or above (max. 100m) 1000BASE-T/2.5GBASE-T/5GBASE-T: UTP cat.5e or above (max. 100m) 10GBASE-T: UTP cat.6a or above (max. 30m)
RX_LOS	/	/
TX_Fault	/	/
TX_Disable	Yes	Yes
Hot Swappable	Yes	Yes
LLF	/	/
LFP	/	/
DDM	/	Yes (temperature and voltage)

## Environmental and Physical Specifications

Product Operating Temperature	0 °C to 70 °C (32 °F to 158 °F)
Storage Temperature	-40 °C to 85 °C (-40 °F to 185 °F)
Operating Humidity	10% to 90% RH, Non-condensing
Storage Humidity	5% to 90% RH, Non-condensing

## Compatibility

Normal	TL-SM331T	TL-SM5310-T
Gigabit SFP Slot (SFP Slot)	Supported	/
10G SFP+ Slot (SFP+ Slot)	Supported <sup>2</sup>	Supported <sup>3</sup>

We recommend that you use only TP-Link modules on your TP-Link devices.

To check the compatible TP-Link devices of your module, please visit our website:

- TL-SM331T:  
<https://www.tp-link.com/tl-sm331t/product-list/>



- TL-SM5310-T:  
<https://www.tp-link.com/tl-sm5310-t/product-list/>



### Note:

- TL-SM331T does not support the data rate of 10 Mbps or 100 Mbps. TL-SM5310-T does not support the data rate of 10 Mbps, but supports 100 Mbps / 1 Gbps / 2.5 Gbps / 5 Gbps / 10 Gbps.
- When a Gigabit RJ45 SFP module is inserted into a 10 Gbps SFP+ slot, extra configuration may be required.
- When the 10G RJ45 SFP+ module is inserted into a 10 Gbps SFP+ slot and the maximum rate of the peer connection port is 5 Gbps, 2.5 Gbps, 1 Gbps, or 100 Mbps, the flow control for the 10 Gbps SFP+ slot needs to be manually enabled.

## Safety Information

- Keep the device away from water, fire, humidity or hot environments.
- Do not touch the device while it is operating.
- To prevent potential risks caused by heat, do not place your network device on non-heat-resistant paper, cloth, fabrics, plastics, or any other surface that doesn't provide space beneath your device for heat dissipation.
- The air flow around the device should be increased, or the overall ambient temperature should be lowered to keep the temperature of the modules within the recommended range.
- Do not attempt to disassemble, repair, or modify the device. If you need service, please contact us.

## EU Declaration of Conformity

TP-Link hereby declares that the device is in compliance with the essential requirements and other relevant provisions of directives 2014/30/EU, 2014/35/EU, 2009/125/EC, 2011/65/EU and (EU)2015/863.

The original EU declaration of conformity may be found at <https://www.tp-link.com/en/support/ce>.

## UK Declaration of Conformity

TP-Link hereby declares that the device is in compliance with the essential requirements and other relevant provisions of the Electromagnetic Compatibility Regulations 2016 and Electrical Equipment (Safety) Regulations 2016.

The original UK Declaration of Conformity may be found at <https://www.tp-link.com/support/ukca>

