



HP LaserJet M110we Printer

The world's smallest laser in its class¹ designed for efficiency with fast printing and the time-saving HP Smart app.^{2,3} Includes HP+, the smart printing system that keeps you connected and ready to print from virtually anywhere.²



This is an HP+ printer. It requires an HP account, connection to the internet, and exclusive use of Original HP Toner cartridges for the life of the printer. More at: <http://www.hp.com/plus-faq>

Highlights

- The world's smallest laser printer in its class
- HP+, the cloud-connected, smart printing system
- Instant Ink for toner service available
- Quality and reliability you expect from industry leader
- Print speed up to 20 ppm
- Intuitive, easy to use
- Easy mobile printing and scanning with the HP Smart App
- HP Smart App; Apple AirPrint™; Mopria™ Certified; Wi-Fi® Direct Printing
- HP Auto-On/Auto-Off technology

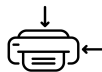

The world's smallest laser in its class

- The world's smallest laser in its class¹ designed for efficient performance.
- Business doesn't need to wait for your printer. Maximize your uptime with print speeds up to 21/20ppm.⁴
- Get wireless with self-reset to help you stay connected.⁵
- Smartly and elegantly designed, so it's simple and intuitive to use.

Never run out⁶ and save up to 50%⁷ with Instant Ink for laser printing

- Never run out of toner for your laser printer.⁶ Convenient toner replacements and smart delivery included.
- Save up to 50% with Instant Ink.⁷ Enroll to get toner, delivery and recycling.
- Peace of mind with plan flexibility to change or cancel anytime at no cost.⁸
- Help us put plastic back into printers with prepaid recycling service included.⁹

HP+ Smart printing has arrived

- This cloud-connected HP+ printer is smarter - it keeps itself up to date and ready to print.¹⁰
- First 6 months of Instant Ink included¹¹; after 6 months, monthly fee charged automatically unless cancelled.
- Print and scan from the palm of your hand. Enjoy advanced productivity features for 2 years with HP+.²
- For every page you print with HP+, HP protects or restores forests in equal measure.¹²

Stay productive from anywhere

- Get high-quality scanning, and share to Dropbox, Google Drive, or email – from virtually anywhere.²
- Print documents and images directly from Dropbox and Google Drive with HP Smart app.²
- Save time by sending a secure fax from your smartphone, tablet, or PC with HP Smart app.²
- Eliminate steps in repetitive tasks with Shortcuts.² Scan to the cloud, email, and more in just a tap.²

Product walkaround

HP LaserJet M110we Printer shown

1. Intuitive Control Panel
2. 150 sheet Input Tray
3. 100 sheet Output Bin
4. World's Smallest Laser in its Class

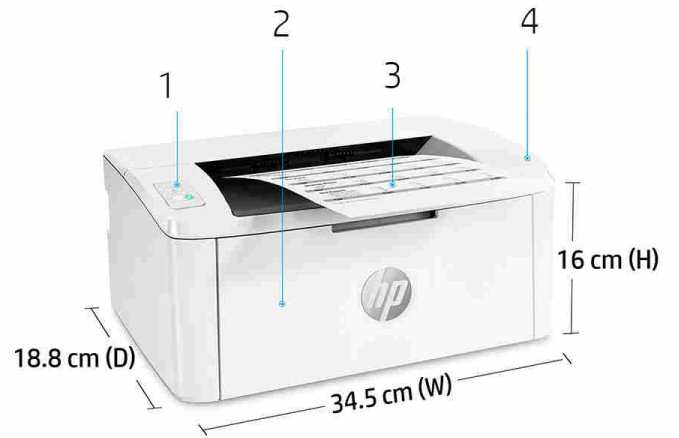

Accessories, Supplies and Support

Supplies	W1420A HP 142A Black Original LaserJet Toner Cartridge (950 pages)
Accessories	
Service and Support	<p>U31VWE HP 3 year Care Pack with Standard Exchange for LaserJet Printers</p> <p>U31VXE HP 3 year Care Pack with Next Day Exchange for LaserJet Printers</p> <p>U31W1E HP 3 year Care Pack with Return to Depot Support for LaserJet Printers (U31VWE: all EMEA countries, except ME, Africa, South Africa, Israel, Turkey (U31VXE: Austria, Belgium, Denmark, Finland, France, Germany, Ireland, Italy, Netherlands, Norway, Portugal, Spain, Sweden, Switzerland, UK, Czech, Greece, Hungary, Poland, Slovakia U31W1E: ME, Africa, South Africa, Israel, Turkey)</p>

Technical specifications

Model	HP LaserJet M110we Printer
Product number	7MD66E
Functions	Print
Control panel	3 LEDs (Attention, Ready, Wireless); 3 buttons (Cancel, Power, wireless)
Print	
Print technology	Laser
Print speed ¹	Black (A4, normal): Up to 20 ppm
First page out ²	Black (A4, ready): As fast as 8.5 sec ; Black (A4, sleep): As fast as 9.1 sec
Print resolution	Black (best): Up to 600 x 600 dpi; Technology: HP FastRes 600
Monthly duty cycle	Up to 8,000 pages A4; Recommended monthly page volume: 100 to 1000
Printer smart software features ^{3,4}	HP Auto-On/Auto-Off ¹ , HP Smart App ²
Standard print languages	PCLm/PCLm5; URF; PWG
Print area	Print margins Top: 2 mm, Bottom: 2 mm, Left: 2 mm, Right: 2 mm; Maximum print area : 216 x 355.6mm
Duplex printing	No
Processor speed	500 MHz
Connectivity	
Standard	802.11b/g/n (2.4 GHz) Wi-Fi radio
Mobile printing capability ⁵	HP Smart App; Apple AirPrint™; Mopria™ Certified; Wi-Fi® Direct printing
Supported network protocols	TCP/IP; IPv4; IPv6; IP Direct Mode; LPD; SLP; Bonjour; WS-Discovery; BOOTP/DHCP/AutoIP; SNMP v 1/2/3; HTTP/HTTPS; WS Transfer; FQDN; DNS
Memory	Standard: 32 MB ; Maximum: 16 MB Flash ROM; 32 MB SDRAM; 32 KB NVRAM
Media handling	
Number of paper trays	Standard: 1 input tray ; Maximum: 1 input tray
Media types	Plain paper, envelope, postcard, label
Media size	Custom (metric): 105 x 148 to 216 to 355.6mm Supported (metric): A4; A5; A6; envelopes (C5, DL); custom

Model	HP LaserJet M110we Printer
Product number	7MD66E
Media handling	Standard input: 150-sheet input tray Standard output: 100-sheet output bin
Media weight	65 to 120 g/m ²
Input capacity	Tray 1: Sheets: 150; Envelopes: 10 Maximum: Up to 150 sheets
Output capacity	Standard: Up to 100 sheets Envelopes: Up to 10 envelopes Maximum: Up to 100 sheets
Compatible operating systems	Windows 11; Windows 10; macOS 10.14 Mojave; macOS 10.15 Catalina; macOS 11 Big Sur; Linux
Compatible network operating systems	Windows 11; Linux
Minimum system requirements	Windows: Microsoft® Windows® 11, 10: 32-bit or 64-bit, 2 GB available hard disk space, Internet connection. Mac: Apple® macOS Catalina (v10.15) macOS Big Sur (v11.0) macOS Monterey (v12.0); 2 GB HD; Internet required
Software included	No CD in box. Download software from hp.com or 123.hp.com
Security management	Password-protected network embedded Web server; enable/disable Network ports; SNMPv1/2/3 community password change
Printer management	HP Printer Assistant (UDC), HP Device Toolbox
Dimensions and weight	
Printer dimensions (W x D x H)	Minimum 346 x 189 x 158 mm; Maximum: 346 x 360 x 280 mm
Printer weight	~3.79 kg
Operating environment	Temperature: 15 to 32.5°C Humidity: 30 to 70% RH
Storage conditions	Temperature: -20 to 60°C
Acoustics	Acoustic power emissions: 6.0 B(A) Acoustic pressure emissions: 48 dB(A)
Power	Requirements: 220V - 240V nominal @ +/-10% (min 198V, Max 264V), 50 - 60Hz nominal +/- 3Hz (min 47Hz, max 63Hz); Typical Electricity Consumption (TEC): 0.239 kWh/Week (Blue Angel); 0.256 kWh/Week (Energy Star 3.0); Power supply type: Power requirements are based on the country/region where the printer is sold. Do not convert operating voltages. This will damage the printer and void the product warranty.
Energy savings feature technology	HP Auto-On/Auto-Off Technology
Certifications	RCM (Australia), TUV and GS Mark (Germany), BSMI (Taiwan), KC (South Korea), Ukraine, EAC, Eastern European approvals, CE Marking, FCC, UL, Singapore, etc. Electromagnetic emission standard: CISPR32:2012 & CISPR32:2015 /EN55032:2012 & EN55032:2015+AC:2016 - Class B; EN 61000-3-2:2014; EN 61000-3-3:2013; EN 55035:2017; FCC Title 47 CFR, Part 15 Class B/ICES-003, Issue 6 ENERGY STAR® certified Telecom compliance: Wireless: EU RED 2014/53/EU; EN 301 489-1 V2.2.3 / EN 301 489-17: V3.1.1; EN 300 328: V2.1.1 / EN301 893 V2.1.1; FCC Title 47 CFR, Part 15 Subpart C & E / RSS 247 Issue 1, 2015 & RSS 102 Issue 5, 2015; IEC 62311:2007 / EN62311:2008
Sustainable impact specifications	Recyclable through HP Planet Partners; Contains post-consumer recycled plastic; Net zero-deforestation prints with HP+
Country of origin	Made in Vietnam
What's in the box ⁷	7MD66E HP LaserJet M110we Printer; Power cord; HP Black LaserJet Toner Cartridge (yield: 300 pages); Setup Poster; Reference Guide; Warranty Guide; Flyer
Warranty	Two-year limited warranty; Refer to the documentation in the printer box for further information on HP warranty. HP Warranty benefits apply in addition to any statutory rights provided under applicable consumer protection laws related to non-conformity of goods with the contract of sale. Such consumer statutory rights are not limited or affected in any manner by the HP Warranty

Footnotes

¹ Smallest in-class footprint compared only to dimensions of majority of personal monochrome laser printers and MFPs. Minimum dimensions used in this analysis. Buyers Lab August 2020 study commissioned by HP, based on a research survey OEM published specifications publicly available information as of 7/31/2020. Per HP, measured footprint for the HP LaserJet Pro M109–112 series is 658.063 square cm (102.0 square inches), and for the HP LaserJet Pro MFP M139–142 series is 949.84 square cm (147.226 square inches). Market share as reported by IDC Quarterly Hardcopy Peripherals Tracker - Final Historical 2020Q1 Worldwide. For details, please see: keypointintelligence.com/HPsmallestLaser.

² Requires the HP Smart app download. For details on local printing requirements see <http://www.hp.com/go/mobileprinting>. Certain features/software are available in English language only, and differ between desktop and mobile applications. Subscription may be required; subscription may not be available in all countries. See details at <http://www.hpsmart.com>. Internet access required and must be purchased separately. HP account required for full functionality. List of supported operating systems available in app stores. Fax capabilities are for sending a fax only. After 2 years, monthly fee applies to continue advanced features with HP Smart Advance. HP Smart Advance is not available in all countries. For more information, see <http://www.hpsmart.com>.

³ Based on internal HP testing. Average timing estimate based on: 1) downloaded HP Smart app on mobile or desktop device, 2) setting up Shortcut, 3) scanning jobs which have more than 2–3 tasks associated with them (scan to email, save and rename, store to cloud, etc.). Average timing savings comparison based on using printer and desktop scan software to complete similar scanning tasks. Requires the HP Smart app download and supported HP printer. For details on local printing requirements see www.hp.com/go/mobileprinting.

⁴ Measured using ISO/IEC 24734, excludes first set of test documents. For more information see <http://www.hp.com/go/printerclaims>. Exact speed varies depending on the system configuration, host OS, port-monitor, software application, driver, and document complexity.

⁵ Wireless operations are compatible with 2.4 GHz operations only. Learn more at hp.com/go/mobileprinting. Internet access required and must be purchased separately.

⁶ Based on plan usage, Internet connection to eligible HP printer, valid credit/debit card, email address, and delivery service in your geographic area.

⁷ Based on monthly subscription cost for U.S. and Canada for toner HP Instant Ink 1,500 page plan vs. transactional cost per page of in-class monochrome A4 laser printers and MFPs that use original, standard-capacity integrated cartridges (toner and drum in one cartridge). Buyers Lab April 2020 study commissioned by HP, based on research of publicly available information as of 04/24/2020. Printers selected by market share as reported by IDC Quarterly Hardcopy Peripherals Tracker - Final Historical 2019Q4 for U.S. and Canada. For details and latest report, see: http://www.keypointintelligence.com/HP_TonerService.

⁸ Change or cancel your plan at any time online. If you decide to cancel your HP Instant Ink plan you can go back to using HP original Standard or XL cartridges. Plan upgrades are effective immediately and the charges will be applied retrospectively or in the next billing cycle, depending on user choice. Plan downgrades and cancellations are effective after the last day of the current billing period. For full details go to instantink.hpconnected.com/terms.

⁹ Program availability varies. Original HP cartridge return and recycling is currently available in more than 60 countries, territories and regions in Asia, Africa, Europe, and North and South America through the HP Planet Partners program. Program availability varies. For details, see <http://www.hp.com/recycle>.

¹⁰ Utilizing technology in the HP+ system and compared to HP standard consumer printers without HP+. HP+ printers are ready when you are with improved connectivity utilizing Smart Driver and Print/Scan Doctor technology, more secure with Smart Security technology, more productive through HP Smart Advance features included for 2 years, and more sustainable by enabling Forest First printing.

¹¹ Instant Ink sign up required. Instant Ink not available in all countries. Subject to monthly page limit of plan selected. Must complete Instant Ink sign up within 7 days of setting up the printer with the HP-recommended setup process as indicated in the instructions that came with your printer. Unless service is cancelled within the promotional period online at www.hpinstantink.com, a monthly service fee, based on the plan chosen, plus tax and overage fees will be charged to your credit/debit card. Customer will be charged for any overage fees and applicable taxes at the end of each month in the promotional period. Use of in-box ink or toner cartridge is included in period of offer. One offer redeemable per printer. Included months offer with Instant Ink subject to change after 4.30.2022. Offer cannot be redeemed for cash. Setup Offer may be combined with other offers; see terms and conditions of the other offer for more details. Requires a valid credit/debit card, an email address, and Internet connection to printer. See additional offer information available during online sign up process. For service details, see www.hpinstantink.com.

¹² HP works collaboratively with our partners including WWF and Arbor Day Foundation to manage, restore, and protect forests in many countries around the world. With HP+, every print – regardless of paper brand – is addressed through HP's Forest Positive Framework to counteract risks of deforestation. HP brand paper is sourced only from certified responsibly managed forests or from recycled content. For other brands of paper, HP invests in forest restoration, protection or management projects in key regions sufficient to balance any paper used by HP+ customers that may not have been responsibly sourced. To learn more visit <http://www.hp.com/forestfirst>.

Technical specifications disclaimers

¹ Measured using ISO/IEC 24734, excludes first set of test documents. For more information see <http://www.hp.com/go/printerclaims>. Exact speed varies depending on the system configuration, software application, driver, and document complexity.

² Measured using ISO/IEC 17629. For more information see <http://www.hp.com/go/printerclaims>. Exact speed varies depending on the system configuration, software application, driver, and document complexity.

³ HP Auto-On/Auto-Off Technology capabilities subject to printer and settings; may require a firmware upgrade.

⁴ Requires the HP Smart app download. For details on local printing requirements see <http://www.hp.com/go/mobileprinting>. Certain features/software are available in English language only, and differ between desktop and mobile applications. Instant Ink subscription may be required. Instant Ink not available in all countries. See details at <http://www.hptonerservice.com>. Internet access required and must be purchased separately. HP account required for full functionality. List of supported operating systems available in app stores. Fax capabilities are for sending a fax only, and may require additional purchase. For more information, see: <http://www.hpsmart.com/mobile-fax>

⁵ Wi-Fi® is a registered trademark of Wi-Fi Alliance®. Wireless operations are compatible with 2.4 GHz operations only. Learn more at <http://www.hp.com/go/mobileprinting>. Wireless performance is dependent upon physical environment and distance from the access point. AirPrint and the AirPrint Logo are trademarks of Apple® Inc. The Mopria® Logo is a registered and/or unregistered trademark of Mopria Alliance, Inc. in the United States and other countries. Unauthorized use is strictly prohibited. Requires the HP Smart app download. For details on local printing requirements see <http://www.hp.com/go/mobileprinting>. Certain features/software are available in English language only, and differ between desktop and mobile applications. Instant Ink subscription may be required. Instant Ink not available in all countries. See details at <http://www.hptonerservice.com>. Internet access required and must be purchased separately. HP account required for full functionality. List of supported operating systems available in app stores. Fax capabilities are for sending a fax only, and may require additional purchase. For more information, see: <http://www.hpsmart.com/mobile-fax>

⁶ Power requirements are based on the country/region where the printer is sold. Do not convert operating voltages. This will damage the printer and void the product warranty. Energy Star value typically based on measurement of 115V device.

⁷ For yield information on the cartridge included with your printer, see <http://www.hp.com/go/toneryield>. Yield values measured in accordance with ISO/IEC 19752 and continuous printing. Actual yields vary considerably based on images printed and other factors.

