

Wireless USB Adapter

 For Mac OS X

1 Connect to a Computer

Option 1: Directly

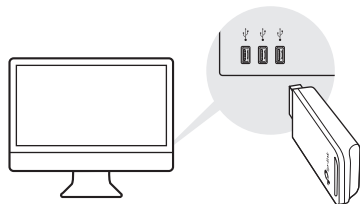

Option 2: Via the USB Extension Cable
(If provided)

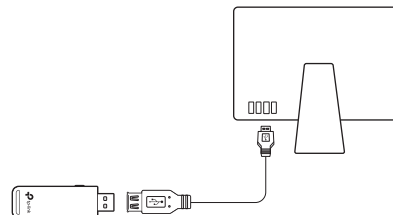

2 Install Driver and Utility

a. Download the driver and utility at <https://www.tp-link.com/download-center>

Note:
If your computer has a CD drive, you can also run the included CD to install the driver and utility.

b. Unzip the downloaded folder and run the **Install.pkg**.

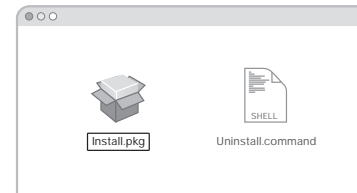

c. Follow the instructions to complete the installation.

3 Join a Wireless Network

Option 1: Via TP-Link Utility

a. Click  (TP-Link Utility) on the menu bar.

b. Select your Wi-Fi network and enter the Wi-Fi password when prompted.

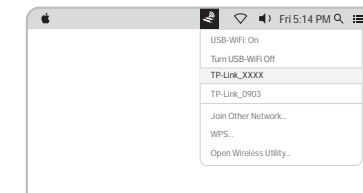

Option 2: Via Wi-Fi Protected Setup (WPS)
(If your adapter has a WPS button)

a. Press the WPS button on your router.

b. Within 2 minutes, press and hold the WPS button on the adapter until the WPS progress window appears.

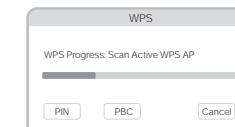
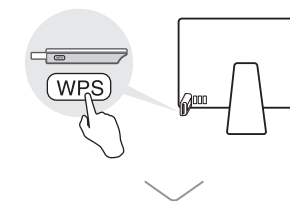



1 Connect to a Computer

Option 1: Directly

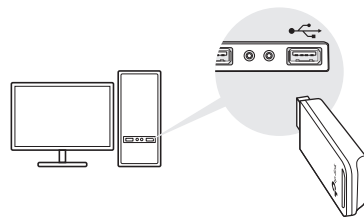

Option 2: Via the USB Extension Cable (if provided)

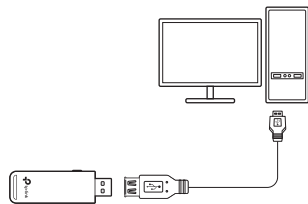

2 Install Driver

a. Insert the CD and run the Autorun.exe.

Note:
You can also download the driver or check the new release at <https://www.tp-link.com/download-center>

b. Select **your adapter** and follow the instructions to complete the installation.

Notes:
• If you can't install the driver successfully, disable the antivirus software and firewall, then try again.
• In Windows 7, if a Windows Security message pops up, refer to **Troubleshooting > T4**.

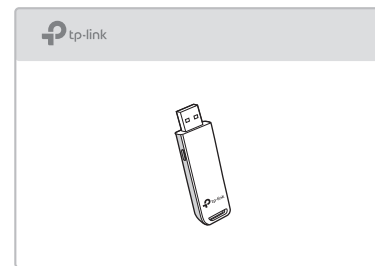

3 Join a Wireless Network

Option 1: Via Windows Wireless Utility

a. Click the network icon (or) on the taskbar.

b. Select your Wi-Fi network, click **Connect** and enter the password when prompted.

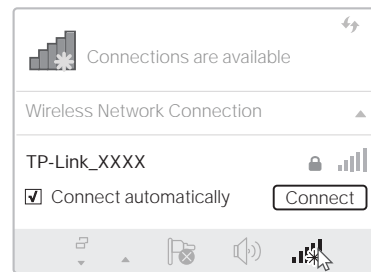

Option 2: Via WPS Tool (If your adapter has a WPS button)

a. Press the WPS button on your router.

b. Within 2 minutes, press and hold the WPS button on the adapter until WPS Tool opens.

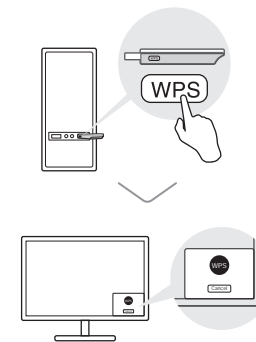

Troubleshooting



If you have problems during the installation, please refer to the following online FAQs.

T1. Can't find the hardware version of the adapter: <https://www.tp-link.com/faq-46.html>

T2. Can't find or connect to the wireless networks: <https://www.tp-link.com/faq-2253.html>

T3. Can't install the driver: <https://www.tp-link.com/faq-2252.html>

T4. How to fix Windows 7 Security issue: <https://www.tp-link.com/faq-2760.html>

Support

For technical support, replacement services, user guides, and other information, please visit <https://www.tp-link.com/support>, or simply scan the QR code.



• Do not attempt to disassemble, repair, or modify the device.
• Do not use the device where wireless devices are not allowed.
• Keep the device away from water, fire, humidity or hot environments.
• This USB Adapter can only be powered by computers that comply with Limited Power Source (LPS).