



Split Pad Pro Attachment Set

Instruction Manual

How to Connect

Handheld Mode

1

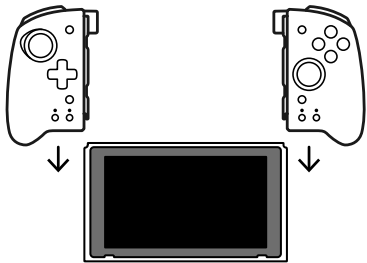

2

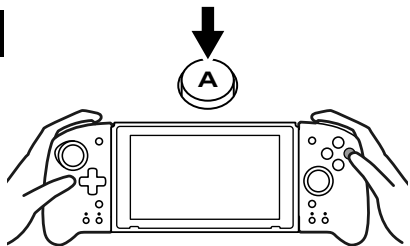

TV Mode

1

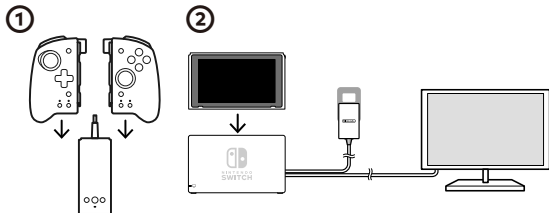

3

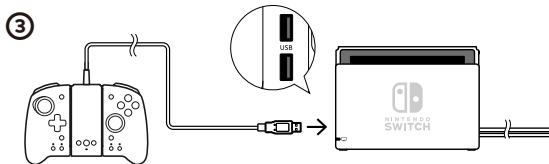

2

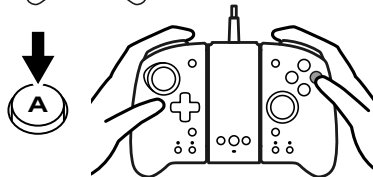

EN

FR

DE

IT

ES

NL

Caution

 Do not touch the Left Analog Stick / Right Analog Stick or any other button when connecting the USB plug or attaching the Split Pad Pro.

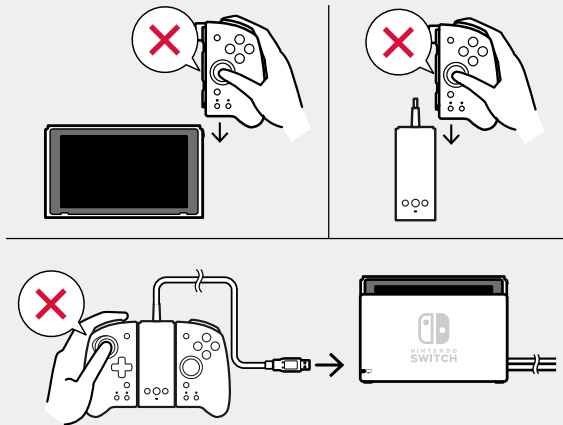

 This product may not function properly if connected via a USB hub.

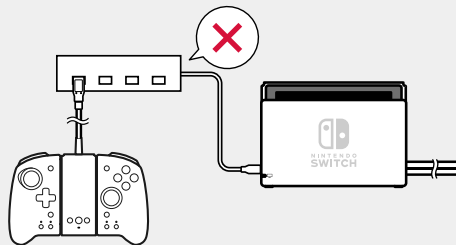

EN

FR

DE

IT

ES

NL

Troubleshooting

The controller is not functioning properly

- Remove controller from the Nintendo Switch™ console and reattach it.
- Make sure that your Nintendo Switch™ is updated to the latest system firmware.

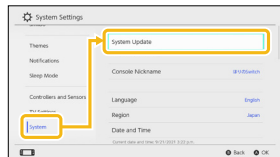
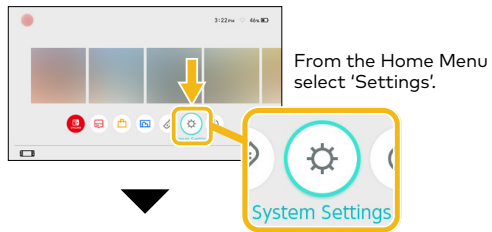

The analog sticks are not responding correctly

Disconnect and connect the controller from the Nintendo Switch or Nintendo Switch Dock and turn ON the Nintendo Switch. Once Nintendo Switch is ON, rotate the analog stick 2-3 times.

The process above will only work when this product is attached to the Nintendo Switch™ console and the power supply is on.

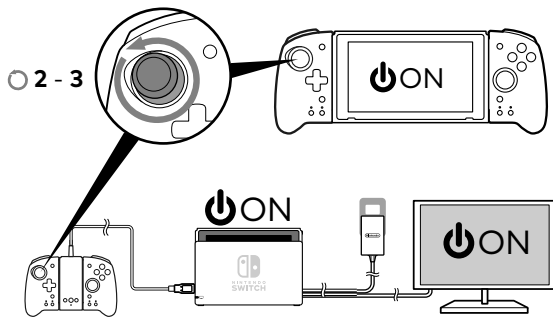

* This product is not compatible with the "Calibrate Control Sticks" option in the Nintendo Switch™ HOME Menu.

EN

FR

DE

IT

ES

NL

How to Remove

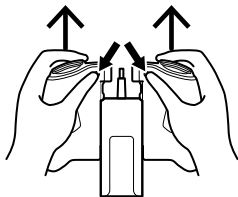
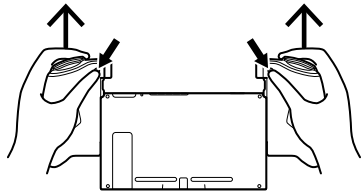
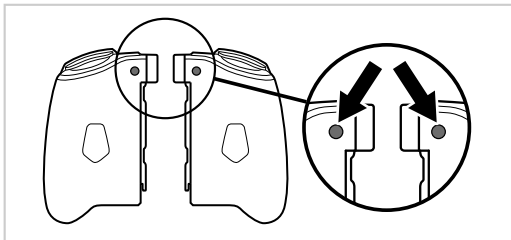

Before using this product

- This product cannot be used in Tabletop Mode, or as a wireless controller.
- This product does not support the following features. Gyroscope, Motion IR Camera, Accelerometer, Player LED, HD Rumble, HOME Button Notification LED, NFC
- This product cannot be used with certain accessories made specifically for Joy-Con™ controllers (such as the Joy-Con Grip and Joy-Con Charging Grip) due to this product's shape and size. Please do not forcibly install this product into any accessories as malfunction or damage may occur.

To play in Tabletop Mode, please use one of our following products.

Compatible HORI Products

USB Multiport Playstand for Nintendo Switch

<https://stores.horiusa.com/multiport-usb-playstand-for-nintendo-switch/>

Dual USB Playstand for Nintendo Switch

<https://stores.horiusa.com/dual-usb-playstand-for-nintendo-switch-lite/>

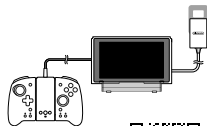

For more information please visit this website

<https://stores.horiusa.com/split-pad-pro-attachment-set-for-nintendo-switch/>



EN

FR

DE

IT

ES

NL

Detailed information

Platform

Nintendo Switch™ / PC (XInput)

When using this product on a PC, the headphone jack cannot be used.

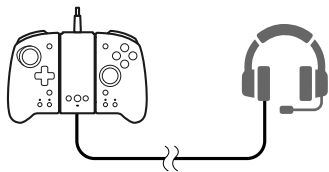

○	Nintendo Switch
✗	PC

Included

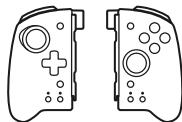

Controller (L/R)
x1



Split Pad Pro
attachment
x1



Instruction manual
x1

EN

FR

DE

IT

ES

NL

Layout

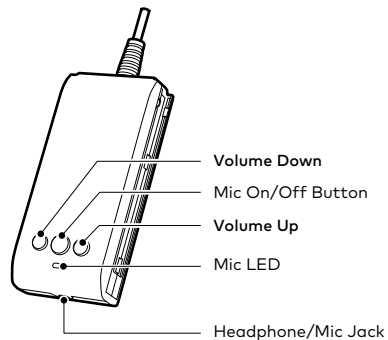
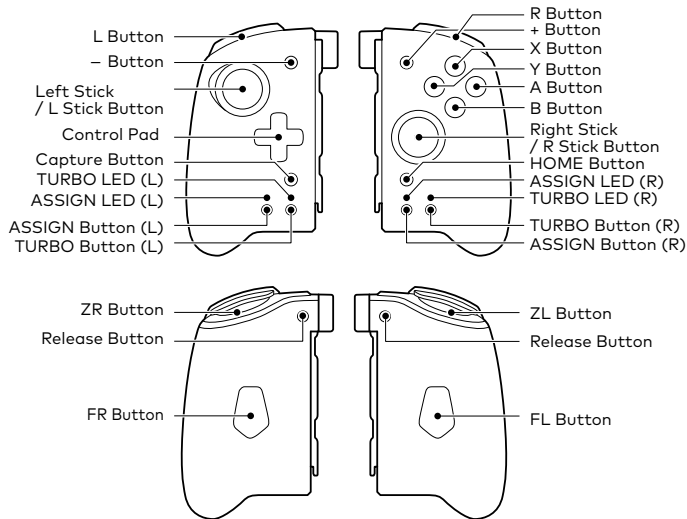

EN

FR

DE

IT

ES

NL

⚙️ Assign Mode

Assign mode allows you to assign button functions to the FL and FR buttons.

Assignable buttons

L

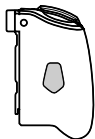

FL Button

L Button
ZL Button
L Stick Button
Control Pad
(UP, DOWN,
LEFT or RIGHT)

R

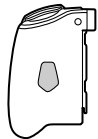

FR Button

R Button
ZR Button
R Stick Button
A Button
B Button
X Button
Y Button

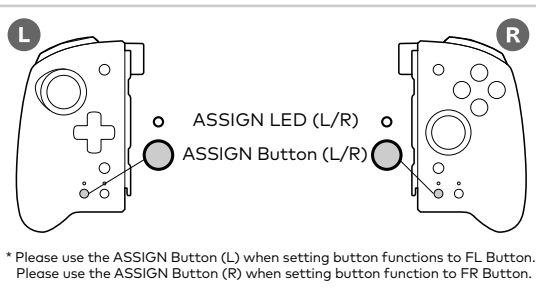

How to assign

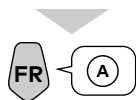
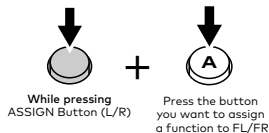

ASSIGN LED
turn Red

Assign OFF



ASSIGN LED
turn off

EN

FR

DE

IT

ES

NL

Turbo Functions

Turbo Mode:

Button is set to continuously activate the button function as long as you press the button.

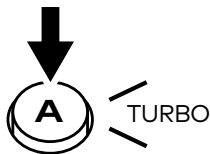

Turbo Hold:

Continuously activates the button function without pressing the button.

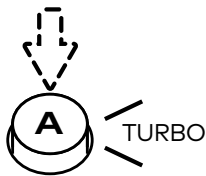

TURBO LED



Setting up
Turbo function
**TURBO LED
turn Green**



Turbo function
activated
**TURBO LED
flashing (Green)***

* The Turbo LED (green) will flash at a rate corresponding to the Turbo speed.

The following buttons can be set to Turbo or Turbo Hold mode:

L

Front View

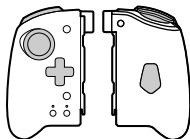

Back View

L Button / ZL Button / L Stick Button
Control Pad (UP, DOWN, LEFT or RIGHT)^{*1}
FL Button^{*2}

^{*1} Control Pad (UP, DOWN, LEFT or RIGHT) is not compatible with the Turbo hold mode, and can only be used to set Turbo mode.

^{*2} The FL Button will function only when a button function is assigned to it.

R

Front View

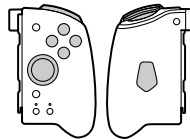

Back View

R Button / ZR Button / R Stick Button
A Button / B Button / X Button / Y Button
FR Button^{*3}

^{*3} The FR Button will function only when a button function is assigned to it.

EN

FR

DE

IT

ES

NL

How to set up Turbo Function

① Turbo Mode ON

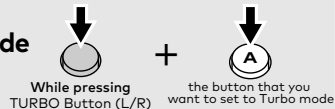

② Turbo Hold ON

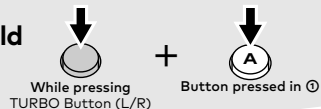

③ Turbo OFF

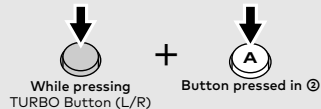

Turbo OFF (All buttons)

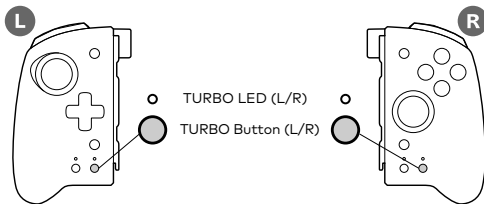
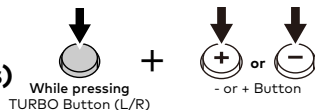

* Please use the TURBO Button (L) when setting button functions to (L).
Please use the TURBO Button (R) when setting button function to (R).

* Please use the TURBO Button (L) and the - Button when adjusting the Turbo Speed on (L).
Please use the TURBO Button (R) and the + Button when adjusting the Turbo Speed on (R).

EN

FR

DE

IT

ES

NL

How to change Turbo Speed

You can adjust the Turbo mode to 3 different speeds.

5 → 10 → 20
times/second ← times/second ← times/second

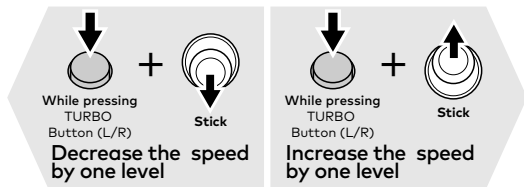

- * Please use the TURBO Button (L) and the Left Stick when adjusting the Turbo Speed on (L). Please use the TURBO Button (R) and the Right Stick when adjusting the Turbo Speed on (R).
- * When setting Turbo speed, Turbo LED (green) will flash at a rate corresponding to the set Turbo speed.
- * Turbo speed is set to 10 times/second by default.
- * Analog Sticks must be returned to the neutral position before changing to the next turbo speed.



Headphone/Mic Jack

(Cannot be used on PC.)



Please turn down the volume on the Nintendo Switch before connecting a headset, as the sudden high volume may cause discomfort to your ears.



Do not use high volume settings for an extended period of time to avoid hearing loss.

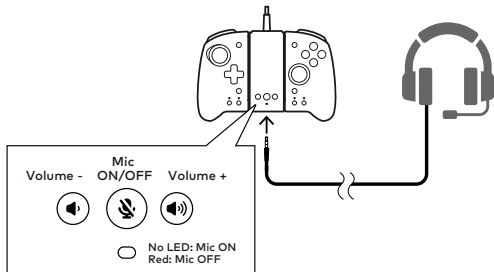

- * When connecting a headset directly to this product, voice chat can be used if the software supports in-game voice chat function.
- * If the software does not support voice chat function, our "Hori Gaming Headset for Nintendo Switch" series can be used together with the Nintendo Switch smartphone app "Nintendo Switch Online" to use voice chat.
- * Please check the instruction manual or contact the software publisher to see if voice chat is supported in the game.

EN

FR

DE

IT

ES

NL

Main Features

Controller (L/R)

External Dimensions : (W)65 mm x (H)110 mm x (D)28 mm

Weight : 80 g

Connection method : Rail connector (* This product is not wireless)

Split Pad Pro Attachment

External Dimensions : (W)42 mm x (H)97 mm x (D)29 mm

Weight : 150 g

Cable Length : 3.0 m

Connection method : USB (Type-A)



Caution To Parent/Guardian, Please read carefully

- This product contains small parts. Keep away from children under 3 years old.
- Keep this product away from small children or infants. Seek medical attention immediately if any small parts are swallowed.
- Long cord. Strangulation hazard.
- Keep the product away from dusty or humid areas.
- Do not use this product if it has been damaged or modified.
- Do not get this product wet. This may cause an electric shock or malfunction.
- Do not place this product near heat sources or leave under direct sunlight for an extended period. Overheating may cause malfunction.
- Do not touch the metal parts of the USB plug.
- Do not apply strong impact or weight on the product.
- Do not pull roughly or bend the cable of the product.
- Do not disassemble, modify or attempt to repair this product.
- If product needs cleaning, use only a soft dry cloth. Do not use any chemical agents like benzene or thinner.
- Do not use this product for anything other than its intended purpose. We are not responsible for any accidents or damages in the event of use other than the intended purpose.

The normal function of the product may be disturbed by strong electro-magnetic interference.

If so, simply reset the product to resume normal operation by following the instruction manual (How to connect).

In case the function does not resume, please relocate to an area which does not have electro-magnetic interference to use the product.

The wires are not to be inserted into socket-outlets.

The packaging must be retained since it contains important information.

PRODUCT DISPOSAL INFORMATION

Where you see this symbol on any of our electrical products or packaging, it indicates that the relevant electrical product or battery should not be disposed of as general household waste in Europe. To ensure the correct waste treatment of the product and battery, please dispose of them in accordance with any applicable local laws or requirements



EU and Turkey only

EN

FR

DE

IT

ES

NL

for disposal of electrical equipment or batteries. In so doing, you will help to conserve natural resources and improve standards of environmental protection in treatment and disposal of electrical waste. Applicable to EU countries and Turkey only.

THE FCC WANTS YOU TO KNOW

This device complies with part 15 of the FCC Rules. Operation is subject to the following two conditions: (1) This device may not cause harmful interference, and (2) this device must accept any interference received, including interference that may cause undesired operation.

NOTE: This equipment has been tested and found to comply with the limits for a Class B digital device, pursuant to part 15 of the FCC Rules. These limits are designed to provide reasonable protection against harmful interference in a residential installation. This equipment generates, uses and can radiate radio frequency energy and, if not installed and used in accordance with the instructions, may cause harmful interference to radio communications. However, there is no guarantee that interference will not occur in a particular installation. If this equipment does cause harmful interference to radio or television reception, which can be determined by turning the equipment off and on, the user is encouraged to try to correct the interference by one or more of the following measures:

- Reorient or relocate the receiving antenna.
- Increase the separation between the equipment and receiver.
- Connect the equipment into an outlet on a circuit different from that to which the receiver is connected.
- Consult the dealer or an experienced radio/TV technician for help.

US

Warranty

HORI warrants to the original purchaser that the product purchased new in its original packaging shall be free of any defects in material and workmanship for a period of 90 days from the original date of purchase. If the warranty claim cannot be processed through the original retailer, please address directly to HORI at info@horiusa.com. Please visit <http://stores.horiusa.com/policies/> for warranty details.

EU

Warranty

For all warranty claims made within the first 30 days after purchase, please check with the retailer where the original purchase was made for details. If the warranty claim cannot be processed through the original retailer or for any other inquiries pertaining to our products, please address directly to HORI at info@horuk.com.

Simplified Declaration of Conformity

Hereby, HORI declares that this product is in compliance with Directive 2014/53/EU.

The full text of the EU declaration of conformity is available at the following internet address:
<https://hori.co.uk/consumer-information/>

For UK: Hereby, HORI declares that this product is in compliance with the relevant statutory requirements.

The full text of the declaration of conformity is available at the following internet address:
<https://hori.co.uk/consumer-information/>

- Please retain contact information for future reference.
- The image on the package may differ from the actual product.
- The manufacturer reserves the right to change the product design or specifications without notice.
- Nintendo Switch is a trademark of Nintendo.
- © 2021 Nintendo. Licensed by Nintendo.
- HORI & HORI logo are registered trademarks of HORI.

Ages 6+

For more information please visit this website

<http://stores.horiusa.com/split-pad-pro-attachment-set-for-nintendo-switch/>



EN

FR

DE

IT

ES

NL