

Mini Case supported devices:

- iPad Mini 1
- iPad Mini 2
- iPad Mini 3
- iPad Mini 4
- iPad Mini (2019)

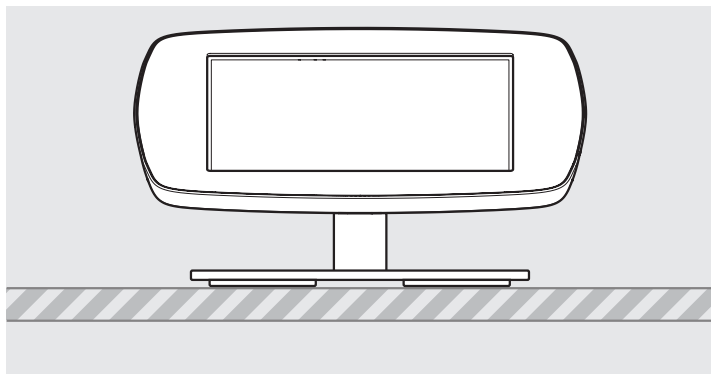

Midi Case supported devices:

- iPad 6th Gen
- iPad 5th Gen
- iPad 4th Gen
- iPad 3rd Gen
- iPad Pro 9.7
- iPad Air 1
- iPad Air 2
- Samsung Tab S2 9.7
- Samsung Tab S3 9.7
- Samsung Tab A 9.7

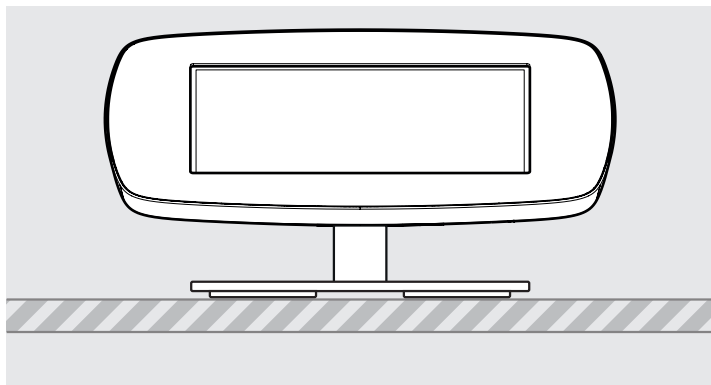

Maxi Case supported devices:

- iPad Pro 10.5
- iPad Pro 11.0
- iPad Air (2019)
- Samsung Tab A6 10.1
- Samsung Tab A 10.1
- Samsung Tab A 10.5
- Samsung Tab 4 10.1
- Microsoft Surface Go

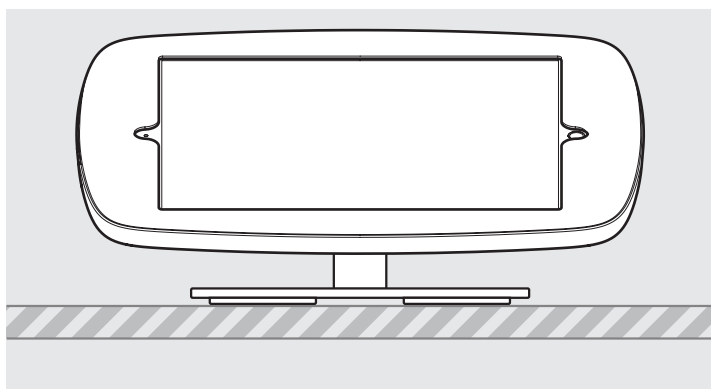

Mega Case supported devices:

- iPad Pro 12.9" 1st Gen
- iPad Pro 12.9" 2nd Gen
- iPad Pro 12.9" 3rd Gen
- Microsoft Surface Pro 4
- Microsoft Surface Pro 5

PRODUCT DATA SHEET - BOUNCEPAD DESK COUNTER

bouncepad®

Case: Mini Arm: Desk Mounting: Freestanding Base Packaged weight: 3.6kg Colour: White / Black

Dimensions

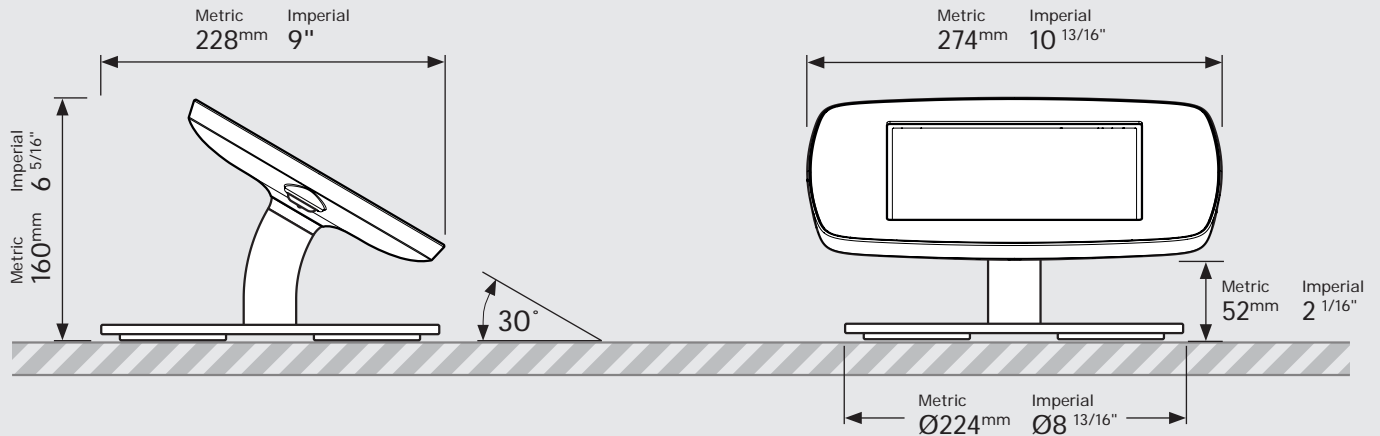

Parts in the Box

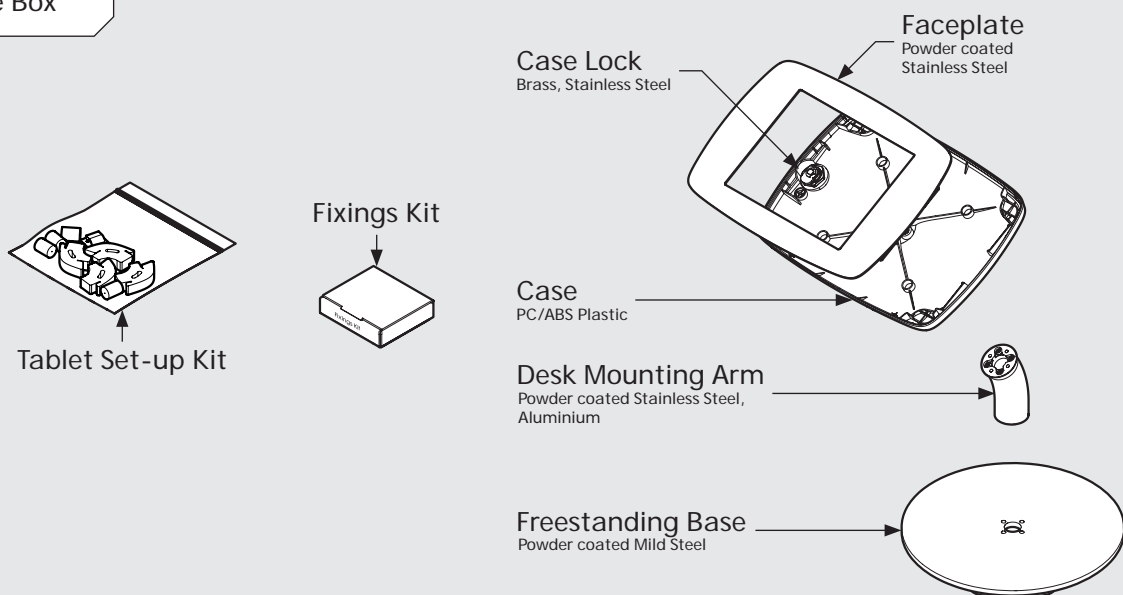

PRODUCT DATA SHEET - BOUNCEPAD DESK COUNTER

bouncepad®

Case: Midi **Arm:** Desk **Mounting:** Freestanding Base **Packaged weight:** 3.8kg **Colour:** White
Black

Dimensions

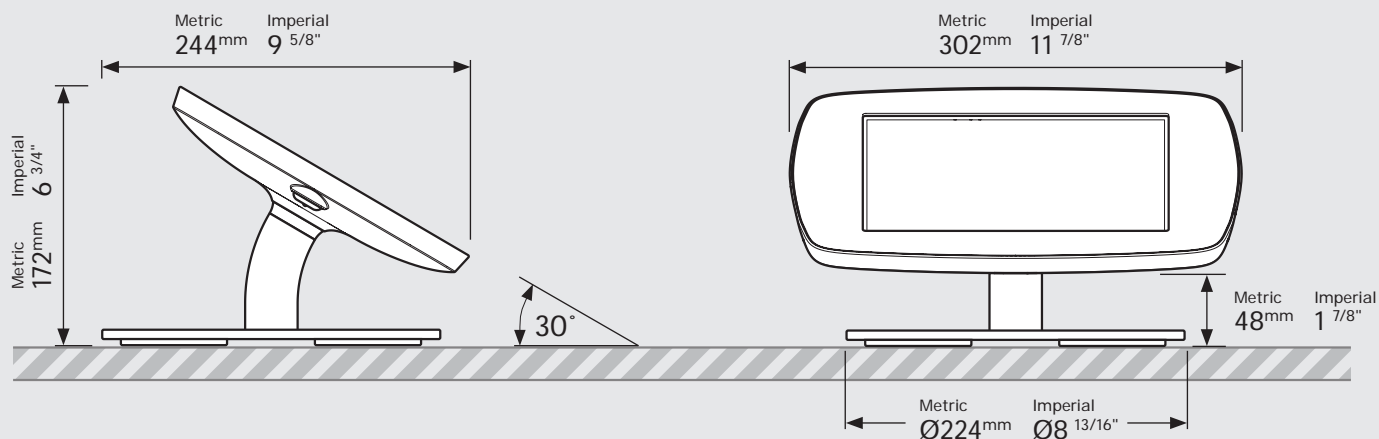

Parts in the Box

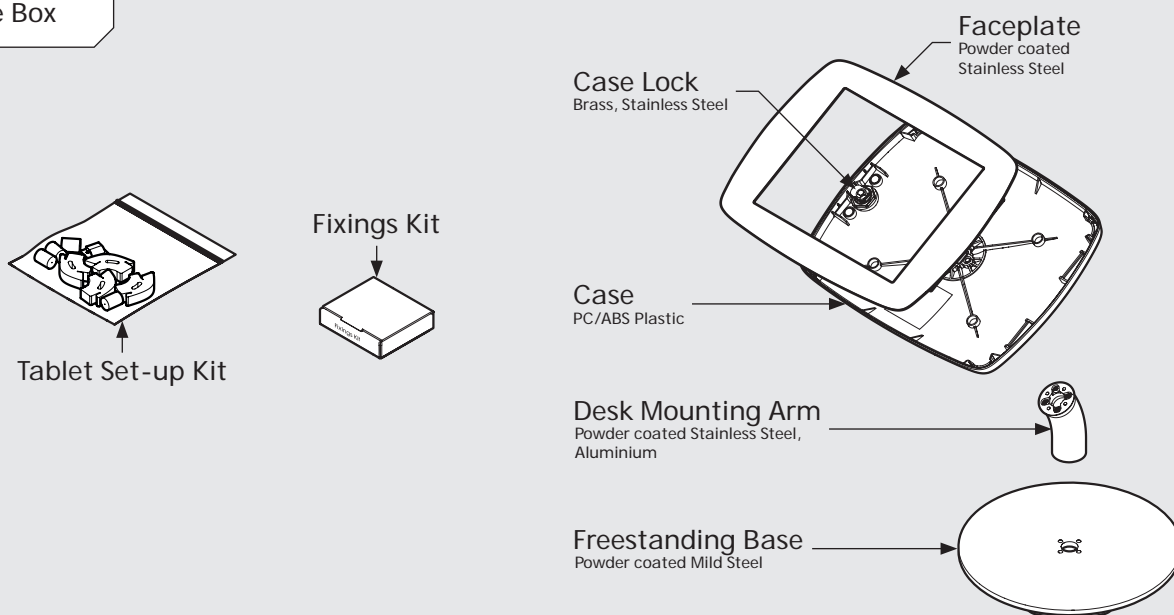

PRODUCT DATA SHEET - BOUNCEPAD DESK COUNTER

bouncepad®

Case: Maxi **Arm:** Desk **Mounting:** Freestanding Base **Packaged weight:** 4.0kg **Colour:** White
Black

Dimensions

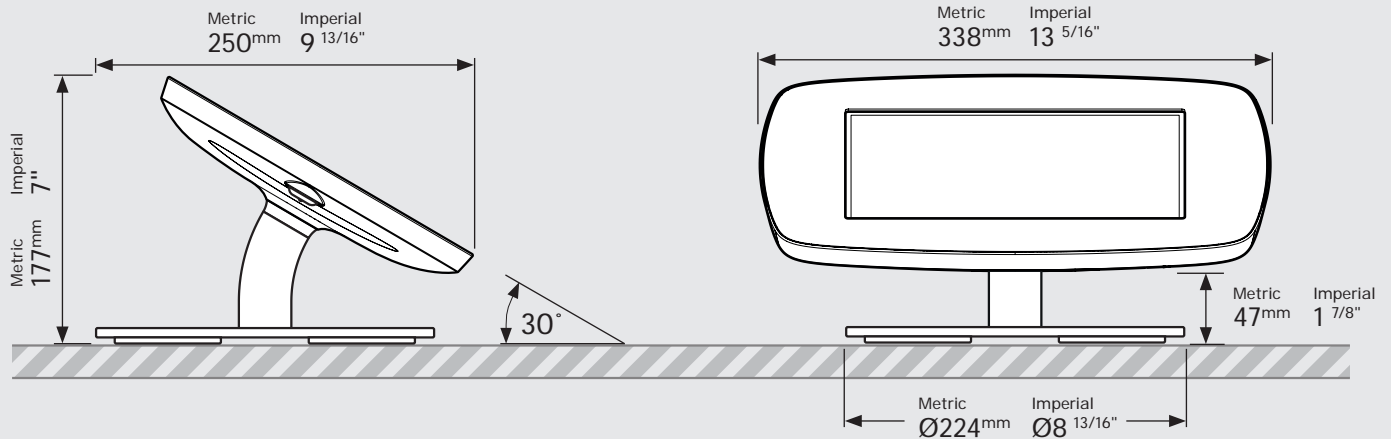

Parts in the Box

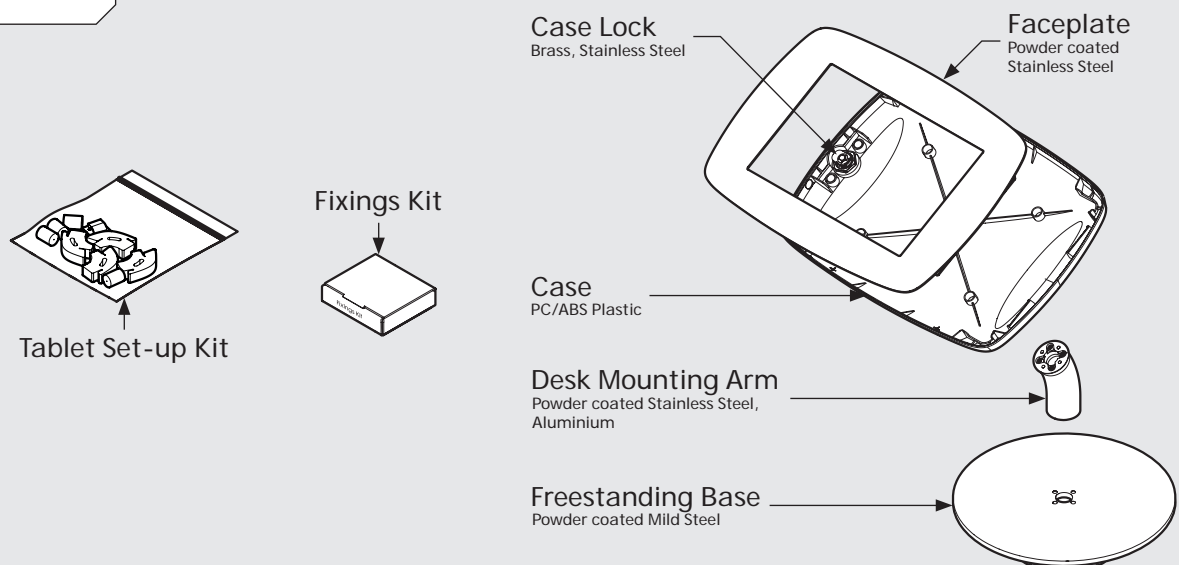

PRODUCT DATA SHEET - BOUNCEPAD DESK COUNTER

bouncepad®

Case: Mega **Arm:** Desk **Mounting:** Freestanding Base **Packaged weight:** 4.3kg **Colour:** White
Black

Dimensions

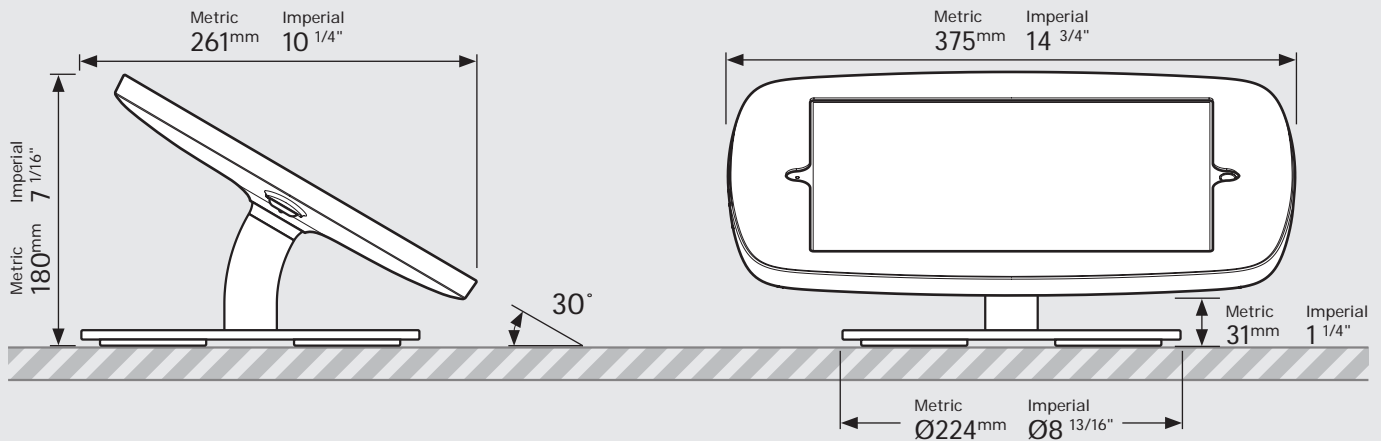

Parts in the Box

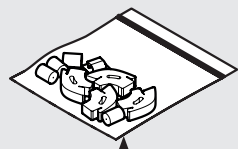

Tablet Set-up Kit

Fixings Kit

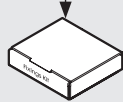

Case Washer
Stainless Steel

Case Lock
Brass, Stainless Steel

Faceplate
Powder coated
Stainless Steel

Case
PC/ABS Plastic

Desk Mounting Arm
Powder coated Stainless Steel,
Aluminium

Freestanding Base
Powder coated Mild Steel