

Blackmagic Web Presenter 4K

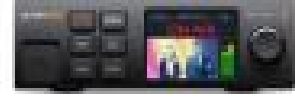

B7-/68-35/) 1. "<1=19>1< 4K5=>41 ?>58->1 HD -90 ' 7<- HD =><1-8593 =: 7?>5: 9 >4->59/7?01= - ; <: 21==5: 9-7 4-<0A-<1 =><1-8593 193591 2: <=><1-8593 ?; >: 2160; 60 05<1/>7C >: +: ?&?. 1, F-/1. : : 6, &A5>1< -90 8: <1! "7?= C: ? /-9 =><1-8 >: >41 59>1<91> ?=593 E>41<91> : < /: 991/> - 5G : < 4G ; 4: 91 >: ?=1 8: . 571 0->-! &41 . ?5> 59 ' %B /: 991/>5: 9= -7=: A: <6 7561 - A1. /-8, =: C: ? /-9 /: 991/> - /: 8; ?>1< -90 ?=1 -9C @501: =: 2>A-<1. +: ? 1@19 31> - 8: 95: <593 : ?> ?> A5>4 @501: , -?05: 81>1<=, ><190 3<-; 4= -90 8: <1!

, 569

Connections

SDI Vide# I" \$('&
1

SDI Ra'e&
1.5G, 3G, 6G, 12G

Webca! O('\$('
1 B ' %B-C ?; >: 2160; 60

SDI Vide# O('\$('&
1 B 7: : ; : ?>, 1 B 8: 95>: <: ?>.

HDMI Vide# O('\$('&
1 B 8: 95>: <: ?>

E'he%" e'
E>41<91> =?; ; : <=> 10/100/1000 B=-1&
2: < 75@1 =><1-8593, =: 2>A-<1 /: 9><: 7
-90 =: 2>A-<1 ?; 0->1=.

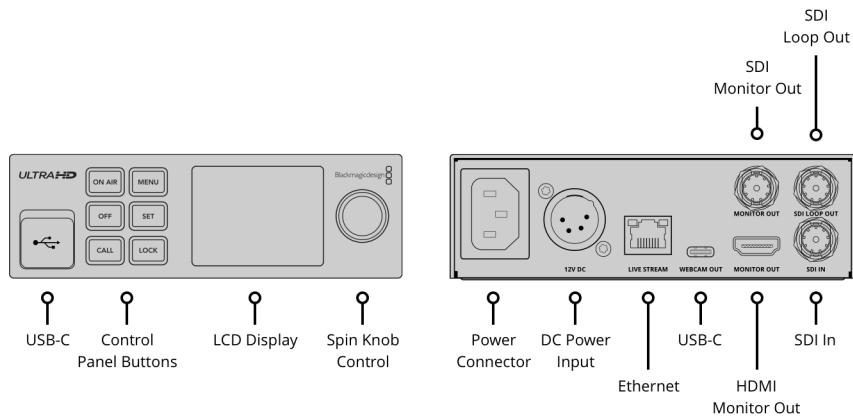

Standards

HD Vide# I" \$(' S'a" da%d&

720; 50, 720; 59.94, 720; 60

1080; 23.98, 1080; 24, 1080; 25,

1080; 29.97, 1080; 30, 1080; 50,

1080; 59.94, 1080; 60

1080"=F23.98, 1080"=F24,

1080"=F25, 1080"=F29.97, 1080"=F30

1080;50, 1080;59.94, 1080;60

U '%a HD Vide# I" \$(' S'a" da%d&

2160; 23.98, 2160; 24, 2160; 25,

2160; 29.97, 2160; 30, 2160; 50,

2160; 59.94, 2160; 60

Vide# I" \$(' C# #S\$ace

\$1/.601, \$1/.709, \$1/.2020

3G SDI

A?>: 01>1/>= % " &E 71@17 A : < B : 9

%DI 59; ?>.

SDI a" d HDMI M#" i" #%O(' Vide#

S'a" da%d&

1080; 50, 1080; 59.94, 1080; 60

Vide# S'ea! i" g S'a" da%d&

720; 25, 720; 30, 720; 50, 720; 60

1080; 23.98, 1080; 24, 1080; 25,

1080; 29.97, 1080; 30, 1080; 50,

1080; 59.94, 1080; 60

2160; 23.98, 2160; 24, 2160; 25,

2160; 29.97, 2160; 30, 2160; 50,

2160; 59.94, 2160; 60

Streaming

Di%ec' S'ea! i" g

B7-/68-35/) 1. "<1=19>1< 4K

=?; ; : <= 05<1/> 7@1 =><1-8;93 : @1<

1>41<91> ?=593 \$1-7 &581 1== -3593

"<: > : /: 7(\$& ") 59 H.264, -90 %1/?<1

\$175-. 71 &<-9=; : <> (%\$&) 59 H.264

-90 H.265.

C #&ed Ca\$'i#" &

) 1. "<1=19>1< 4K =?; ; : <=

18. 100;93 CEA 608 -90 CEA 708

/7: =10 /-; >5: 9= 59 C: ?< 7@1

\$& " =><1-8.

Control

C#" '%# Pa" e

B?5> 59 /: 9><: 7; -917 A5>4 2.2 59/4

/: 7: < 05=; 7-C 2: < @501: ; <1@51A, -?05:

81>1<= -90 =>->?>=.

De)ice C#" '%#

F<: 9> ; -917, ' %B C : < 1>41<91>.

Soft" are

C#! \$a'ib e Se%)ice& a" d S#f' * a%e

F-/1. : : 6, &A5>4, +: ?&?. 1, &A5>>1<,

\$1=><1-8.I! , (581: , B: BC->, C->><,

A2<11/-&(, B575. 575, D: ?+?,) 15. : ,

, : : 8, %6C; 1, 5/<: =: 2> &1-8=,

#?5/6&581 "7-C1<, F-/1&581,

! B% %?05: , ! ; 19 B<: -0/-=>1<, (LC,

) 5<1/-=> "7-C,

) : AD- %<1-8;93 E93591.

Operating Systems



-/ 11.0 B53 %?<,
-/ 12.0 : 9>1<1C : <7->1<.

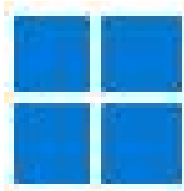

) 590: A= 10, 64-. 5>.
) 590: A= 11.



L59?B



C4<: 81 ! %

Power Requirements

P#* e% S(\$\$ +
1 B I9>1<9-7 100 - 240(AC.

12V DC I" \$('
1 B +12(DC 4 ; 59 *L\$.

P#* e% U&age
25)

Physical Specifications



Environmental Specifications

O\$e%a' i" g Te! \$e%a' (%e
OE C >: 40E C (32E - 104EF)

S' #%age Te! \$e%a' (%e
-20E >: 45E C (-4E >: 113E F)

Re a' i) e H(! idi' +
0% >: 90% 9: 9-/: 9019=593

What's Included

B7-/68-35/) 1. " <1=19>1< 4K

Warrant#

3 C1-<L585>10 -9??-/?<1<f=
) -<<-9>C.

A7 5>18=: 9 >45= A1. =5>1 -<1 /: ; C<534> B7-/68-35/ D1=539 ">C. L>0. 2024, -7/ <534>=<1=1<@10.
A7 ><-018-<6= -<1 ; <; 1<C : 2>415< <1=; 1/>5@1 : A91<=. %"\$ 1B/?01= (A& -90 7: /-1=45; ; 593 /: =>=
&45= A1. =5>1 ?=1= <18-<61>593 =1<@5/1= >; -0@1<5=1 : 9 >45<0; -<C A1. =5>1= >; ; <1@5: ?= @5=5>: <=>: ; ?< =5>1.
+: ? /-9 ; >; ?> -> -9C >581 . C /4-93593 /: ; 651 =1>>593=, "5e-/C": 75/C

Blackmagic Design A thori\$ed Reseller