

# P14 ARGB

## MANUAL

BELIEVE IT

[www.Antec.com](http://www.Antec.com)

All rights reserved. Specifications are subject to change without prior notice. Actual products and accessories may differ from illustrations. Omissions and printing errors excepted. Content of delivery might differ in different countries or areas. Some trademarks may be claimed as the property of others.

V2.2

©1986 – 2024 Antec Inc. All rights reserved.

## 1 CONTENTS

### FAN

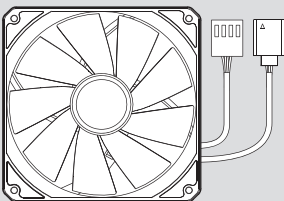

### SCREW



### 4-PIN PWM 1-TO-3 SPLITTER CABLE

(\*Only included in multi-packs)

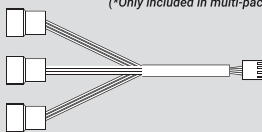

### 3-PIN ARGB 1-TO-3 SPLITTER CABLE

(\*Only included in multi-packs)

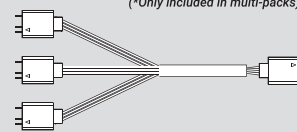

## 2 FAN INTRODUCTION

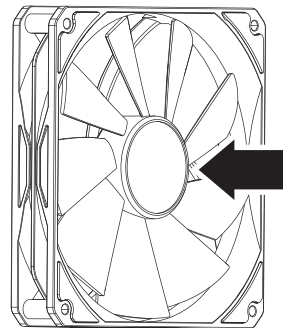

AIR-IN

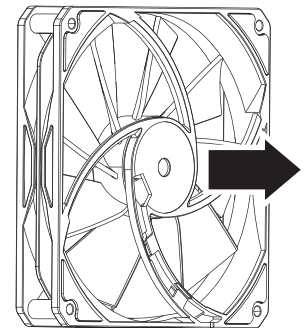

AIR-OUT

### 3 FAN INSTALLATION

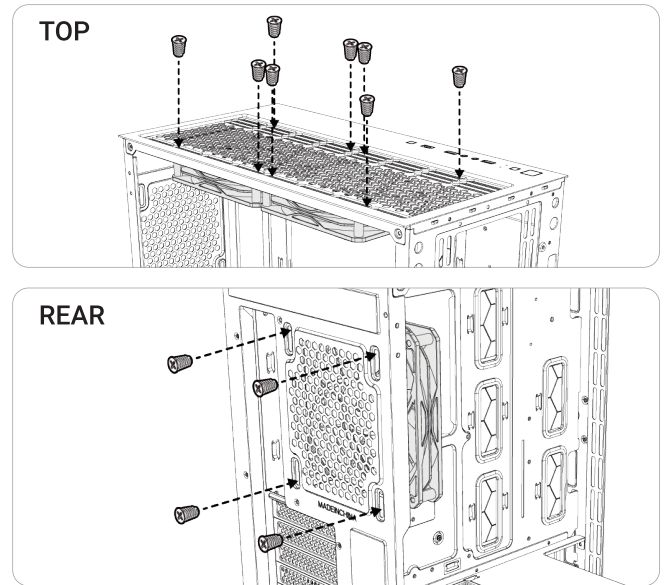
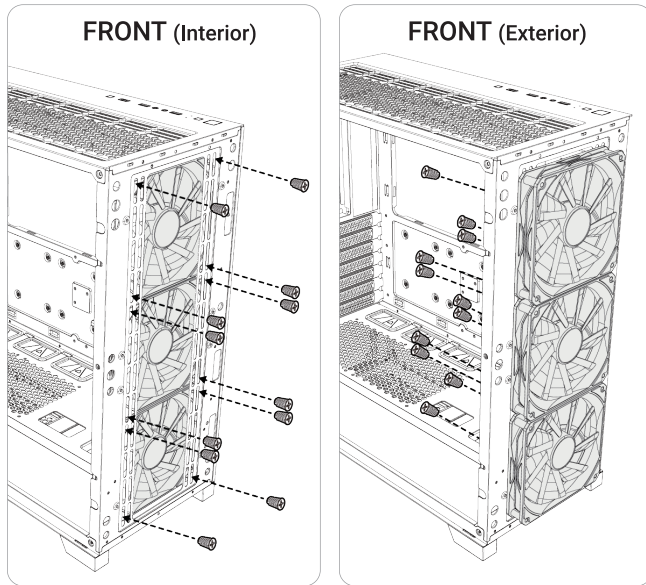

### 4 FAN CONNECTION



#### OPTION A :

- Connect the PWM 4-pin connector to the fan 4-pin header of the motherboard.
- Connect the ARGB 3-pin connector to the 3-pin ARGB header of the motherboard.

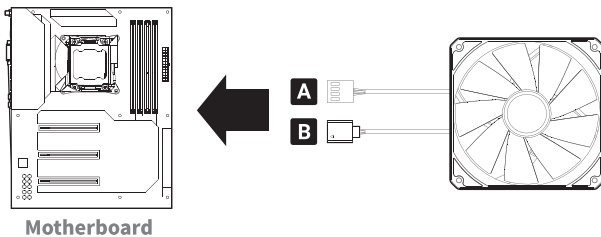

#### OPTION B :

- Connect the PWM 4-pin connector to the 4-pin PWM 1-to-3 splitter cable.
- Connect the ARGB 3-pin connector to the 3-pin ARGB 1-to-3 splitter cable.
- Connect the 4-pin PWM & 3-pin ARGB 1-to-3 splitter cable to the motherboard.

