

# TRANQUIL

## MANUAL

BELIEVE IT

[www.Antec.com](http://www.Antec.com)

All rights reserved. Specifications are subject to change without prior notice. Actual products and accessories may differ from illustrations. Omissions and printing errors excepted. Content of delivery might differ in different countries or areas. Some trademarks may be claimed as the property of others.

V2.2

©1986 – 2024 Antec Inc. All rights reserved.

## 1 CONTENTS

### 120MM FAN

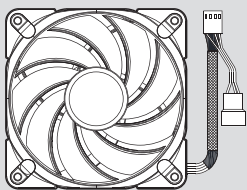

### 140MM FAN

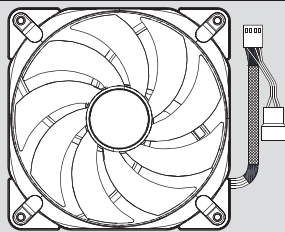

### 4-PIN PWM EXTENSION CABLE



### SCREW



## 2 FAN INTRODUCTION

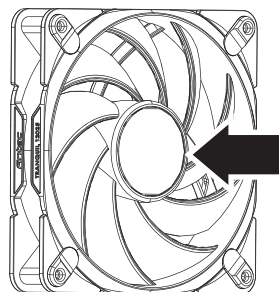

AIR-IN

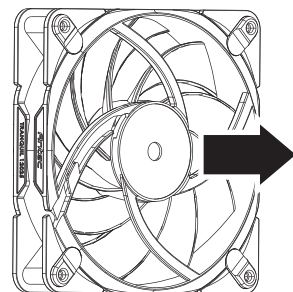

AIR-OUT

### 3 FAN INSTALLATION

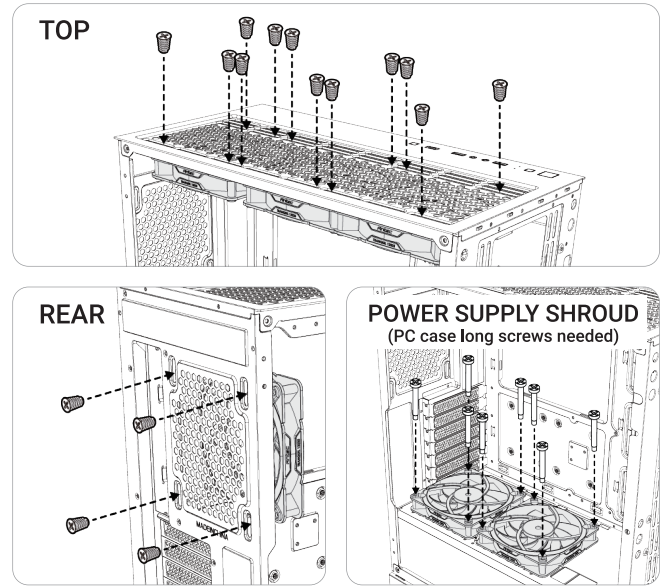
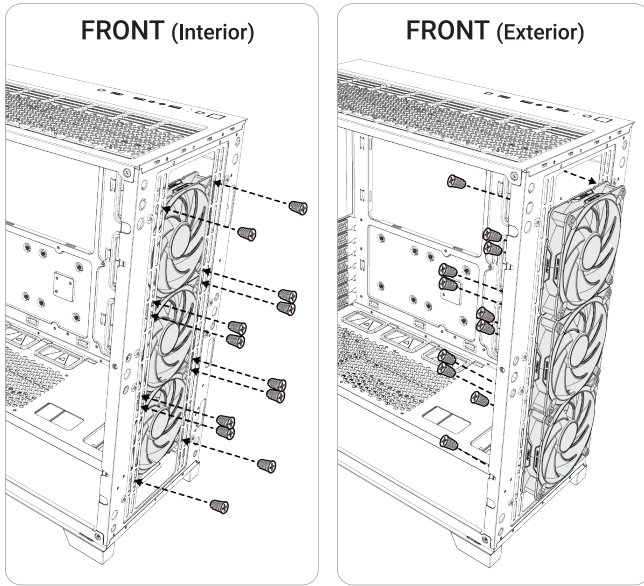

### 4 FAN CONNECTION

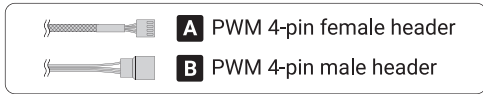

#### OPTION A :

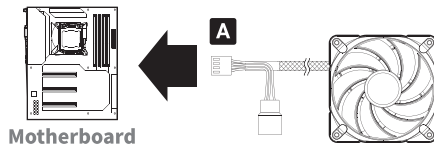

#### OPTION B :

- Connect the 4-pin connector to the PWM extension cable, then connect the extension cable to the 4-pin header on the motherboard.

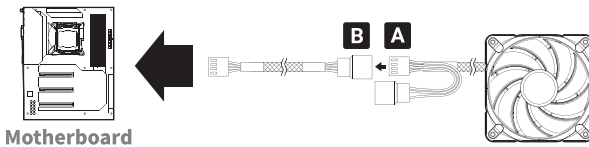

#### OPTION C :

- Daisy chain the fans to make fans work in sync.

