

## GPU POWER CONNECTOR INSTALLATION

1



Align the bundled multi 8-pin-to-12VHPWR cable to the power socket on the GPU

2



Insert the bundled multi 8-pin-to-12VHPWR cable to the power socket on the GPU

3

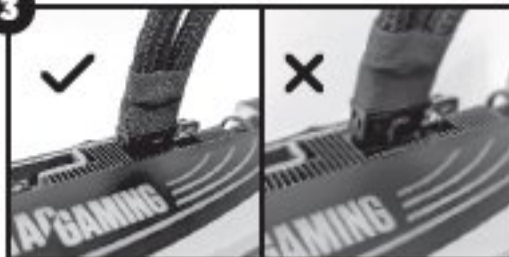

Confirm that the bundled multi 8-pin-to-12VHPWR cable is fully seated into the GPU power socket

4



Connect the 8-pin power connectors from the power supply into the available female connections on the bundled power adapter

5

After the installation and cable management of the bundled multi 8-pin-to-12VHPWR cable to the GPU, double check the power connection is still fully seated to ensure it has not shifted