



## Quick Installation Guide

### Guía de Instalación Rápida

### Guide d'installation rapide

### Guia de Instalação Rápida

## Wireless USB Adapter

Images are for demonstration only.

©2023 TP-Link 7106510743 REV1.2.0

English

### 1 Connect to a Computer

Note: It is recommended to connect the adapter to a USB 3.0 (SS) port.

#### Option 1: Directly

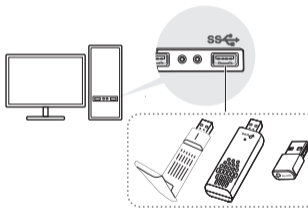

#### Option 2: Via the USB Extension Cable (if provided)

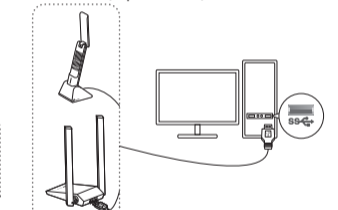

### 2 Install Driver

For Adapter with CD

Insert the CD and run the Autorun.exe. to install driver.

English

For Adapter without CD

- Go to My Computer or This PC.
- Double click the TP-Link disk/ TP-Link CD-ROM then run SetupInstall.exe to install driver.

Note:

- If you cannot find the setup program, please download the driver at [www.tp-link.com/support](http://www.tp-link.com/support).
- If an unknown publisher message pops up, select Yes to continue.
- If Windows User Account Control requires admin credentials, type user name and password of your Windows administrator account.

### 3 Join a Wireless Network

- Click the network icon on the taskbar.
- Select your Wi-Fi network, click **Connect** and enter the password

English

when prompted.

### 4 Troubleshooting

If you have problems during the installation, please refer to the following online FAQs.

- Can't find the hardware version of the adapter:**  
<https://www.tp-link.com/faq-46.html>
- Can't find or connect to the wireless networks:**  
<https://www.tp-link.com/faq-2253.html>
- Can't install the driver:**  
<https://www.tp-link.com/faq-2252.html>

English

### 1 Conectarse a una computadora

Nota: Se recomienda conectar el adaptador a un puerto USB 3.0 (SS).

#### Opción 1: Inserte el adaptador directamente

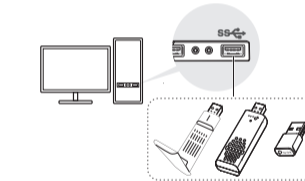

#### Opción 2: A través del cable de extensión USB (si se proporciona)

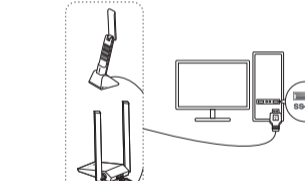

### 2 Instalar controlador

Para adaptador con CD

Inserte el CD y ejecute Autorun.exe. para instalar el controlador.

Español (Latinoamérica)

Para adaptador sin CD

- Vaya a Mi PC o Esta PC.
- Haga doble clic en el disco TP-Link/ CD-ROM TP-Link y luego ejecute SetupInstall.exe para instalar el controlador.
- SetupInstall.exe para instalar el controlador.

Nota:

- Si no puede encontrar el programa de instalación, descargue el controlador en [www.tp-link.com/support](http://www.tp-link.com/support).
- Si aparece un mensaje de editor desconocido, seleccione Sí para continuar.
- Si el Control de cuentas de usuario de Windows requiere credenciales de administrador, escriba el nombre de usuario y la contraseña de su cuenta de administrador de Windows.

Español (Latinoamérica)

### 3 Únase a una red inalámbrica

- Haga clic en el icono de red en la barra de tareas.
- Seleccione su red Wi-Fi, haga clic en **Conectar** e ingrese la contraseña cuando se le solicite.

### 4 Solución de problemas

Si tiene problemas durante la instalación, consulte las siguientes preguntas frecuentes en línea.

- No puedo encontrar la versión de hardware del adaptador:**  
<https://www.tp-link.com/faq-46.html>
- No puedo encontrar o conectarse a las redes inalámbricas:**  
<https://www.tp-link.com/faq-2253.html>
- No se puede instalar el controlador:**  
<https://www.tp-link.com/faq-2252.html>

## 1 Se connecter à un ordinateur

Remarque : il est recommandé de connecter l'adaptateur à un port USB 3.0 (SS).

### Option 1 : directement

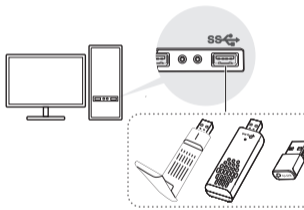

### Option 2 : via le câble d'extension USB (si fourni)

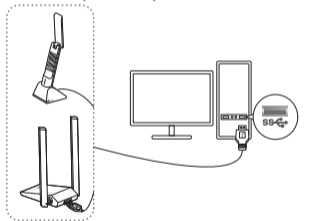

## 2 Installer le pilote

Pour adaptateur avec CD

Insérez le CD et exécutez Autorun.exe. pour installer le pilote.

## Pour adaptateur sans CD

a. Accédez à Poste de travail ou à Ce PC.

b. Double-cliquez sur le disque TP-Link/CD-ROM TP-Link, puis exécutez SetupInstall.exe pour installer le pilote.

Note:

- Si vous ne trouvez pas le programme d'installation, veuillez télécharger le pilote sur [www.tp-link.com/support](http://www.tp-link.com/support).
- Si un message d'éditeur inconnu apparaît, veuillez sélectionner Oui pour continuer.
- Si le contrôle de compte d'utilisateur Windows nécessite des informations d'identification administrateur, veuillez saisir le nom d'utilisateur et le mot de passe de votre compte d'administrateur Windows.

## 3 Rejoignez un réseau WiFi

a. Cliquez sur l'icône de réseau dans la barre des tâches.

b. Sélectionnez votre réseau WiFi, cliquez sur Connecter et entrez le mot de passe lorsque vous y êtes invité.

## 4 Dépannage

Si vous rencontrez des problèmes lors de l'installation, veuillez vous référer aux FAQ en ligne suivantes.

- **Impossible de trouver la version matérielle de l'adaptateur :**  
<https://www.tp-link.com/faq-46.html>
- **Impossible de trouver ou de se connecter aux réseaux WiFi :**  
<https://www.tp-link.com/faq-2253.html>
- **Impossible d'installer le pilote :**  
<https://www.tp-link.com/faq-2252.html>

## 1. Conecte-se a um computador

Nota: Recomenda-se conectar o adaptador a uma porta USB 3.0 (SS).

### Opção 1: Diretamente

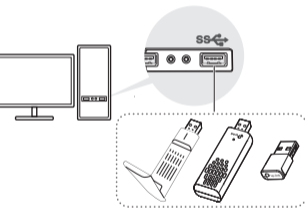

### Opção 2: Via Cabo de Extensão USB (se fornecido)

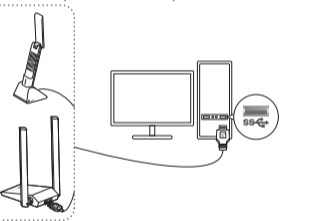

## 2 Instalar Driver

Para Adaptador com CD

Insira o CD e execute o ficheiro Autorun.exe. para instalar o controlador.

## Para o Adaptador sem CD

a. Aceda a O meu computador ou Este PC.

b. Faça duplo clique no disco TP-Link/CD-ROM TP-Link e execute SetupInstall.exe para instalar o controlador.

Observação:

- Se você não conseguir encontrar o programa de instalação, baixe o driver em [www.tp-link.com/support](http://www.tp-link.com/support).
- Se aparecer uma mensagem de editor desconhecido, selecione Sim para continuar.
- Se o Controle de Conta de Usuário do Windows exigir credenciais de administrador, digite o nome de usuário e a senha de sua conta de administrador do Windows.

## 3 Entrar em Uma Rede Wireless

a. Clique no ícone de rede na barra de tarefas.

b. Selecione sua rede Wi-Fi, clique em Conectar e digite a senha quando solicitado.

## 4 Solução de Problemas

Se você tiver problemas durante a instalação, consulte as seguintes perguntas frequentes online.

- **Não consigo encontrar a versão de hardware do adaptador:**  
<https://www.tp-link.com/faq-46.html>
- **Não consigo encontrar ou conectar-se às redes wireless:**  
<https://www.tp-link.com/faq-2253.html>
- **Não consigo instalar o driver:**  
<https://www.tp-link.com/faq-2252.html>

Para informações de aspectos de segurança e adequação do produto no território brasileiro consulte: [www.gov.br/anatel/pt-br/](http://www.gov.br/anatel/pt-br/)

## Support

For technical support, the user guide and other information, please visit <https://www.tp-link.com/support>, or simply scan the QR code.

