

● CLEVER GAMING

GAMING X Trust.



THORNE

USER GUIDE

ILLUMINATED GAMING SOUNDBAR

Bedienungsanleitung | Mode d'emploi | Gebruikershandleiding | Manuale utente | Manual del usuario | Guia do utilizador | Brukerveiledning | Bruksanvisning | Käyttöopas | Brugsvejledning | Instrukcja obsługi | Návod k použití | Návod na používanie | Használati útmutató | Manual de utilizare | Ръководство за потребителя | Εγχειρίδιο χρήσης | Kullanıcı kılavuzu | Руководство пользователя | Uporabniški priročnik | Korisnički priručnik | Guia do usuário | Посібник користувача | مَدَدِ سَمْعِ لَمَّاعِ لِيَلْمِ

FAQ

WWW.TRUST.COM/25110/FAQ

Trust International BV - Laan van Barcelona 600 - 3317DD, Dordrecht, The Netherlands

©2023 Trust All rights reserved.

1.

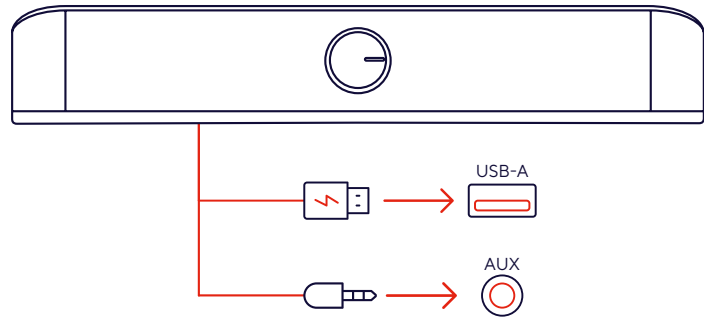

2.

1 CLICK ON/OFF

2 VOLUME CONTROL

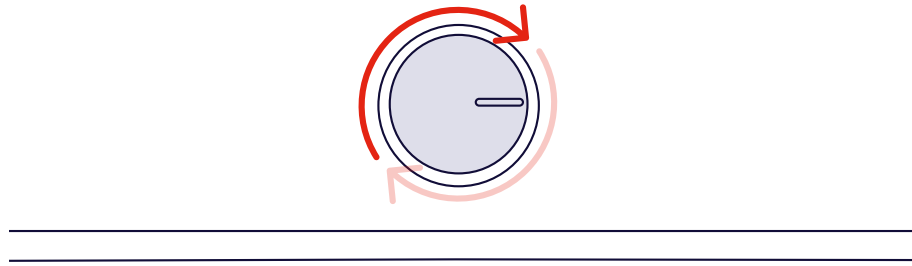

3.

