

## AXIS F9114-B Main Unit

### 4-channel modular barebone unit with audio and I/O

AXIS F9114-B is excellent for building customized video solutions. Sold without a casing, this UL recognized barebone main unit is ideal for integration into a UL certified end-product. Based on a divided camera concept, it can be installed indoors or inside vehicles. It supports four HDTV 1080p video streams at 30 fps on all channels and requires only one video management software (VMS) license. Furthermore, it includes built-in cybersecurity features to help prevent unauthorized access and safeguard your system. For instance, Axis Edge Vault protects your Axis device ID and simplifies authorization of Axis devices on your network.

- > [Compact barebone main unit](#)
- > [UL recognized component](#)
- > [Multiple sensor and cable options](#)
- > [Support for 2-way audio and I/O](#)
- > [1080p at 30 fps on 4-channels](#)

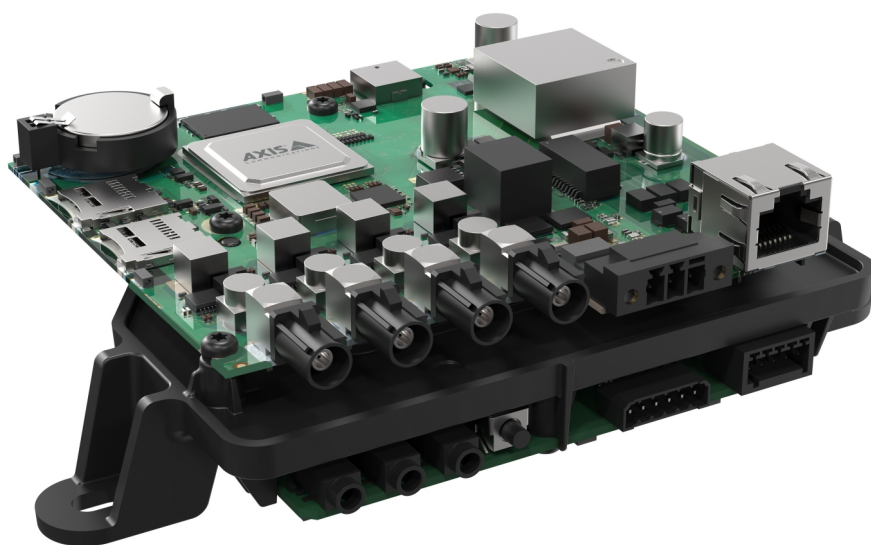

# AXIS F9114-B Main Unit

## System on chip (SoC)

<b>Model</b>	ARTPEC-7
<b>Memory</b>	2x 1024 MB RAM, 512 MB Flash

## Video

<b>Video compression</b>	H.264 (MPEG-4 Part 10/AVC) Baseline, Main and High Profiles H.265 (MPEG-H Part 2/HEVC) Main Profile Motion JPEG
<b>Resolution</b>	1920x1080 HDTV 1080p
<b>Frame rate</b>	Up to 30 fps in 1080p (WDR mode) and up to 60 fps in 720p
<b>Video streaming</b>	Multiple, individually configurable streams in H.264, H.265 and Motion JPEG Axis Zipstream technology in H.264 and H.265 Controllable frame rate and bandwidth VBR/ABR/MBR H.264/H.265 Low latency mode Video streaming indicator
<b>Image settings</b>	Contrast, brightness, sharpness, Forensic WDR, fixed orientation aid, white balance, tone mapping, exposure control, exposure zones, compression, rotation: 0°, 90°, 180°, 270°, mirroring, polygon privacy mask, control queue

## Audio

<b>Audio streaming</b>	Two-way, full duplex
<b>Audio encoding</b>	24bit LPCM, AAC-LC 8/16/32/48 kHz, G.711 PCM 8 kHz, G.726 ADPCM 8 kHz, Opus 8/16/48 kHz Configurable bit rate
<b>Audio input/output</b>	2x external microphone input or line input, 1x line output, ring power, digital audio input

## Network

<b>Network protocols</b>	IPv4, IPv6 USGv6, ICMPv4/ICMPv6, HTTP, HTTPS, HTTP/2, TLS, QoS Layer 3 DiffServ, FTP, SFTP, CIFS/SMB, SMTP, mDNS (Bonjour), UPnP®, SNMP v1/v2c/v3 (MIB-II), DNS/DNSv6, DDNS, NTP, NTS, RTSP, RTP, SRTP/RTSPS, TCP, RTCP, DHCP, SSH, SIP, LLDP, CDP, MQTT v3.1.1, Syslog, Link-Local address (ZeroConf)
--------------------------	--------------------------------------------------------------------------------------------------------------------------------------------------------------------------------------------------------------------------------------------------------------------------------------------------------

## System integration

<b>Application Programming Interface</b>	Open API for software integration, including VAPIX® and AXIS Camera Application Platform; specifications at <a href="http://axis.com">axis.com</a> One-click cloud connection ONVIF® Profile G and ONVIF® Profile S, specification at <a href="http://onvif.org">onvif.org</a>
<b>Event conditions</b>	Device status, digital audio, edge storage, I/O, PTZ, scheduled event, video, MQTT subscribe
<b>Event actions</b>	Play audio clip, toggle I/O, send images, publish MQTT, send notifications, overlay text, power saving mode, recordings, SNMP trap messages, status LED, video clips
<b>Data streaming</b>	Event data

## Analytics

<b>Applications</b>	<b>Included</b> AXIS Video Motion Detection, audio detection <b>Supported</b> AXIS People Counter, tampering alarm Support for AXIS Camera Application Platform enabling installation of third-party applications, see <a href="http://axis.com/acap">axis.com/acap</a>
---------------------	-------------------------------------------------------------------------------------------------------------------------------------------------------------------------------------------------------------------------------------------------------------------------------------

## Cybersecurity

<b>Edge security</b>	Software: Signed firmware, brute force delay protection, digest authentication, password protection, AES-XTS-Plain64 256bit SD card encryption
----------------------	------------------------------------------------------------------------------------------------------------------------------------------------

Hardware: Secure boot, Axis Edge Vault with Axis device ID, signed video, secure keystore (CC EAL4+ certified hardware protection of cryptographic operations and keys)

<b>Network security</b>	IEEE 802.1X (EAP-TLS), IEEE 802.1AR, HTTPS/HSTS, TLS v1.2/v1.3, Network Time Security (NTS), X.509 Certificate PKI, IP address filtering
<b>Documentation</b>	<i>AXIS OS Hardening Guide</i> <i>Axis Vulnerability Management Policy</i> <i>Axis Security Development Model</i> To download documents, go to <a href="http://axis.com/support/cybersecurity/resources">axis.com/support/cybersecurity/resources</a> To read more about Axis cybersecurity support, go to <a href="http://axis.com/cybersecurity">axis.com/cybersecurity</a>
<b>General</b>	
<b>Sustainability</b>	PVC free
<b>Power</b>	Power over Ethernet (PoE) IEEE 802.3at Type 2 Class 4 10–48 V DC, typical 9 W, max 25.5 W
<b>Connectors</b>	RJ45 for 10BASE-T/100BASE-TX/1000BASE-T PoE 4x FAKRA for sensor units 6-pin terminal block for 4x configurable I/Os (12 V DC output), max load 50 mA 3.5 mm mic/line in, 3.5 mm line out 5-pin terminal block RS232/RS485 3-pin terminal block for 10–48 V DC input
<b>Storage</b>	Support for microSD/microSDHC/microSDXC card and encryption Recording to network-attached storage (NAS) For SD card and NAS recommendations see <a href="http://axis.com">axis.com</a>
<b>Operating conditions</b>	-40 °C to 60 °C (-40 °F to 140 °F) Humidity 10–85% RH (non-condensing)
<b>Storage conditions</b>	-40 °C to 65 °C (-40 °F to 149 °F) Humidity 5–95% RH (non-condensing)
<b>Approvals</b>	<b>Safety</b> UL recognized component, IS 13252 <b>Network</b> NIST SP500-267
<b>Dimensions</b>	43 x 123 x 160 mm (1.7 x 4.8 x 6.3 in)
<b>Weight</b>	190 g (0.4 lb)
<b>Required hardware</b>	AXIS TU6004-E Cable, AXIS TU6005 Plenum Cable, AXIS F21 Sensor Unit, AXIS F4105-LRE Dome Sensor, AXIS F7225-RE Pinhole Sensor
<b>Included accessories</b>	Installation guide, Windows® decoder 1-user license
<b>Optional accessories</b>	AXIS Surveillance Cards TU6001 Connector 3-pin, TU6008 Connector 5-pin, TU6009 Connector 6-pin For more accessories, see <a href="http://axis.com">axis.com</a>
<b>Video management software</b>	AXIS Companion, AXIS Camera Station, video management software from Axis Application Development Partners available at <a href="http://axis.com/vms">axis.com/vms</a>
<b>Languages</b>	English, German, French, Spanish, Italian, Russian, Simplified Chinese, Japanese, Korean, Portuguese, Polish, Traditional Chinese
<b>Warranty</b>	5-year warranty, see <a href="http://axis.com/warranty">axis.com/warranty</a>

# AXIS F9114-B Main Unit

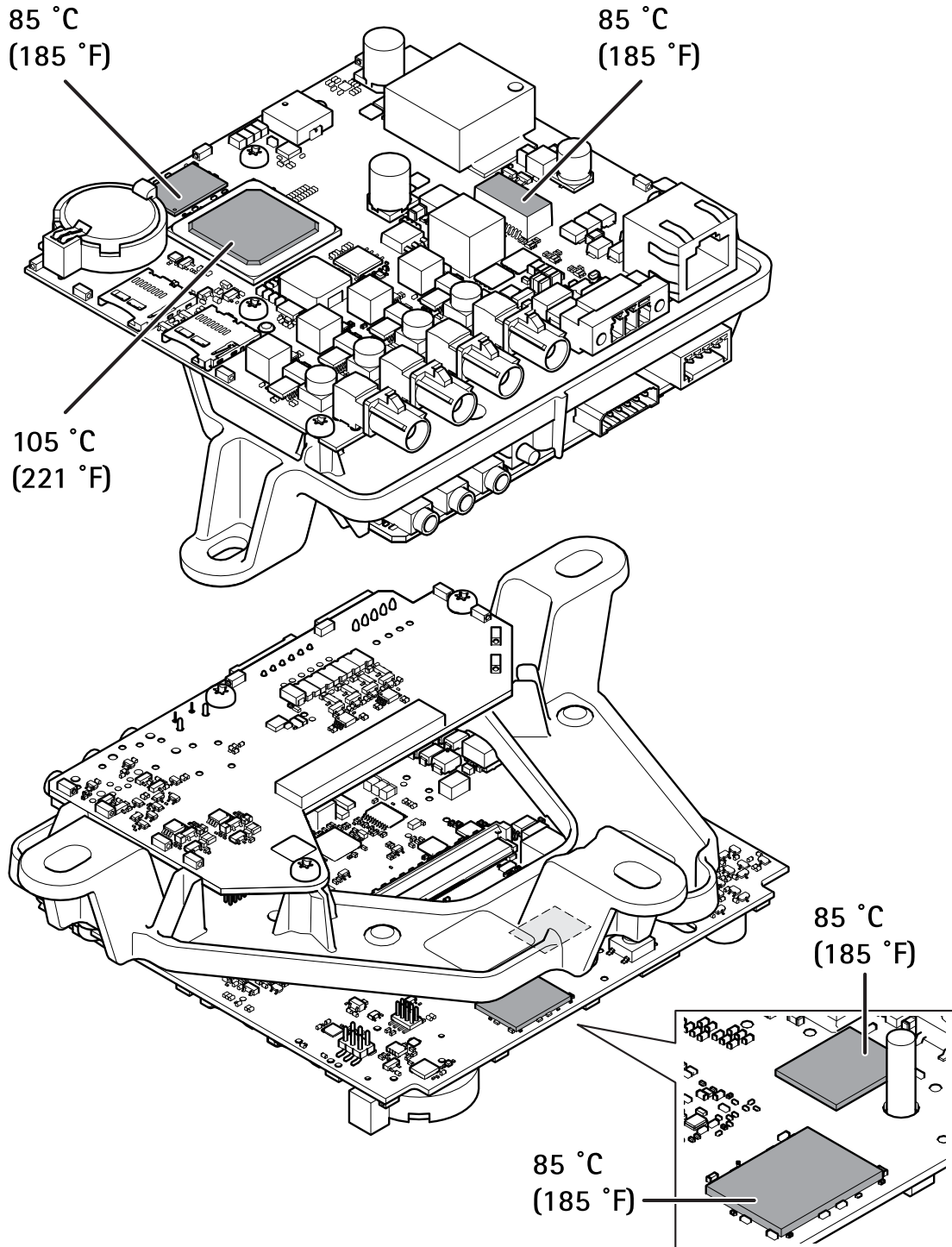

Maximum allowable temperatures. If the ambient temperature is 35 °C (95 °F) or higher, the temperature of the components increases and they must be cooled.