

**FITS FLAT
& ANGLED
CEILINGS**

BT7808

CEILING / WALL MOUNT WITH TILT FOR Ø50MM POLES

Designed to ceiling mount Ø50mm poles, the BT7808 features an adjustable tilt mechanism with a tilt range of up to 90°. This makes it ideal for mounting flat screens and projectors to flat or angled ceilings and also allows wall mounted installations in both portrait or landscape configurations.

SPECIFICATION

Max Load	140kg
Tilt	+90°
Colour	Black or White

FEATURES

- Designed to mount a Ø50mm pole to a flat or angled ceiling
- Allows poles to be mounted on to walls in horizontal or vertical configurations
- Keyhole fixing for hassle free 'hook-on' installation

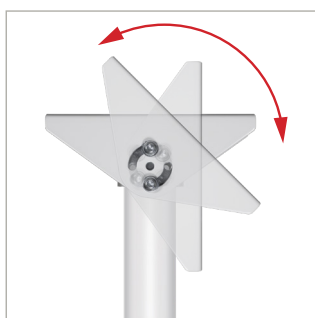
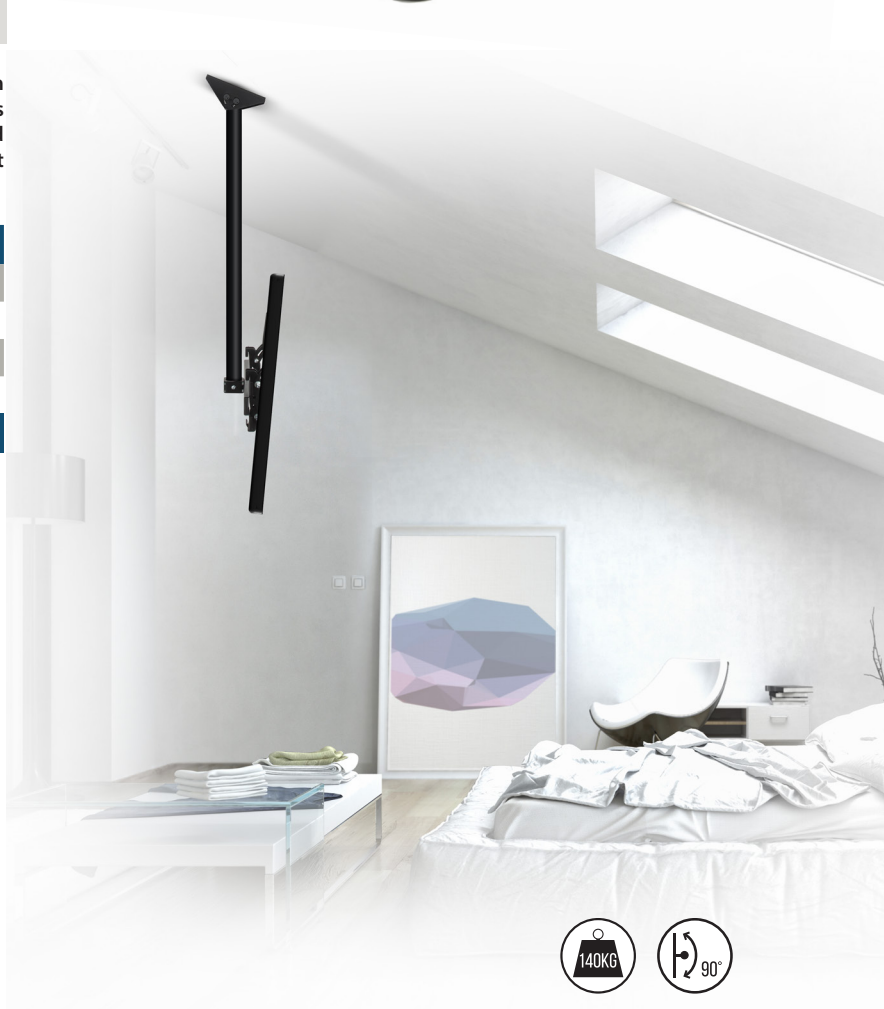

Up to +90° tilt of pole for angled ceilings or walls

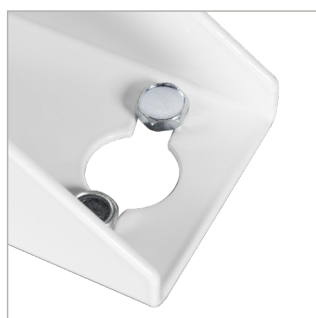

Keyhole fixing for hassle free 'hook-on' installation



Pole mount screens from flat or angled ceilings



Also ideal for mounting projectors to the ceiling

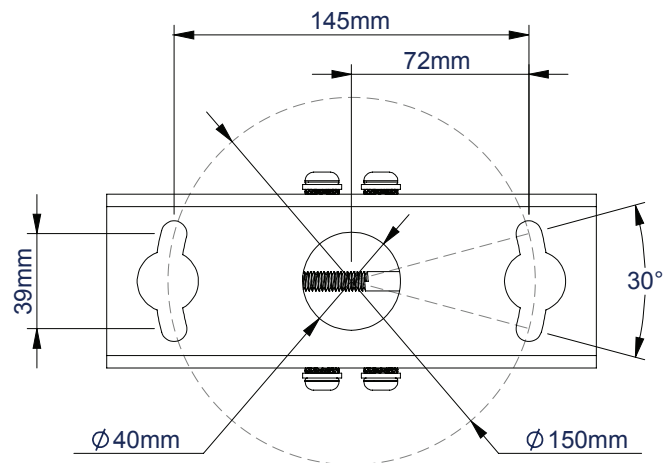

TOP VIEW

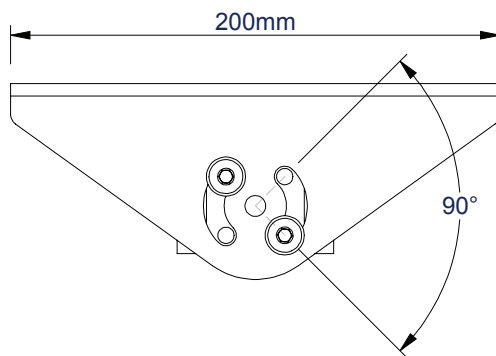

SIDE VIEW

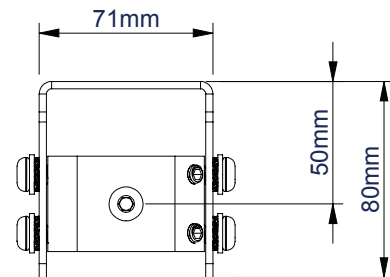

FRONT VIEW

PACKING INFORMATION

COLOUR:	ORDER REF:	EAN CODE:	MASTER CARTON QTY:	INNER CARTON QTY:	MASTER CARTON WEIGHT:	MASTER CARTON CUBE:
Black	BT7808/B	5019318759697	12	0	12.81kg	0.02cbm
White	BT7808/W	5019318306273	12	0	12.81kg	0.02cbm

ACCESSORIES AND RELATED PRODUCTS FOR USE WITH BT7808

BT7850



50mm diameter poles available in different lengths up to 3m

BT7841



50mm Accessory Collar for fixing mounts & accessories to Ø50mm poles

BT8431



Flat Screen Wall Mount with Tilt fits to Ø50mm poles using 2x **BT7841** collars

BT899



Heavy Duty Projector Mount fits directly to Ø50mm poles